

# MPF PRODUCTS INC.

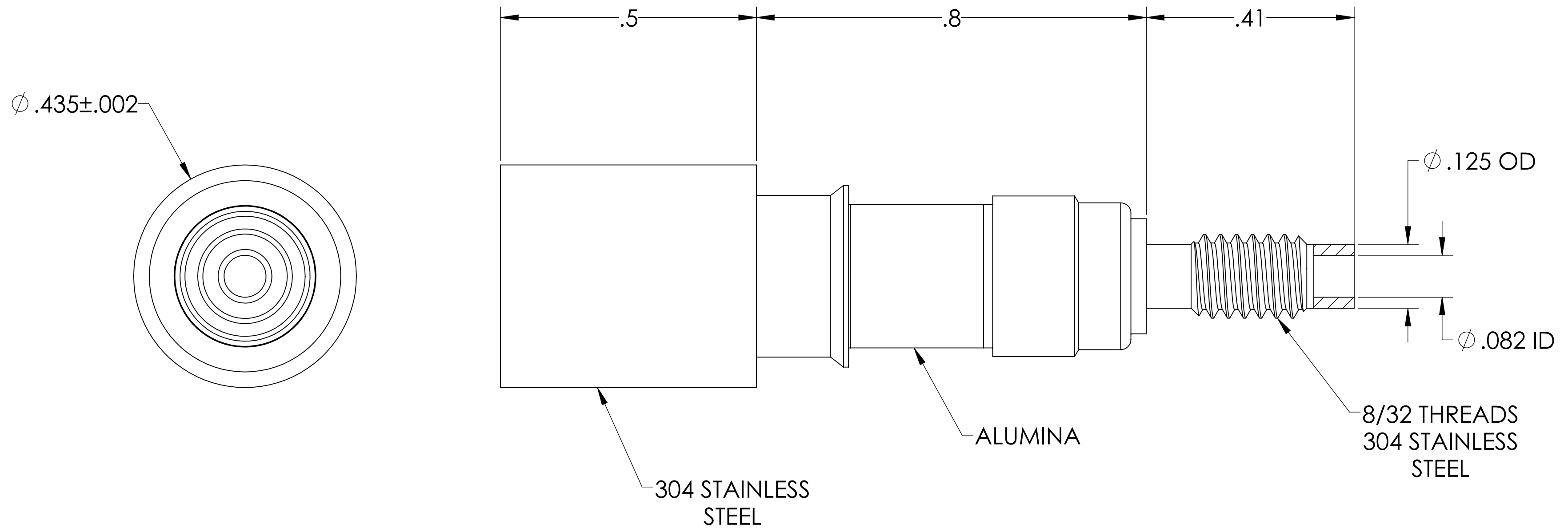
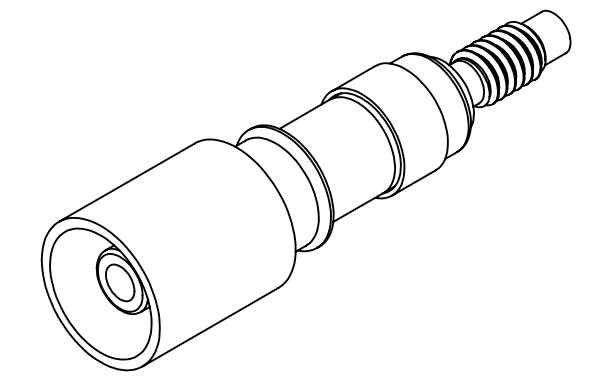

**NOTE:**

1. VOLTAGE: 5000 VOLTS DC
2. CURRENT: N/A
3. TEMPERATURE RATING: -100 TO 450°C

Power Feedthrough, 5000 Volts, 8/32 Threaded Stud, 0 Pin, 0.435" Dia Stainless Steel Weld Adapter, UHV Rated, Bakeable to 450 degrees C

UNLESS OTHERWISE SPECIFIED:	QUOTATION #		N/A
DIMENSIONS ARE IN INCHES TOLERANCES:	NAME	DATE	MPF PRODUCTS INC.
ANGULAR: MACH $\pm 1/2^\circ$	DRAWN	9/11/2015	
TWO PLACE DECIMAL $\pm .030$	CHECKED	9/11/2015	
THREE PLACE DECIMAL $\pm .015$	ENG APPR.	WJ 9/11/2015	
MATERIAL	THIRD ANGLE:		TITLE: POWER FEEDTHROUGH, 5000 VOLTS, 8/32 THREADED STUD, 0 PIN, 0.435" DIA STAINLESS STEEL WELD ADAPTER DOWNLOADED FROM MPFPI.COM
	APPLICATION		
	NEXT ASSY	USED ON	
FINISH	SURFACE FINISH: $\sqrt{63}$ OR BETTER		DWG. NO.
PLATING	UNLESS OTHERWISE SPECIFIED:		A0036-1-W
	ALL DIAMETERS CONCENTRIC WITHIN .005. REMOVE ALL BURRS AND SHARP EDGES		REV
	Friday, January 18, 2019 11:31:08 AM		