

MPF PRODUCTS INC.

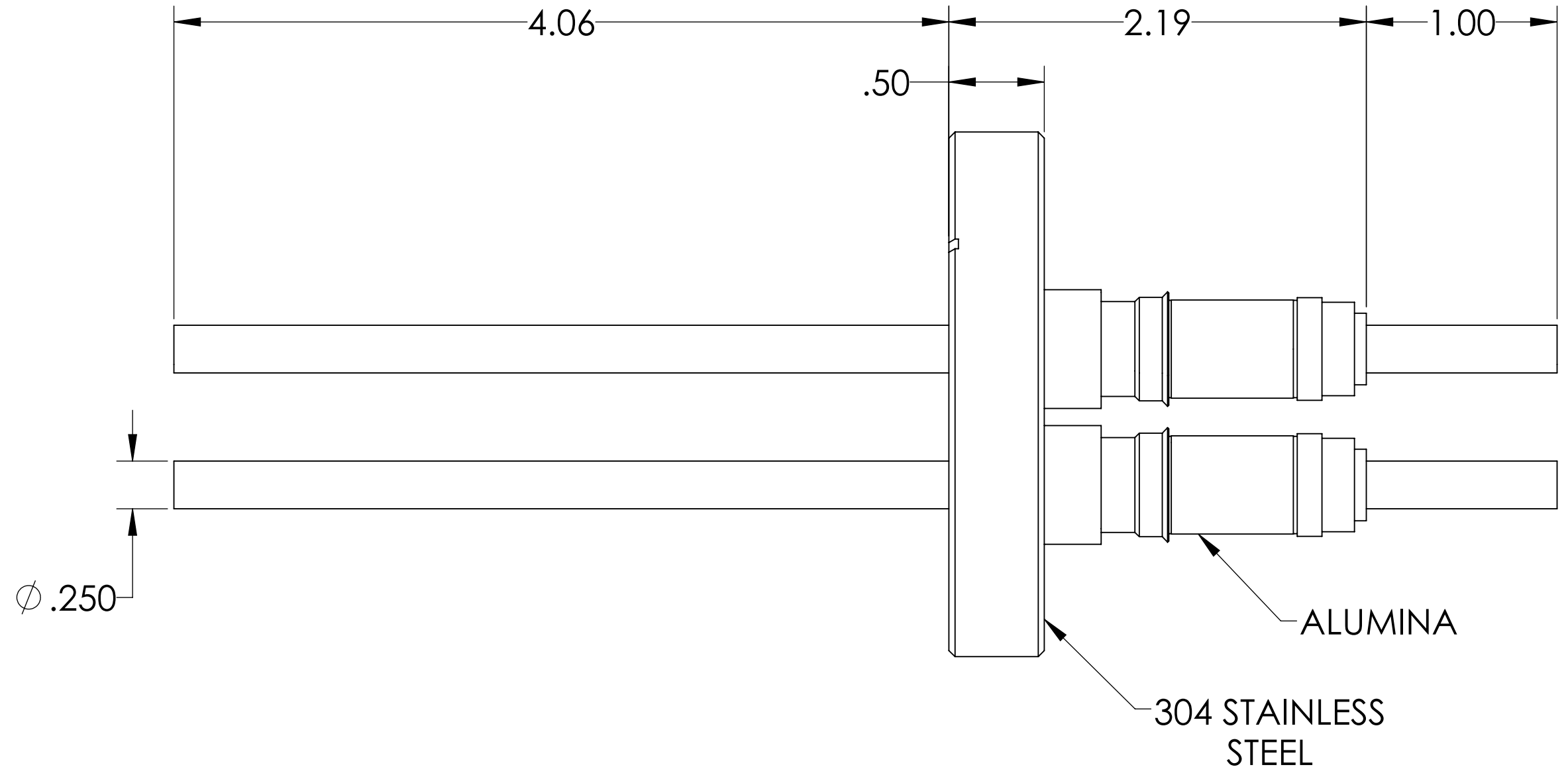
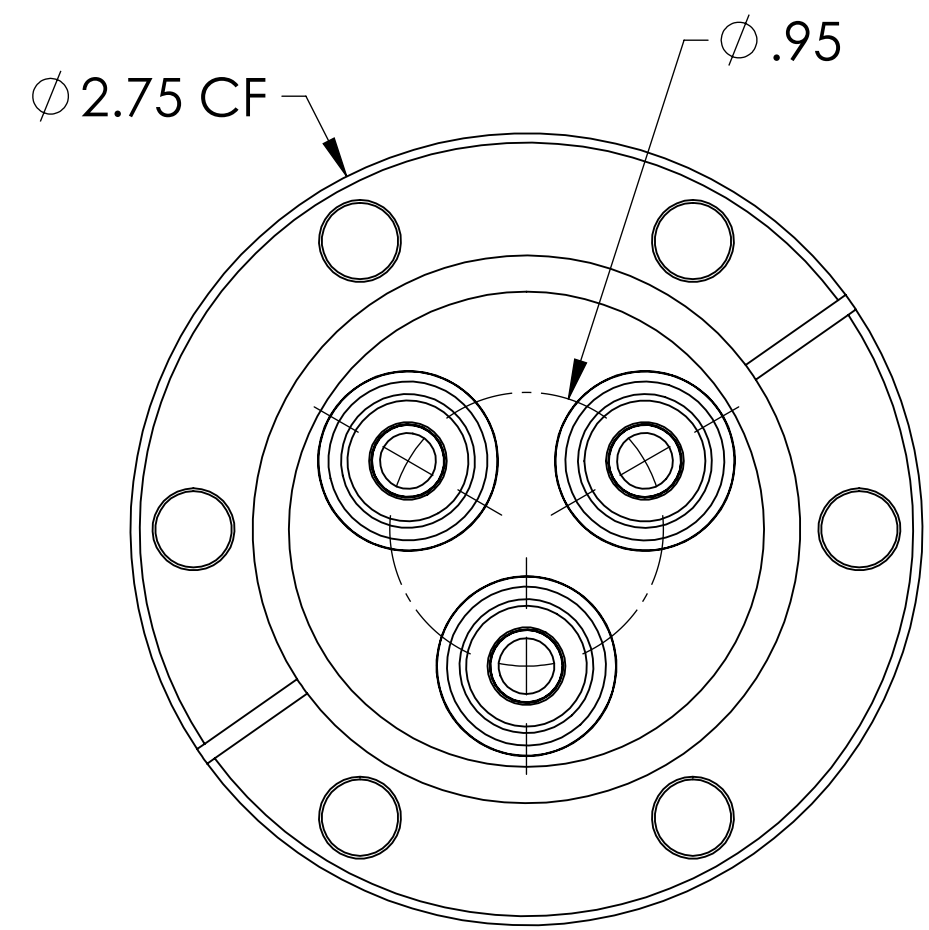
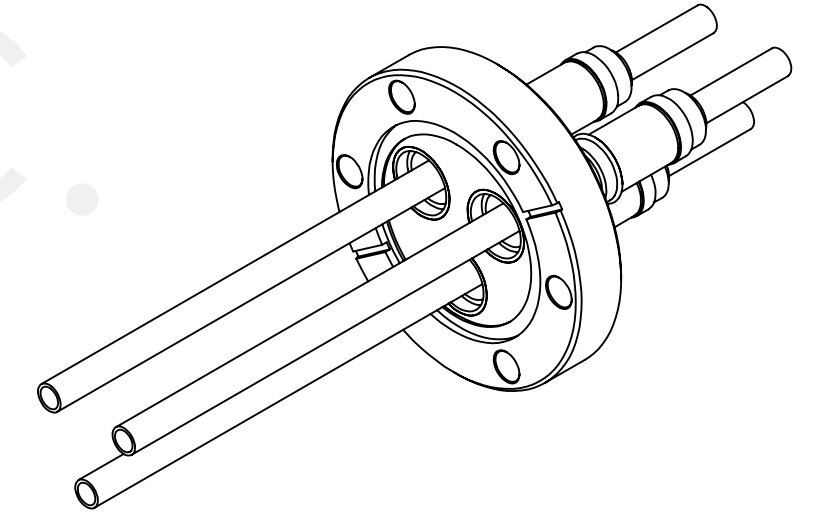

PART #	CONDUCTOR TYPE	CONDUCTOR MATERIAL	AMPS
A0064-1-CF	ROD	OFHC COPPER	180
A0064-2-CF	TUBE (.032 WALL)	OFHC COPPER	N/A
A0064-3-CF	ROD	304 STN STL	7
A0064-4-CF	TUBE (.032 WALL)	304 STN STL	N/A
A0064-5-CF	ROD	NICKEL 200	55
A0064-6-CF	TUBE (.032 WALL)	NICKEL 200	N/A
A0064-7-CF	ROD	MOLYBDENUM	93

- NOTE:
- VOLTAGE: 12,000 VOLTS DC
 - CURRENT: SEE TABLE
 - TEMPERATURE RATING: -100 TO 450°C

Power Feedthrough, 12 KV, 3 Pins, 0.25" Conductor, 2.75" Conflat Flange, UHV Rated, Bakeable to 450°C

UNLESS OTHERWISE SPECIFIED:		QUOTATION #		N/A		
DIMENSIONS ARE IN INCHES TOLERANCES:		NAME	DATE	MPF PRODUCTS INC. TITLE: POWER FEEDTHROUGH, 12 KV, 3 PINS, 0.25" CONDUCTOR, 2.75" CONFLAT FLANGE DWG. NO. A0064		
ANGULAR: MACH ± 1/2°		DRAWN	WJ			9/11/2015
TWO PLACE DECIMAL ± .030		CHECKED				9/11/2015
THREE PLACE DECIMAL ± .015		ENG APPR.	WJ			9/11/2015
MATERIAL		THIRD ANGLE:		APPLICATION: NEXT ASSY: USED ON:		
FINISH		SURFACE FINISH: 63 OR BETTER		SURFACE FINISH: 63 OR BETTER UNLESS OTHERWISE SPECIFIED: ALL DIAMETERS CONCENTRIC WITHIN .005. REMOVE ALL BURRS AND SHARP EDGES		
PLATING		UNLESS OTHERWISE SPECIFIED:		DWG. NO. A0064 REV.		
		ALL DIAMETERS CONCENTRIC WITHIN .005. REMOVE ALL BURRS AND SHARP EDGES		Downloaded from MPFPI.COM Tuesday, August 13, 2019 8:09:15 AM		