

# MPF PRODUCTS INC.

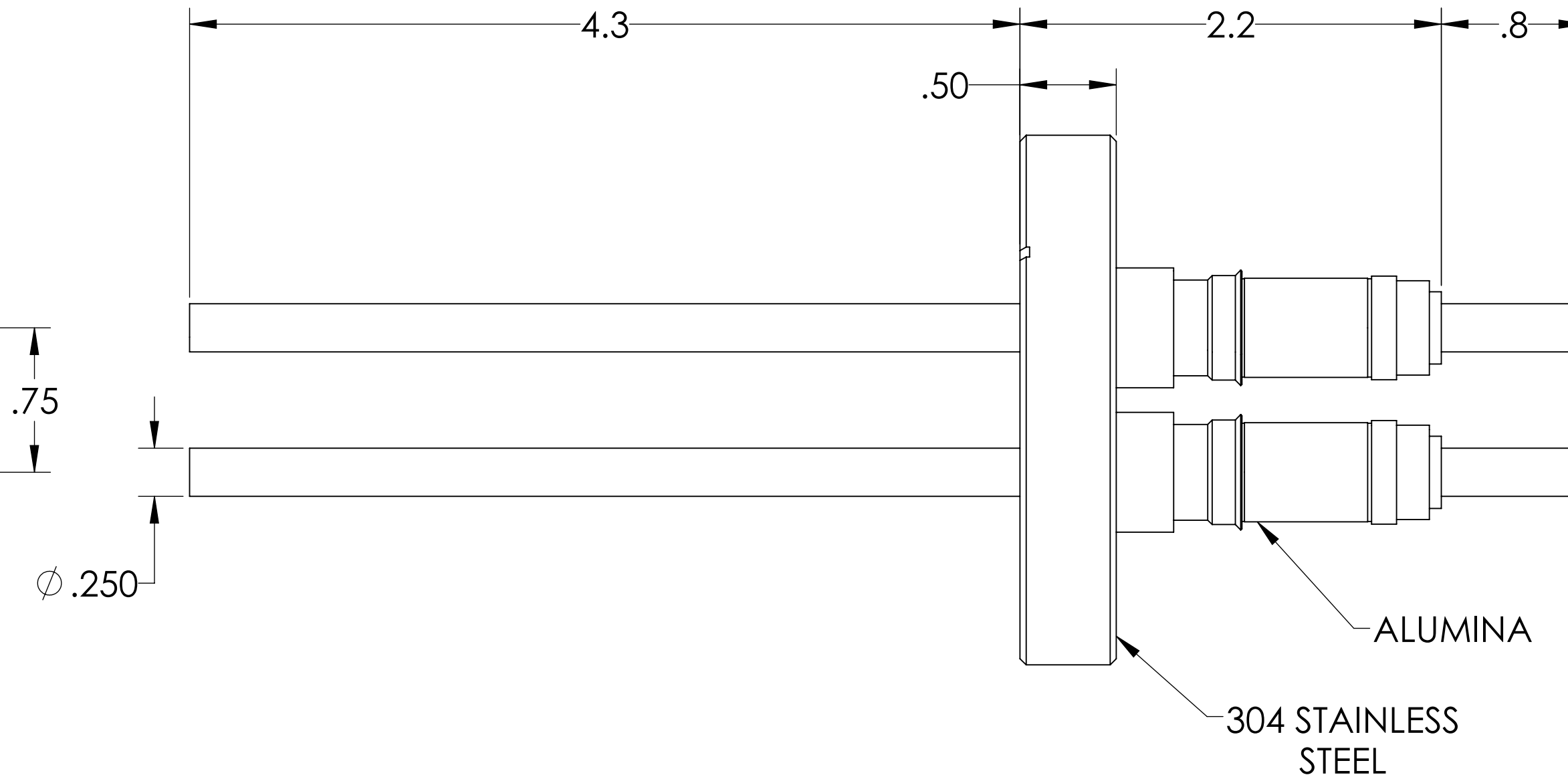
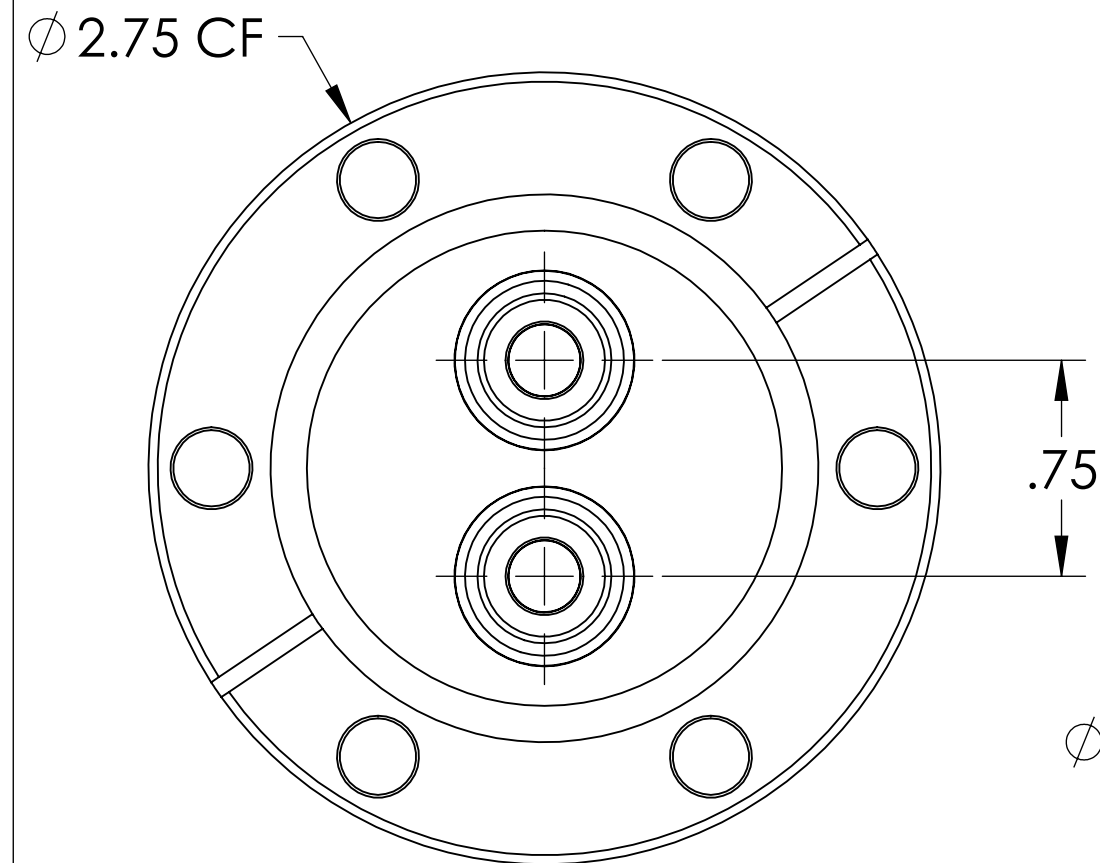
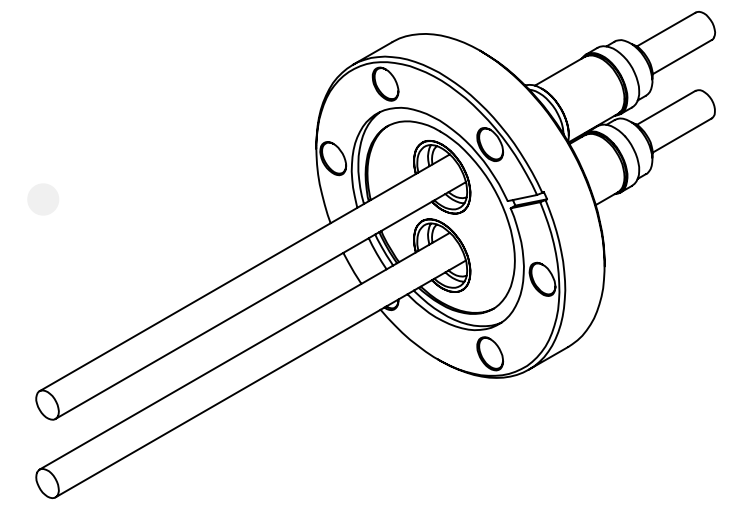

PART #	CONDUCTOR TYPE	CONDUCTOR MATERIAL	CURRENT RATING
A0065-1-CF	ROD	OFHC COPPER	180 AMPS
A0065-2-CF	TUBE ( .032 WALL )	OFHC COPPER	N/A
A0065-3-CF	ROD	304 STN STL	7 AMPS
A0065-4-CF	TUBE ( .032 WALL )	304 STN STL	N/A
A0065-5-CF	ROD	NICKEL 200	55 AMPS
A0065-6-CF	TUBE ( .032 WALL )	NICKEL 200	N/A
A0065-7-CF	ROD	MOLYBDENUM	93 AMPS

**NOTE:**

- VOLTAGE: 12,000 VOLTS DC
- CURRENT: SEE TABLE
- TEMPERATURE RATING: -100 TO 450°C

Power Feedthrough, 12 KV, 2 Pins, 0.25" Conductor, 2.75" Conflat Flange, UHV Rated, Bakeable to 450°C

UNLESS OTHERWISE SPECIFIED:		QUOTATION #		N/A	
DIMENSIONS ARE IN INCHES TOLERANCES:		NAME	DATE	<b>MPF PRODUCTS INC.</b> TITLE: POWER FEEDTHROUGH, 12 KV, 2 PINS, 0.25" CONDUCTOR, 2.75" CONFLAT FLANGE DWG. NO. <b>A0065</b>	
ANGULAR: MACH ± 1/2°		DRAWN	9/11/2015		
TWO PLACE DECIMAL ± .030		CHECKED	9/11/2015		
THREE PLACE DECIMAL ± .015		ENG APPR.	9/11/2015		
MATERIAL		THIRD ANGLE:		APPLICATION: NEXT ASSY      USED ON	
FINISH					
PLATING		SURFACE FINISH: 63/ OR BETTER		DOWNLOADED FROM MPFPI.COM Tuesday, August 13, 2019 8:08:14 AM	
		UNLESS OTHERWISE SPECIFIED:		REV	
		ALL DIAMETERS CONCENTRIC WITHIN .005. REMOVE ALL BURRS AND SHARP EDGES		A0065 Tuesday, August 13, 2019 8:08:14 AM	