

MPF PRODUCTS INC.

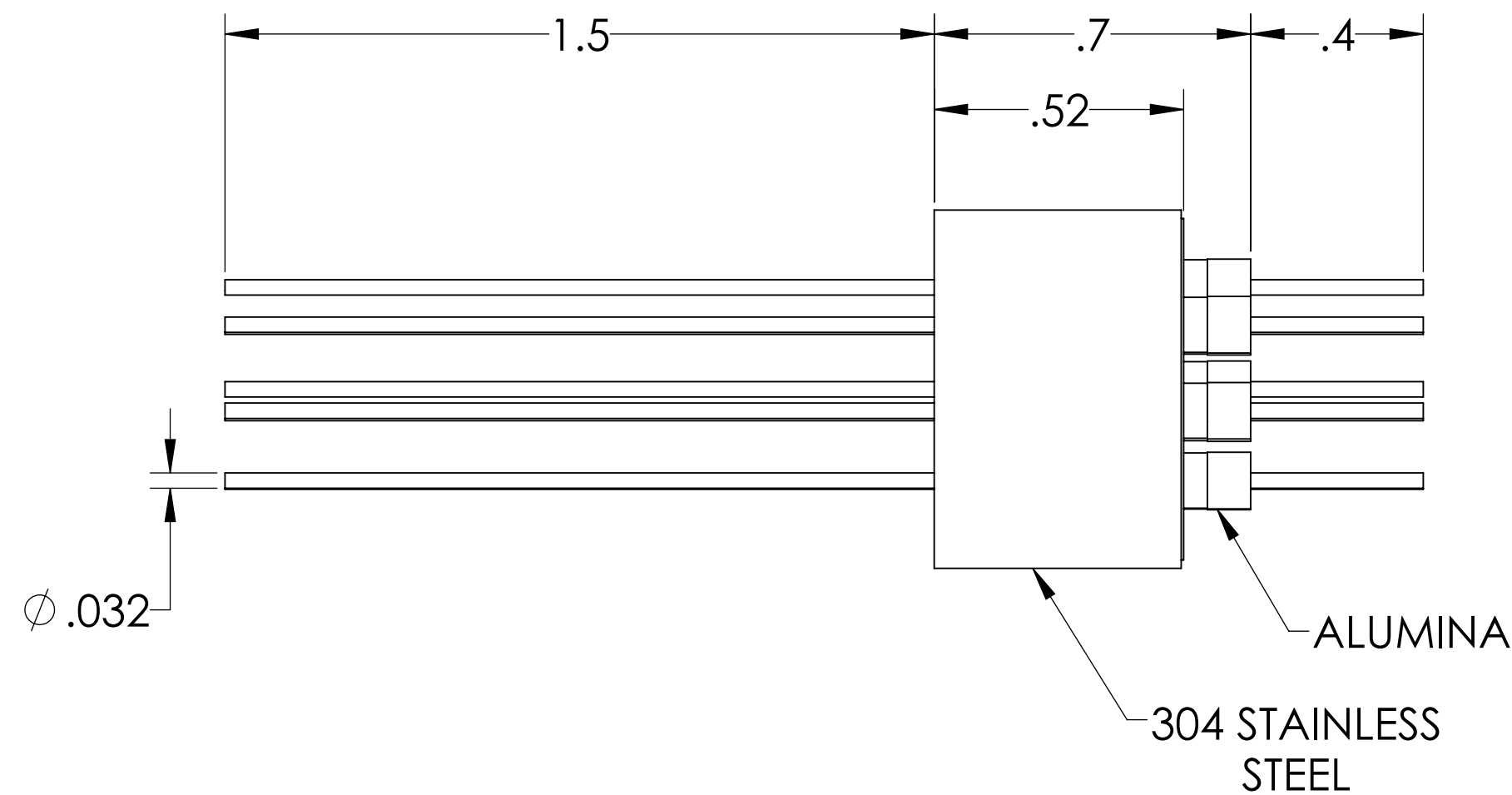
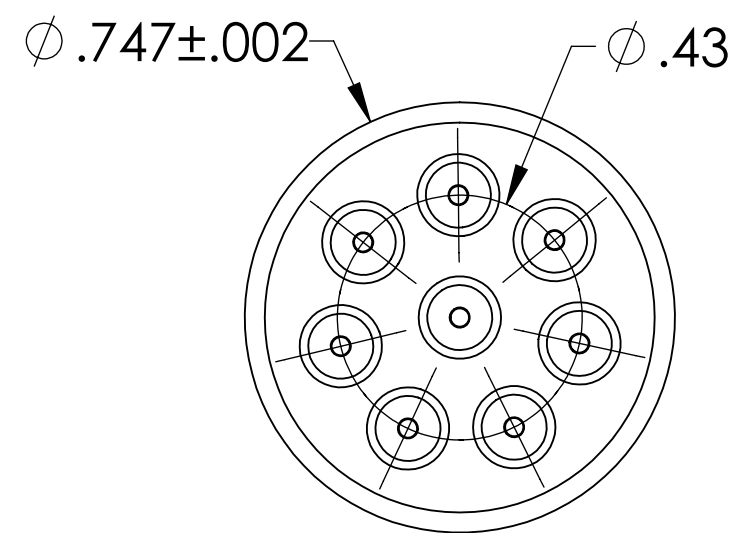
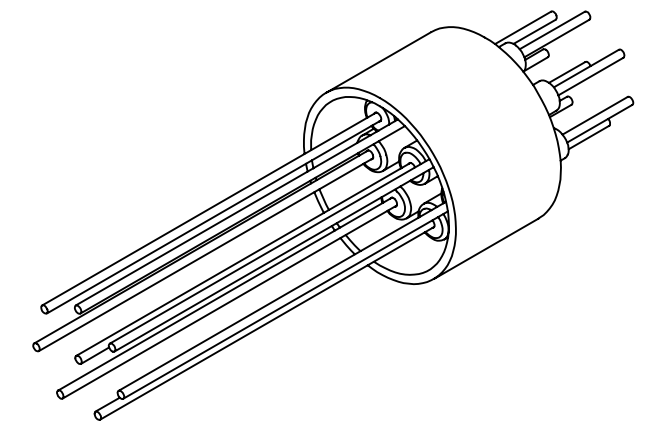

PART #	CONDUCTOR MATERIAL	CURRENT RATING
A0089-1-W	NICKEL 200	5 AMPS
A0089-2-W	304 STAINLESS STEEL	1 AMP
A0089-3-W	OFHC COPPER	15 AMPS
A0089-4-W	MOLYBDENUM	8 AMPS

NOTE:

1. VOLTAGE: 500 VOLTS DC
2. CURRENT: SEE TABLE
3. TEMPERATURE RATING: -100 TO 450°C

Power Feedthrough, 500 Volts, 8 Pins, 0.032" Conductor, 0.747" Dia Stainless Steel Weld Adapter, UHV Rated, Bakeable to 450°C

UNLESS OTHERWISE SPECIFIED:	QUOTATION #	N/A	
DIMENSIONS ARE IN INCHES TOLERANCES:	DRAWN	NAME	DATE
ANGULAR: MACH ± 1/2°	WJ	WJ	9/11/2015
TWO PLACE DECIMAL ± .030	CHECKED		9/11/2015
THREE PLACE DECIMAL ± .015	ENG APPR.	WJ	9/11/2015
MATERIAL	THIRD ANGLE:		
FINISH	APPLICATION		
PLATING	NEXT ASSY	USED ON	
	SURFACE FINISH:	63/	OR BETTER
	UNLESS OTHERWISE SPECIFIED:	ALL DIAMETERS CONCENTRIC WITHIN .005. REMOVE ALL BURRS AND SHARP EDGES	
	DOWNLOADED FROM MPFPI.COM	DWG. NO.	REV
		A0089	
	Friday, October 12, 2018 8:49:13 AM		