

MPF PRODUCTS INC.

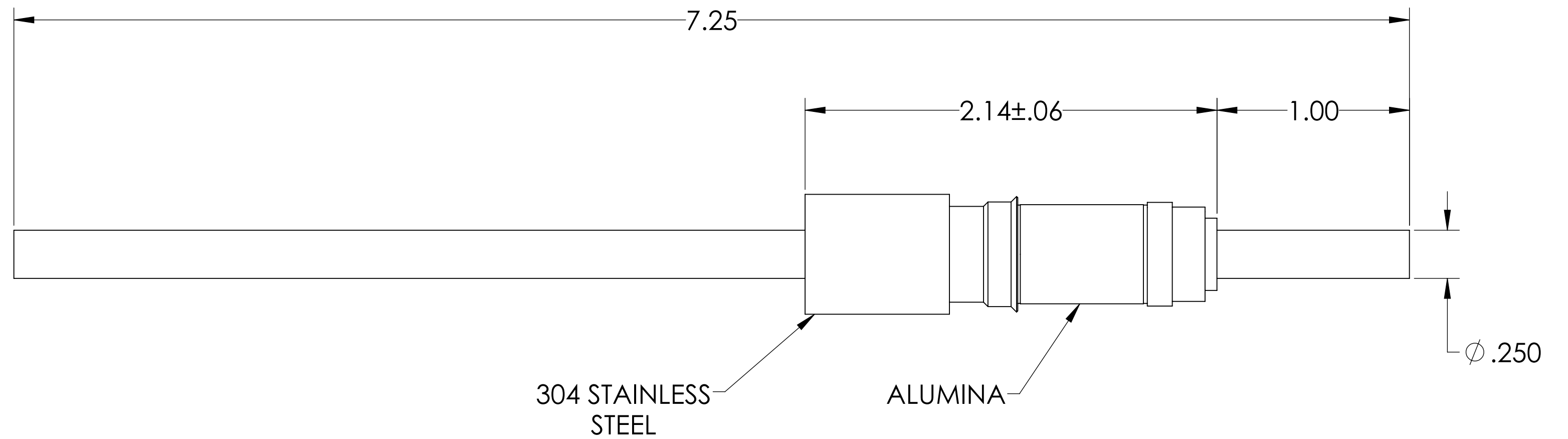
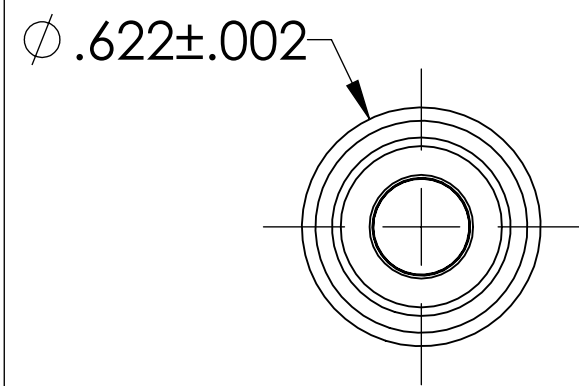
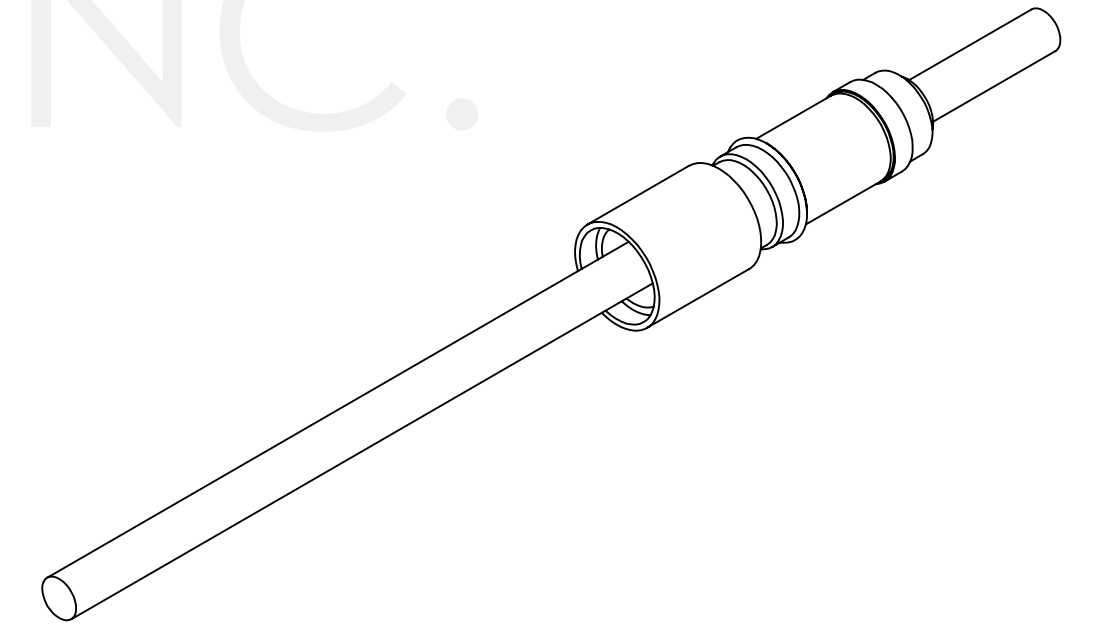

PART #	CONDUCTOR TYPE	CONDUCTOR MATERIAL	CURRENT RATING
A0106-1-W	ROD	OFHC COPPER	180 AMPS
A0106-2-W	ROD	304 STAINLESS STEEL	7 AMPS
A0106-3-W	ROD	NICKEL 200	55 AMPS
A0106-4-W	TUBE (.032 WALL)	OFHC COPPER	N/A
A0106-5-W	TUBE (.032 WALL)	304 STAINLESS STEEL	N/A
A0106-6-W	TUBE (.032 WALL)	NICKEL 200	N/A
A0106-7-W	ROD	MOLYBDENUM	93 AMPS

NOTE:

- VOLTAGE: 12,000 VOLTS DC
- CURRENT: SEE TABLE
- TEMPERATURE RATING: -100 TO 450°C

Power Feedthrough, 12 KV, 1 Pin, 0.250" Conductor, 0.622" Dia Stainless Steel Weld Adapter, UHV Rated, Bakeable to 450°C

UNLESS OTHERWISE SPECIFIED:		QUOTATION #		N/A		
DIMENSIONS ARE IN INCHES		NAME	DATE	MPF PRODUCTS INC. TITLE: POWER FEEDTHROUGH, 12 KV, 1 PIN, 0.622" WELD ADAPTER DOWNLOADED FROM MPFPI.COM DWG. NO. A0106 REV		
TOLERANCES:		DRAWN	WJ			9/11/2015
ANGULAR: MACH ± 1/2°		CHECKED				9/11/2015
TWO PLACE DECIMAL ± .030		ENG APPR.	WJ			9/11/2015
THREE PLACE DECIMAL ± .015		THIRD ANGLE:				
MATERIAL						
FINISH		APPLICATION				
PLATING		NEXT ASSY		USED ON		
		SURFACE FINISH:		63/ OR BETTER		
		UNLESS OTHERWISE SPECIFIED:				
		ALL DIAMETERS CONCENTRIC WITHIN .005.		REMOVE ALL BURRS AND SHARP EDGES		
		TUESDAY, AUGUST 13, 2019 8:07:29 AM				