

# MPF PRODUCTS INC.

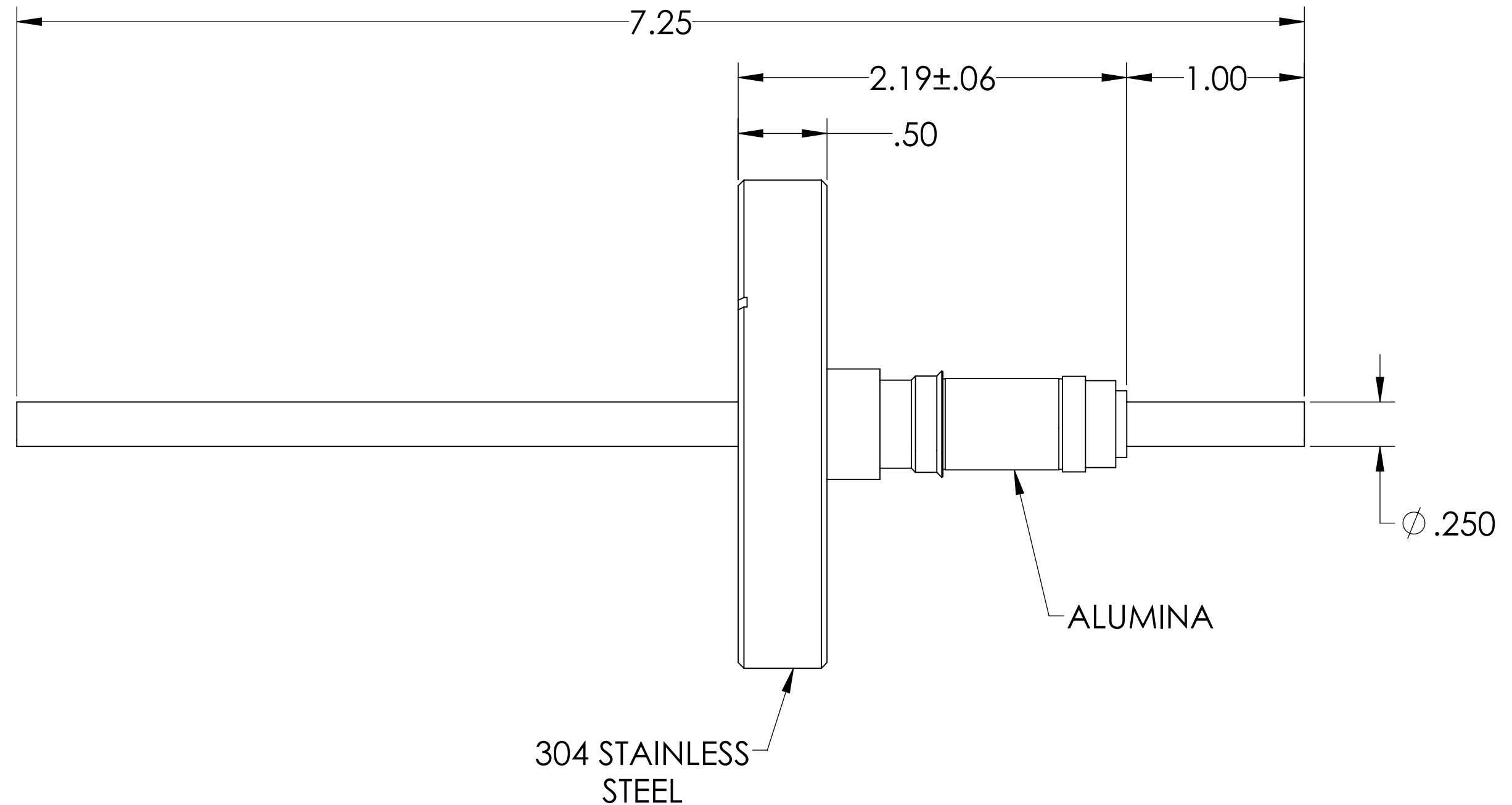
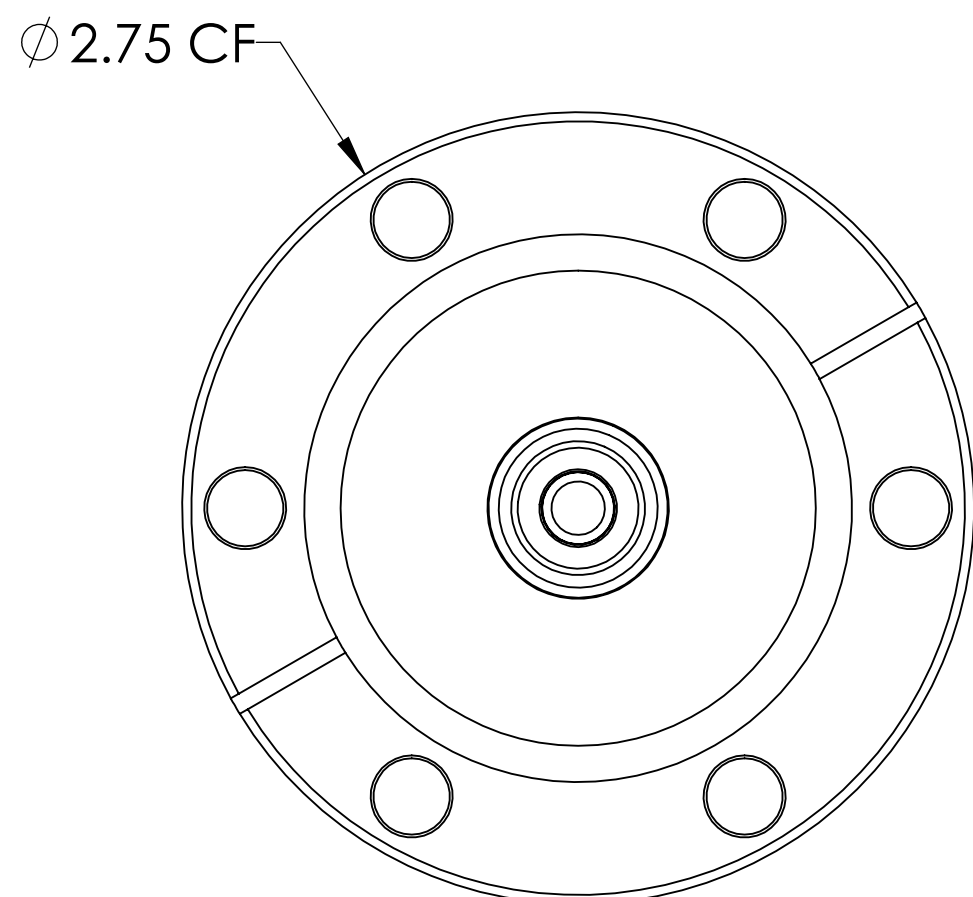
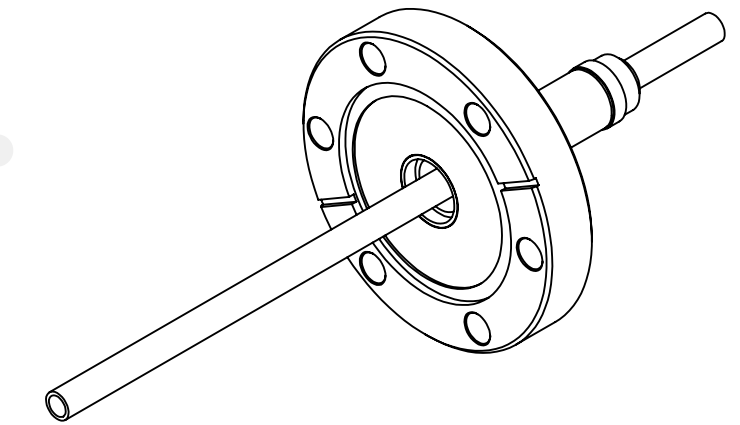

PART #	CONDUCTOR TYPE	CONDUCTOR MATERIAL	CURRENT RATING
A0113-1-CF	ROD	OFHC COPPER	180 AMPS
A0113-2-CF	TUBE (.032 WALL)	OFHC COPPER	N/A
A0113-3-CF	ROD	304 STAINLESS STEEL	7 AMPS
A0113-4-CF	TUBE (.032 WALL)	304 STAINLESS STEEL	N/A
A0113-5-CF	ROD	NICKEL 200	55 AMPS
A0113-6-CF	TUBE (.032 WALL)	NICKEL 200	N/A
A0113-7-CF	ROD	MOLYBDENUM	93 AMPS

- NOTE:
1. VOLTAGE: 12,000 VOLTS DC
  2. CURRENT: SEE TABLE
  3. TEMPERATURE RATING: -100 TO 450°C

Power Feedthrough, 12 KV, 1 Pin, 0.250" Conductor, 2.75" Conlat Flange, UHV Rated, Bakeable to 450°C

UNLESS OTHERWISE SPECIFIED:		QUOTATION #	
DIMENSIONS ARE IN INCHES		N/A	
TOLERANCES:		NAME	DATE
ANGULAR: MACH ± 1/2°		WJ	9/11/2015
TWO PLACE DECIMAL ± .030		CHECKED	9/11/2015
THREE PLACE DECIMAL ± .015		ENG APPR.	WJ 9/11/2015
MATERIAL		THIRD ANGLE:	
FINISH		APPLICATION	
PLATING		NEXT ASSY	USED ON
		SURFACE FINISH: 63 OR BETTER	
		UNLESS OTHERWISE SPECIFIED:	
		ALL DIAMETERS CONCENTRIC WITHIN .005. REMOVE ALL BURRS AND SHARP EDGES	
		TITLE:	
		POWER FEEDTHROUGH, 12 KV, 1 PIN, 2.75" CONFLAT FLANGE	
		DWG. NO. A0113	
		REV	
		Tuesdays, August 13, 2019 8:07:13 AM	