

MPF PRODUCTS INC.

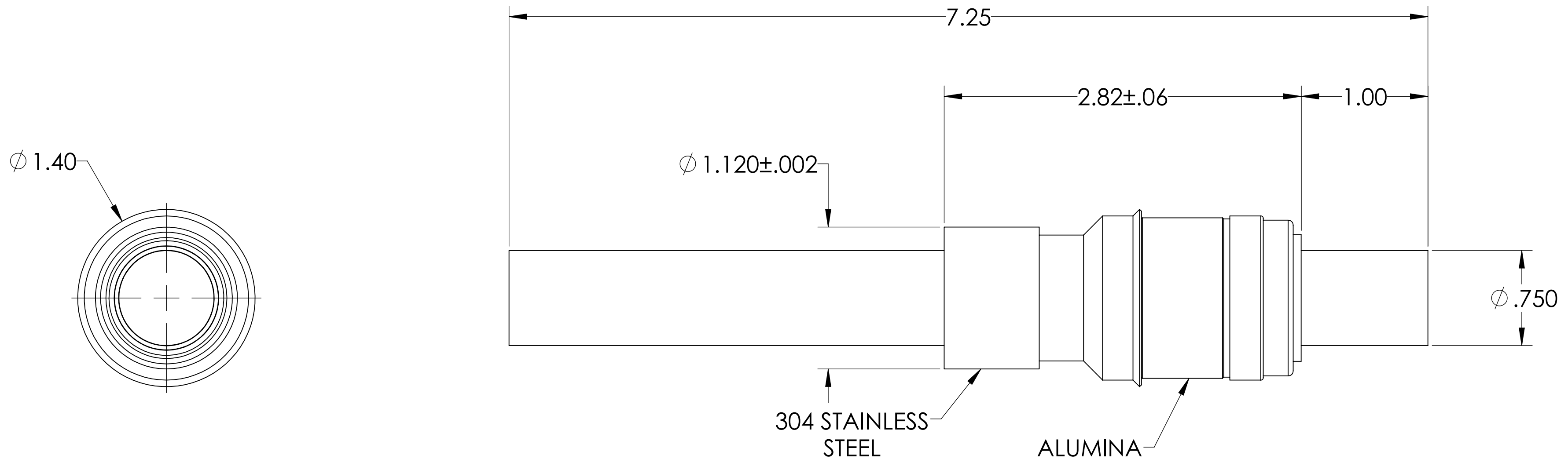
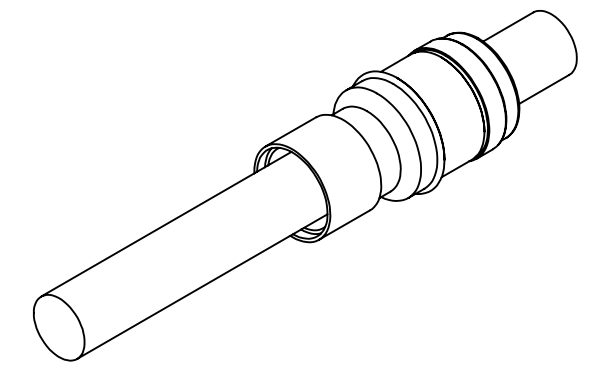

PART #	CONDUCTOR TYPE	CONDUCTOR MATERIAL	CURRENT RATING
A0122-1-W	TUBE (.032 WALL)	OFHC COPPER	N/A
A0122-2-W	ROD	OFHC COPPER	800
A0122-3-W	ROD	304 STN STL	52
A0122-4-W	TUBE (.032 WALL)	304 STN STL	N/A
A0122-5-W	ROD	NICKEL 200	250

NOTE:

1. VOLTAGE: 8000 VOLTS DC
2. CURRENT: SEE TABLE
3. TEMPERATURE RATING: -100 TO 450°C

Power Feedthrough, 8000 Volts, 1 Pin, 0.750" Conductor, 1.120" Dia Stainless Steel Weld Adapter, UHV Rated, Bakeable to 450°C

UNLESS OTHERWISE SPECIFIED:		QUOTATION #		N/A	
DIMENSIONS ARE IN INCHES TOLERANCES:		NAME	DATE	MPF PRODUCTS INC.	
ANGULAR: MACH ± 1/2°		DRAWN	9/11/2015		
TWO PLACE DECIMAL ± .030		CHECKED	9/11/2015		
THREE PLACE DECIMAL ± .015		ENG APPR.	9/11/2015		
MATERIAL		THIRD ANGLE:		POWER FEEDTHROUGH, 8000 VOLTS, 1 PIN, 1.120" WELD ADAPTER	
FINISH		APPLICATION			
PLATING		NEXT ASSY USED ON			
		SURFACE FINISH: 63 OR BETTER			
		UNLESS OTHERWISE SPECIFIED:		DWG. NO. A0122	
		ALL DIAMETERS CONCENTRIC WITHIN .005. REMOVE ALL BURRS AND SHARP EDGES		REV	
		Friday, January 18, 2019 11:21:25 AM		DOWNLOADED FROM MPFPI.COM	