

MPF PRODUCTS INC.

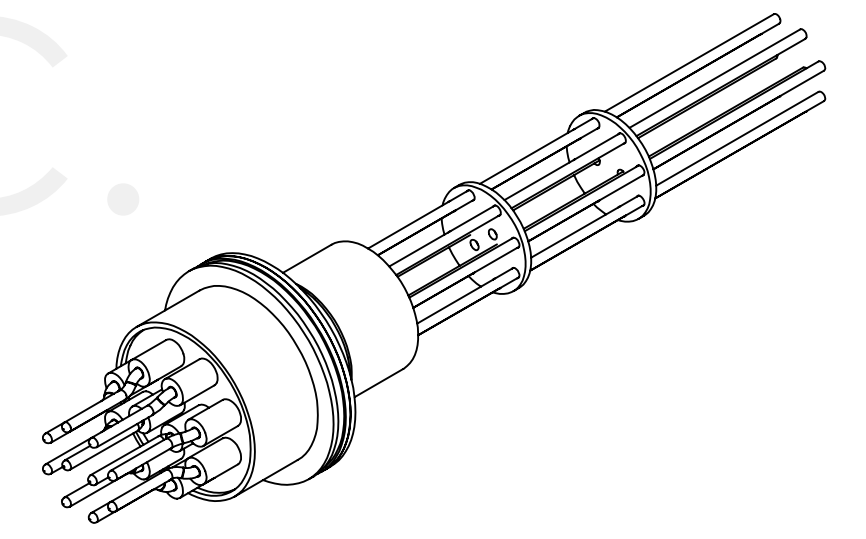

NOTES:

*** TYPE K:**

ALUMEL CONDUCTORS HAVE A NEGATIVE POLARITY (MAGNETIC) AND THE VACUUM SIDE ENDS ARE FLAT.
 CHROMEL CONDUCTORS HAVE A POSITIVE POLARITY (NON - MAGNETIC) AND THE VACUUM SIDE ENDS HAVE A RADIUS.

*** TYPE J:**

CONSTANTAN CONDUCTORS HAVE A NEGATIVE POLARITY (NON - MAGNETIC) AND THE VACUUM SIDE ENDS ARE FLAT.
 IRON CONDUCTORS HAVE A POSITIVE POLARITY (MAGNETIC) AND THE VACUUM SIDE ENDS HAVE A RADIUS.

*** TYPE E:**

CONSTANTAN CONDUCTORS HAVE A NEGATIVE POLARITY (NON - MAGNETIC) AND THE VACUUM SIDE ENDS ARE FLAT.
 CHROMEL CONDUCTORS HAVE A POSITIVE POLARITY (NON - MAGNETIC) AND THE VACUUM SIDE ENDS HAVE A RADIUS.

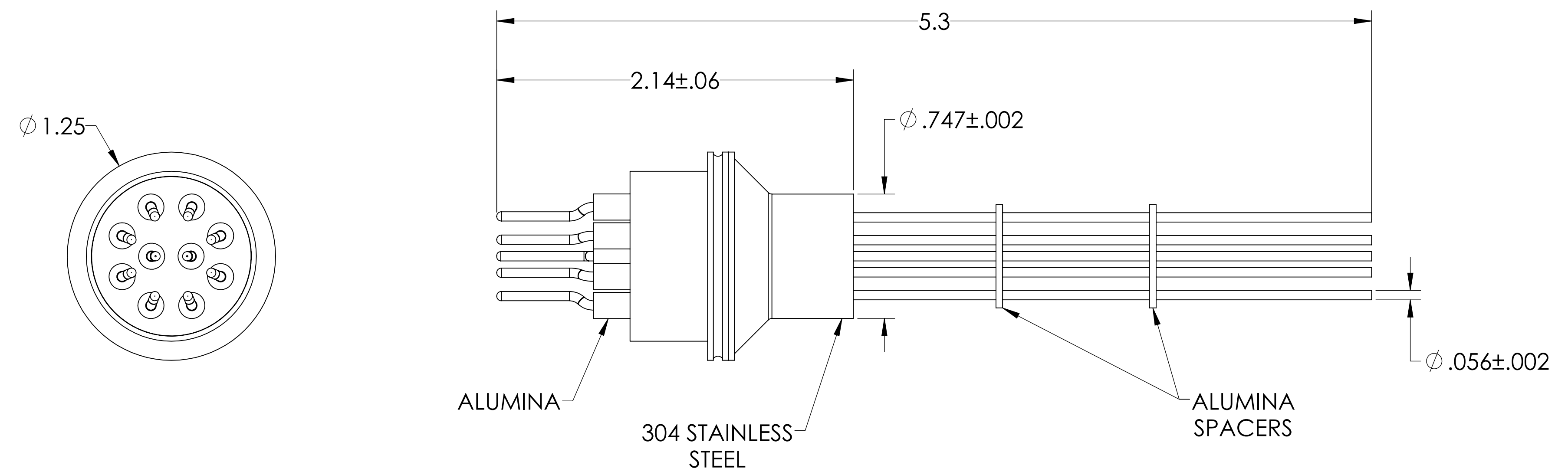

PART #	T/C TYPE
A0184-1-W	K
A0184-2-W	J
A0184-3-W	E

SPECIFICATIONS:

1. TEMPERATURE RATING: -100 TO 450°C
2. LEAK RATE < 1X10-9 ATM CC/SEC HE

Thermocouple Feedthrough, 5 Pairs, 0.75" Dia Stainless Steel Weld Adapter

UNLESS OTHERWISE SPECIFIED:		QUOTATION #		N/A	
DIMENSIONS ARE IN INCHES		DRAWN	NAME	DATE	MPF PRODUCTS INC.
TOLERANCES:		WJ	WJ	9/11/2015	
ANGULAR: MACH ± 1/2°		CHECKED	WJ	9/11/2015	
TWO PLACE DECIMAL ± .030		ENG APPR.	WJ	9/11/2015	TITLE:
THREE PLACE DECIMAL ± .015		THIRD ANGLE:			THERMOCOUPLE, 5 PAIRS, .747" WELD ADAPTER
MATERIAL		APPLICATION			
FINISH		NEXT ASSY			DOWNLOADED FROM MPFPI.COM
PLATING		USED ON			DWG. NO.
SURFACE FINISH: 63 OR BETTER		UNLESS OTHERWISE SPECIFIED:			A0184
ALL DIAMETERS CONCENTRIC WITHIN .005. REMOVE ALL BURRS AND SHARP EDGES		Friday, February 8, 2019 8:59:10 AM			REV