

# MPF PRODUCTS INC.

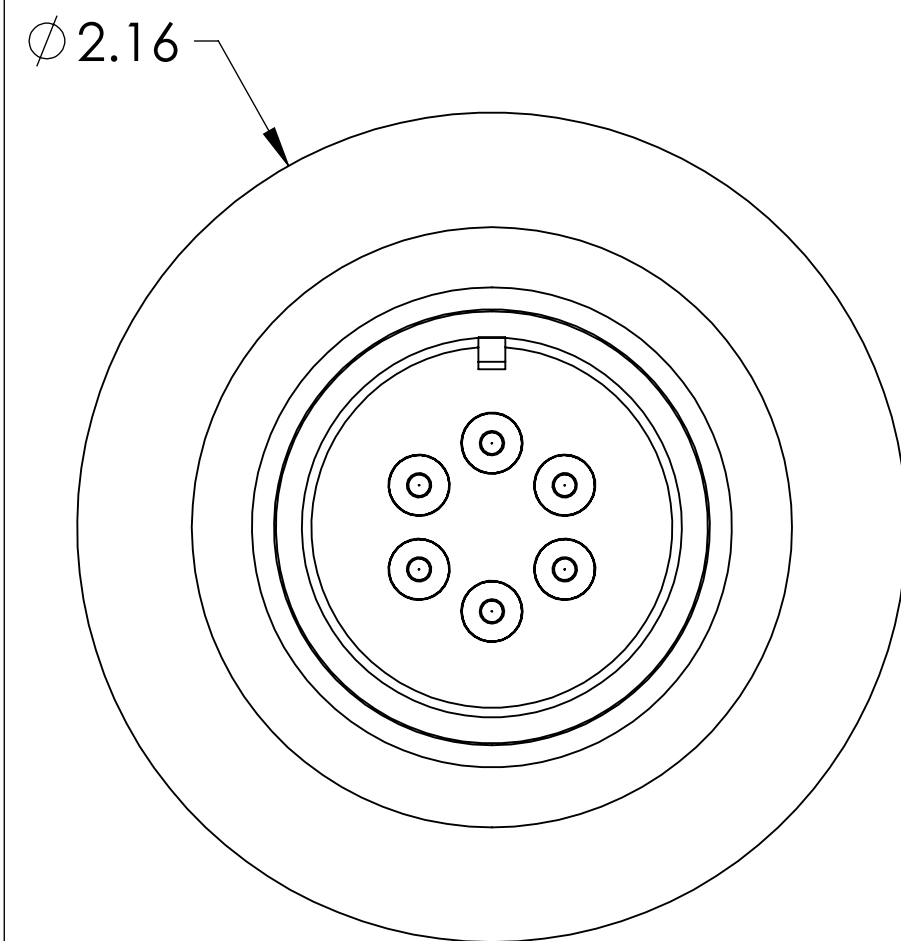

Ø 2.16

1-1/8"-18 THREAD

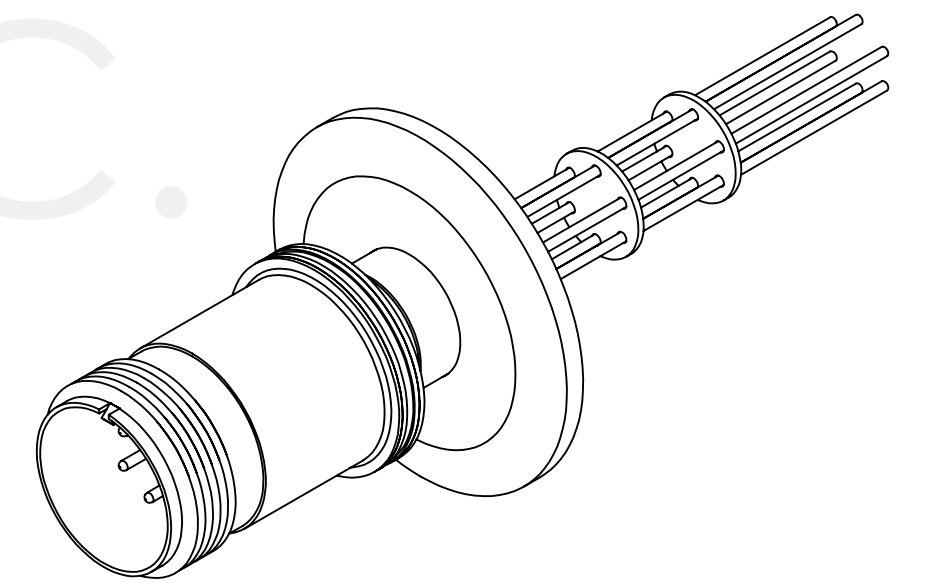
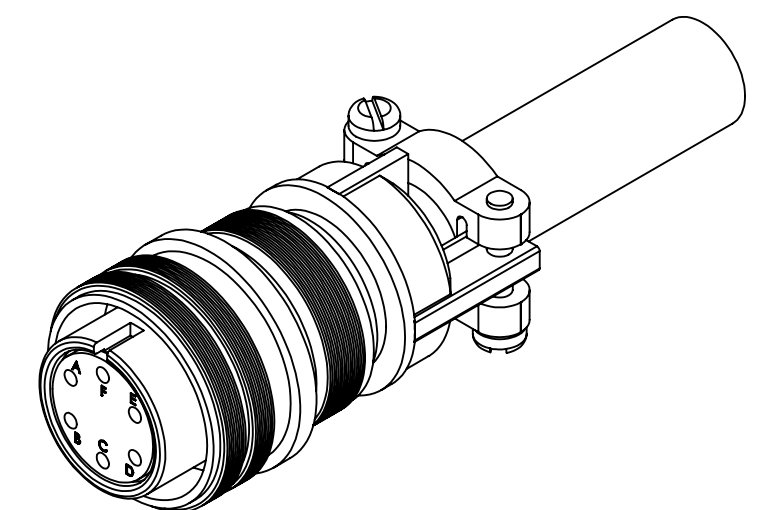
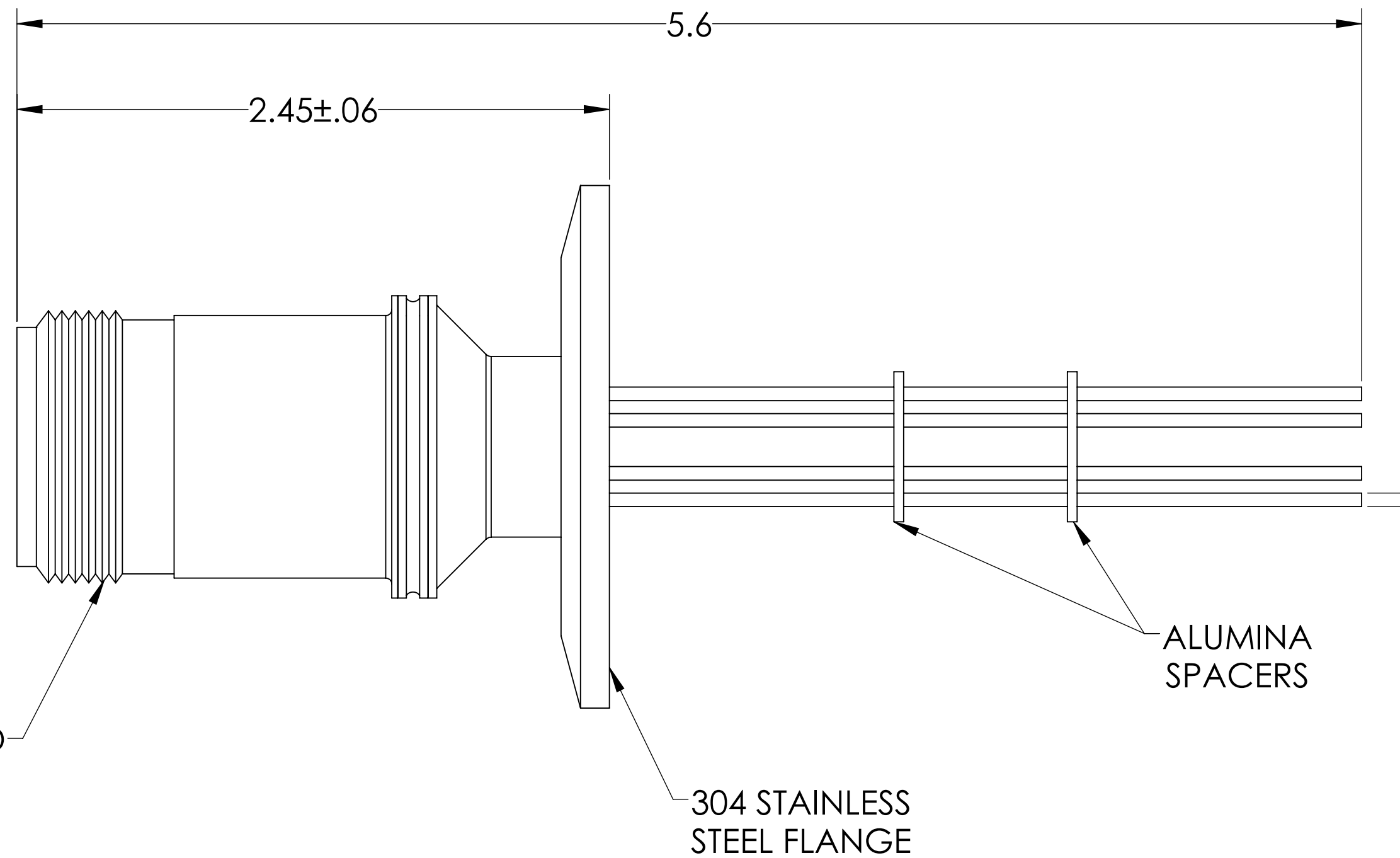

**SPECIFICATIONS:**

1. VOLTAGE: 700 VOLTS DC
2. CURRENT: 10 AMPS PER PIN, 36 AMPS FULL LOAD
3. TEMPERATURE RATING: -100 TO 450°C WITHOUT CONNECTOR
4. LEAK RATE < 1X10-9 ATM CC/SEC HE

MS Series, Multipin Feedthrough, 6 Pins, 700 Volts, 10 Amps per Pin, 0.056" Dia Conductors w/ Air-side Connector, 2.16" QF/KF

UNLESS OTHERWISE SPECIFIED:		QUOTATION #		N/A	
DIMENSIONS ARE IN INCHES		NAME	DATE	MPF PRODUCTS INC.	
TOLERANCES:		DRAWN	9/11/2015		
ANGULAR: MACH ± 1/2°		CHECKED	9/11/2015		
TWO PLACE DECIMAL ± .030		ENG APPR.	9/11/2015		
THREE PLACE DECIMAL ± .015		THIRD ANGLE:		TITLE:	
MATERIAL				MULTIPIN, 6 PINS, 700V, 10A, 2.16 QF/KF	
FINISH		APPLICATION		DOWNLOADED FROM MPFPI.COM	
PLATING		NEXT ASSY		DWG. NO.	
		USED ON		A0194-8-QF	
		SURFACE FINISH: 63 OR BETTER		REV	
		UNLESS OTHERWISE SPECIFIED:		Thursday, February 7, 2019 8:26:14 AM	
		ALL DIAMETERS CONCENTRIC WITHIN .005. REMOVE ALL BURRS AND SHARP EDGES			