

MPF PRODUCTS INC.

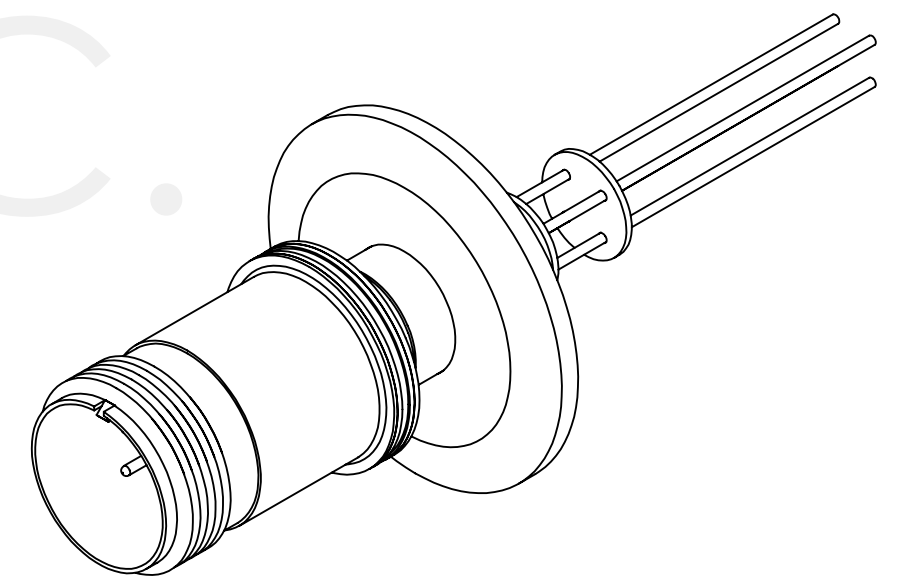

NOTES:
 * TYPE K:
 ALUMEL CONDUCTORS HAVE A NEGATIVE POLARITY (MAGNETIC) AND THE VACUUM SIDE ENDS ARE FLAT.
 CHROMEL CONDUCTORS HAVE A POSITIVE POLARITY (NON - MAGNETIC) AND THE VACUUM SIDE ENDS HAVE A RADIUS.
 * TYPE J:
 CONSTANTAN CONDUCTORS HAVE A NEGATIVE POLARITY (NON - MAGNETIC) AND THE VACUUM SIDE ENDS ARE FLAT.
 IRON CONDUCTORS HAVE A POSITIVE POLARITY (MAGNETIC) AND THE VACUUM SIDE ENDS HAVE A RADIUS.
 * TYPE E:
 CONSTANTAN CONDUCTORS HAVE A NEGATIVE POLARITY (NON - MAGNETIC) AND THE VACUUM SIDE ENDS ARE FLAT.
 CHROMEL CONDUCTORS HAVE A POSITIVE POLARITY (NON - MAGNETIC) AND THE VACUUM SIDE ENDS HAVE A RADIUS.

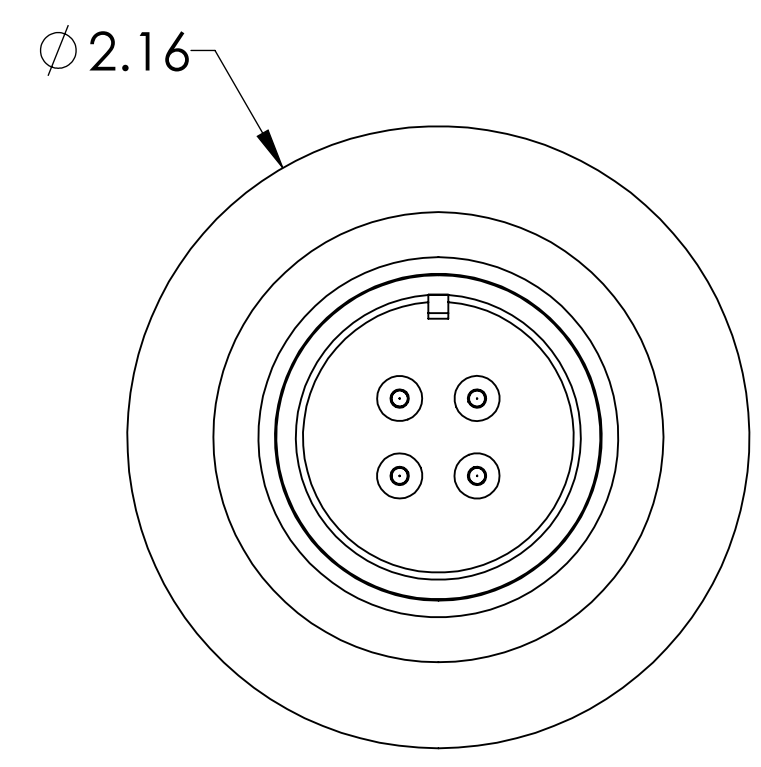

2 PAIRS

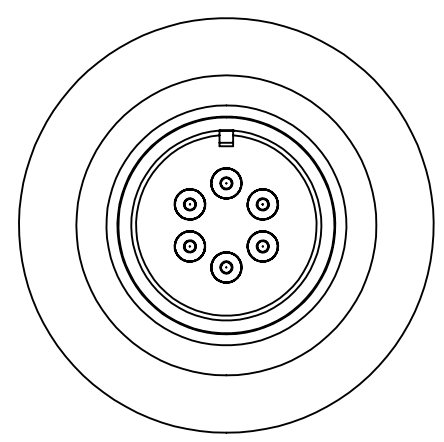

3 PAIRS

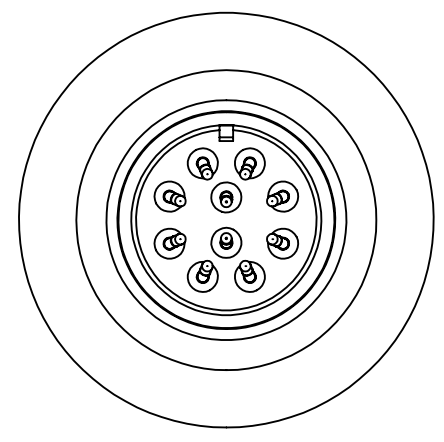

5 PAIRS

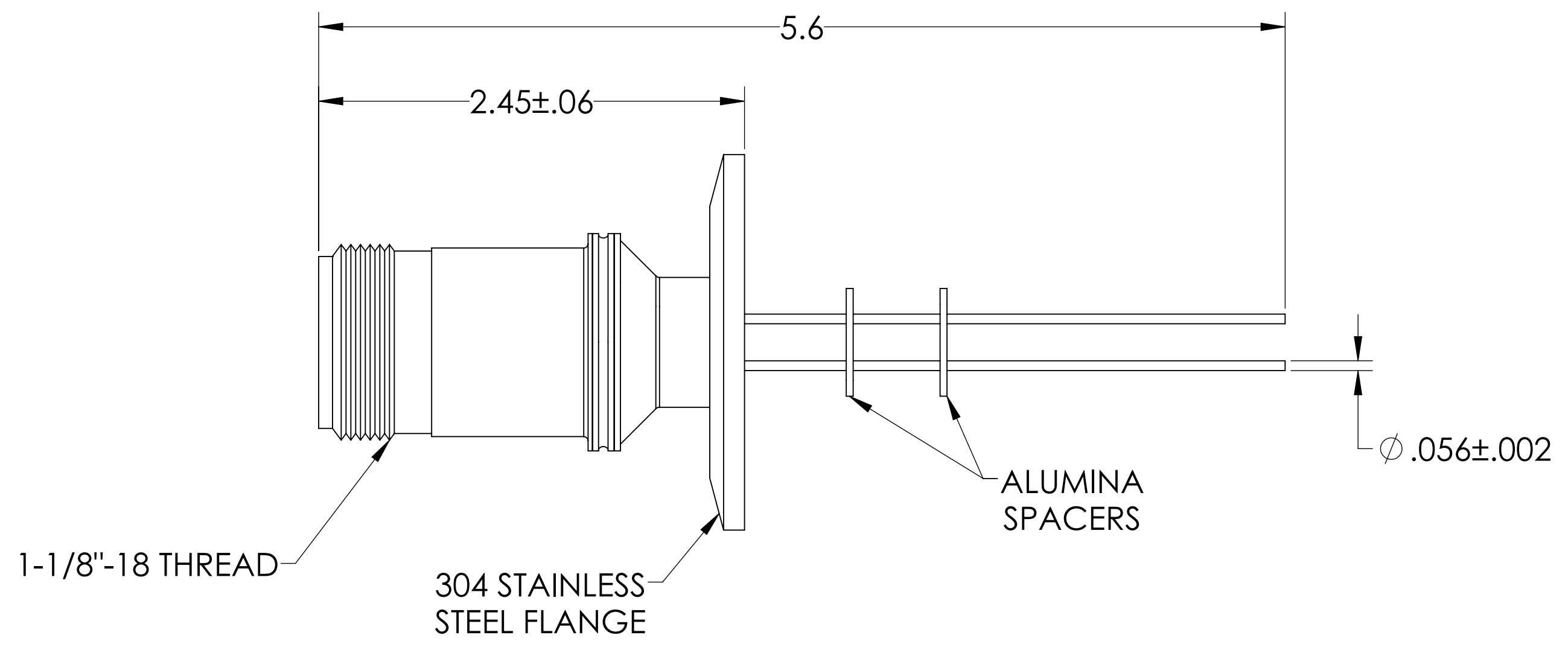

PART #	T/C TYPE	# OF PAIRS
A0194-1-QF	K	2
A0194-2-QF	J	2
A0194-3-QF	E	2
A0194-5-QF	K	3
A0194-6-QF	J	3
A0194-7-QF	E	3
A0194-9-QF	K	5
A0194-10-QF	J	5
A0194-11-QF	E	5

2 PAIRS CONNECTOR

3 PAIRS CONNECTOR

5 PAIRS CONNECTOR

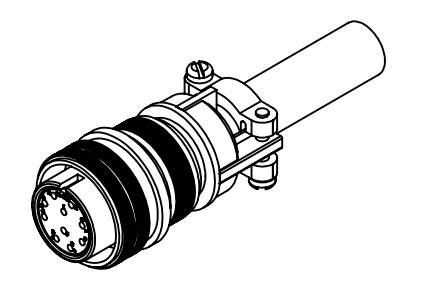
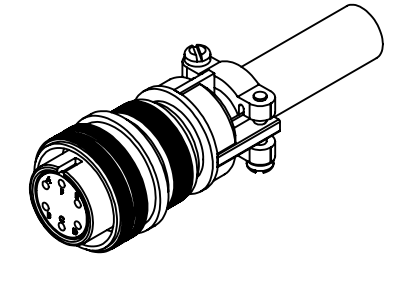
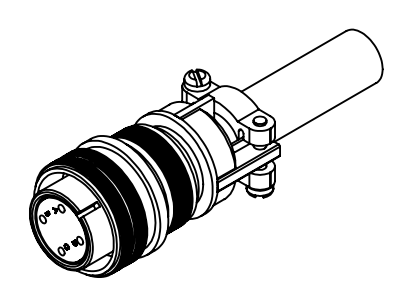

SPECIFICATIONS:
 1. TEMPERATURE RATING: -100 TO 450°C
 2. LEAK RATE < 1X10-9 ATM CC/SEC HE

MS Series, Thermocouple Feedthrough, w/Air-side Connector, 2.16" QF/KF

UNLESS OTHERWISE SPECIFIED:		QUOTATION #		N/A	
DIMENSIONS ARE IN INCHES TOLERANCES:		NAME	DATE	MPF PRODUCTS INC.	
ANGULAR: MACH ± 1/2°		DRAWN	9/11/2015		
TWO PLACE DECIMAL ± .030		CHECKED	9/11/2015		
THREE PLACE DECIMAL ± .015		ENG APPR.	WJ 9/11/2015		
MATERIAL		THIRD ANGLE:		THERMOCOUPLE, MS CONNECTOR, 2.16" QF/KF	
FINISH		APPLICATION			
PLATING		NEXT ASSY USED ON			
		SURFACE FINISH: 63/ OR BETTER			
		UNLESS OTHERWISE SPECIFIED:		DOWNLOADED FROM MPFPI.COM	
		ALL DIAMETERS CONCENTRIC WITHIN .005. REMOVE ALL BURRS AND SHARP EDGES		DWG. NO. A0194	
				REV	
				Tuesday, February 5, 2019 3:32:13 PM	