

MPF PRODUCTS INC.

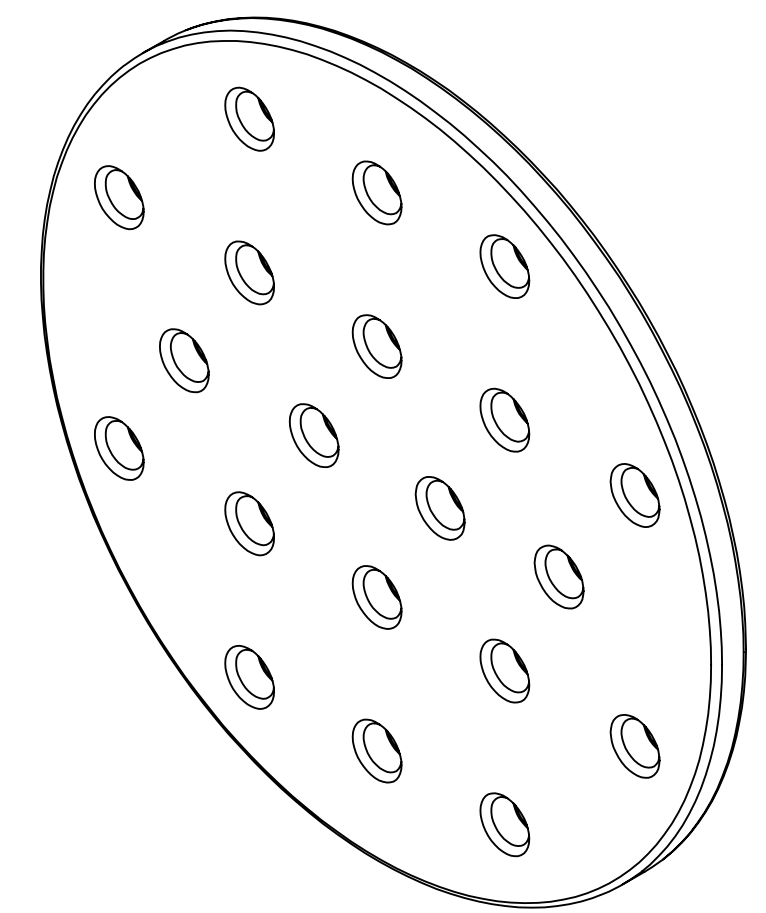
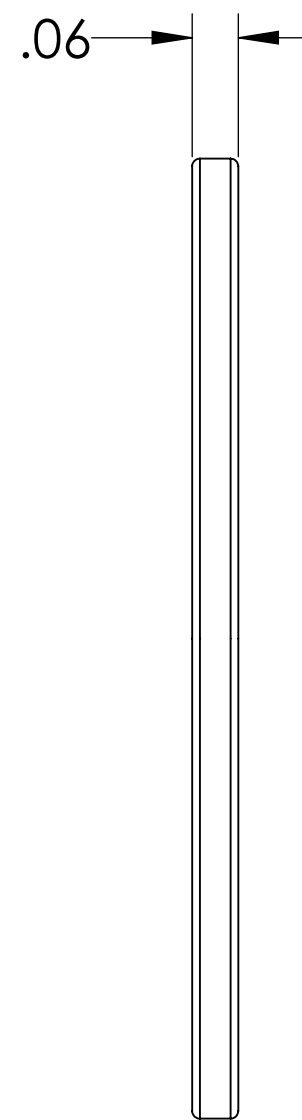
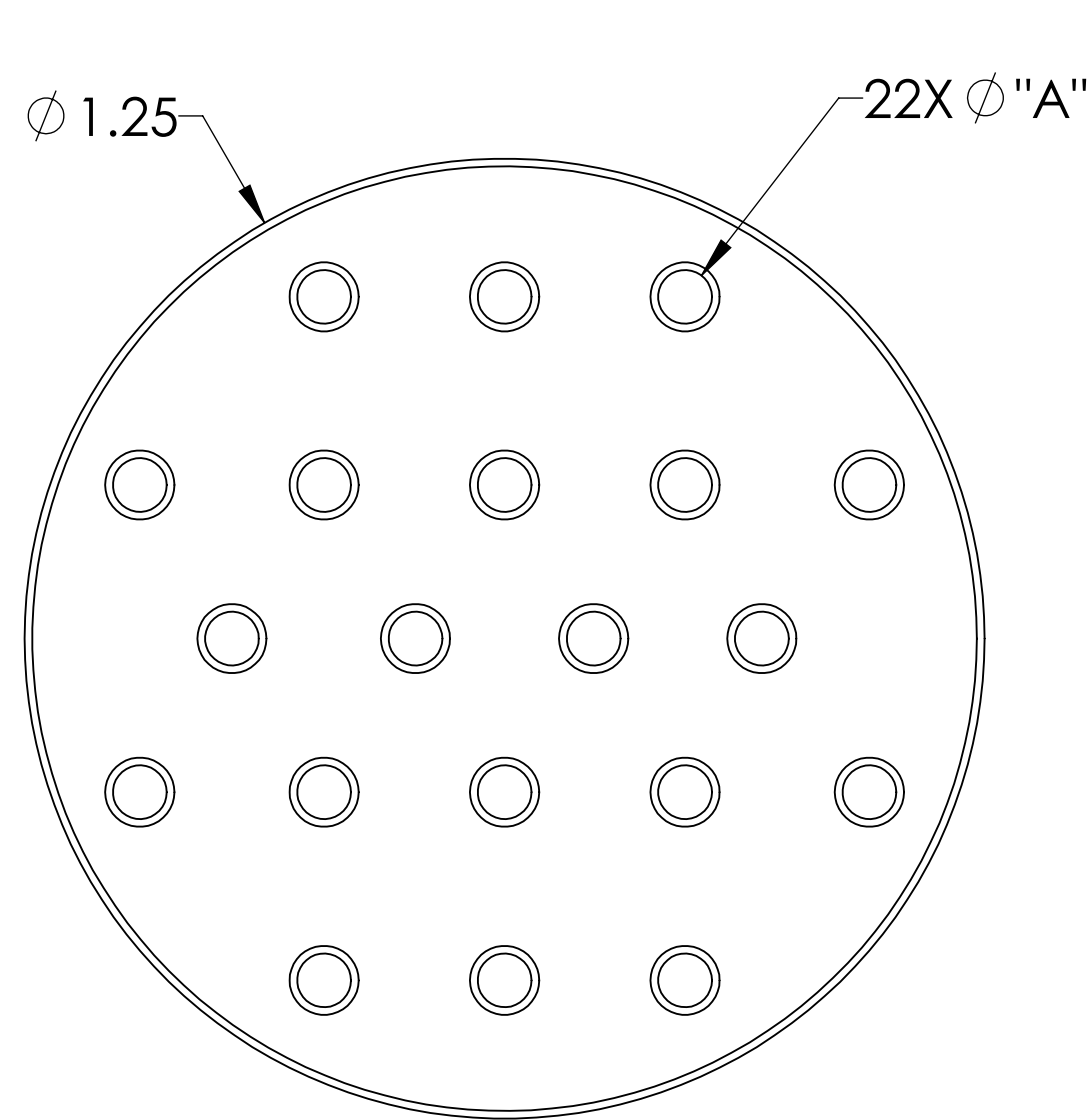

PART #	"A" ϕ THRU
A0207-1-C	.053/.057
A0207-2-C	.064/.068

UNLESS OTHERWISE SPECIFIED:		QUOTATION #		N/A	
DIMENSIONS ARE IN INCHES TOLERANCES:		NAME	DATE	MPF PRODUCTS INC.	
ANGULAR: MACH $\pm 1/2^\circ$		DRAWN	9/11/2015		
TWO PLACE DECIMAL $\pm .030$		CHECKED	9/11/2015		
THREE PLACE DECIMAL $\pm .015$		ENG APPR.	9/11/2015		
MATERIAL		THIRD ANGLE:		20 PIN SPACER	
		APPLICATION			
		NEXT ASSY	USED ON	DOWNLOADED FROM MPFPI.COM	
FINISH		SURFACE FINISH: $\sqrt{32}$ OR BETTER		DWG. NO.	REV
PLATING		UNLESS OTHERWISE SPECIFIED:		A0207	
		ALL DIAMETERS CONCENTRIC WITHIN .005. REMOVE ALL BURRS AND SHARP EDGES		Tuesday, February 12, 2019 4:27:26 PM	