

MPF PRODUCTS INC.

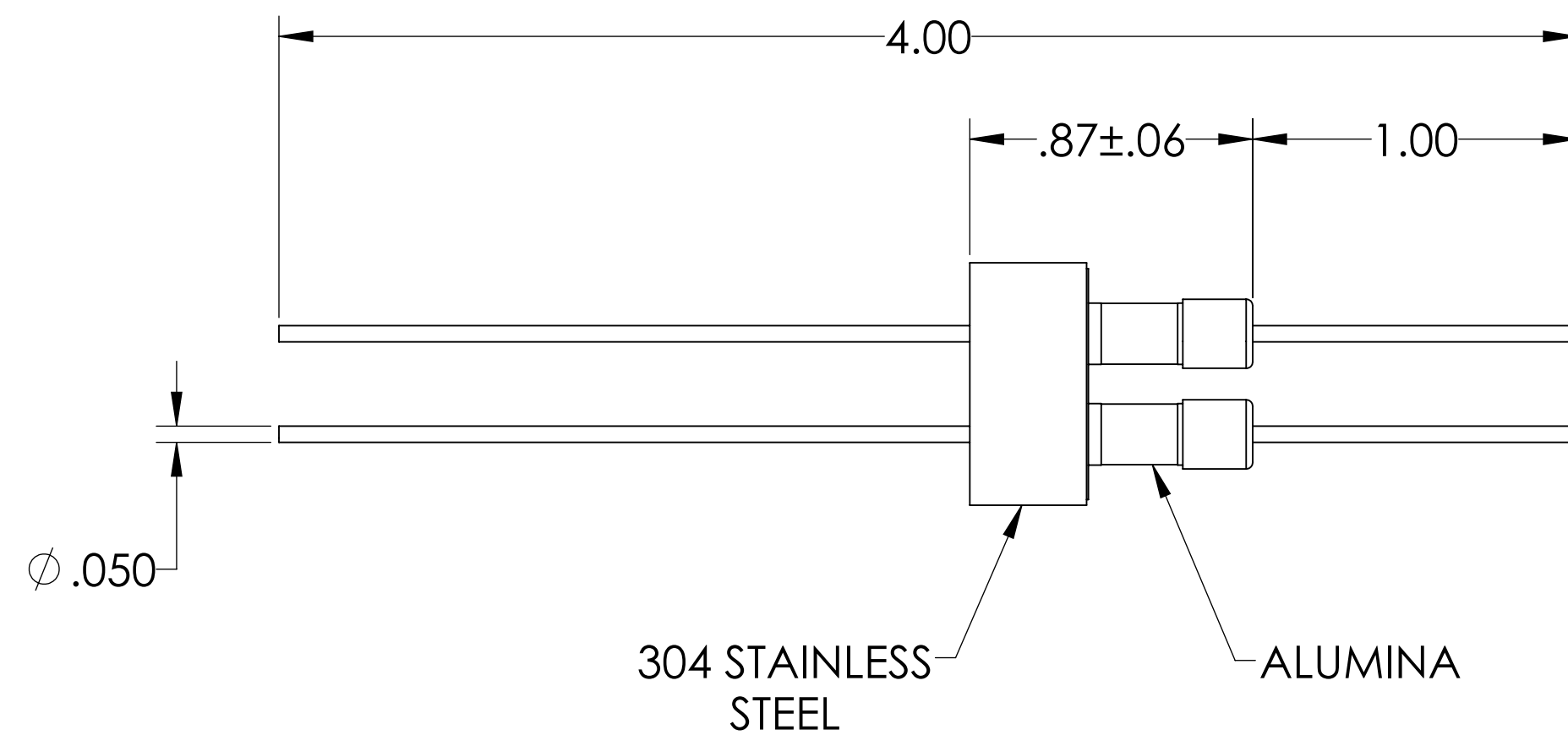
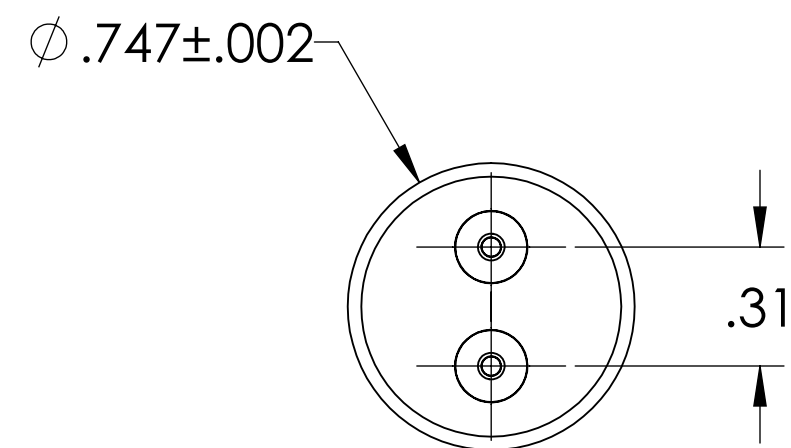
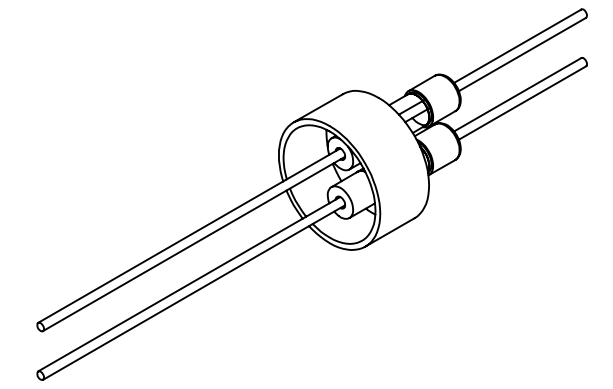

PART #	CONDUCTOR MATERIAL	CURRENT RATING
A0267-1-W	NICKEL 200	8 AMPS
A0267-2-W	304 STAINLESS STEEL	1 AMP
A0267-3-W	OFHC COPPER	25 AMPS
A0267-4-W	MOLYBDENUM	13 AMPS

NOTE:

- VOLTAGE: 500 VOLTS DC
- CURRENT: SEE TABLE
- TEMPERATURE RATING: -100 TO 450°C

Power Feedthrough, 500 Volts, 2 Pins, 0.050" Conductor, 0.747" Dia Stainless Steel Weld Adapter, UHV Rated, Bakeable to 450°C

UNLESS OTHERWISE SPECIFIED:	QUOTATION #	N/A
DIMENSIONS ARE IN INCHES TOLERANCES:	NAME	DATE
ANGULAR: MACH ± 1/2°	WJ	9/11/2015
TWO PLACE DECIMAL ± .030	CHECKED	9/11/2015
THREE PLACE DECIMAL ± .015	ENG APPR.	WJ 9/11/2015
MATERIAL	THIRD ANGLE:	
	APPLICATION	
	NEXT ASSY	USED ON
FINISH	SURFACE FINISH:	63/ OR BETTER
PLATING	UNLESS OTHERWISE SPECIFIED:	
	ALL DIAMETERS CONCENTRIC WITHIN .005. REMOVE ALL BURRS AND SHARP EDGES	
	TITLE:	MPF PRODUCTS INC.
		POWER FEEDTHROUGH, 500 VOLTS, 2 PINS, 0.747" WELD ADAPTER
	DOWNLOADED FROM MPFPI.COM	
	DWG. NO.	A0267
	REV	
	Friday, November 30, 2018 10:44:54 AM	