

MPF PRODUCTS INC.

NOTES:
* TYPE T:
CONSTANTAN CONDUCTORS HAVE A NEGATIVE POLARITY (NON - MAGNETIC) AND THE VACUUM SIDE ENDS ARE LONGER.
OFHC COPPER CONDUCTORS HAVE A POSITIVE POLARITY (NON - MAGNETIC) AND THE VACUUM SIDE ENDS ARE SHORTER.
* TYPE N:
NI-SI-MG CONDUCTORS HAVE A NEGATIVE POLARITY (NON - MAGNETIC) AND THE VACUUM SIDE ENDS ARE LONGER.
NI-CR-SI CONDUCTORS HAVE A POSITIVE POLARITY (NON - MAGNETIC) AND THE VACUUM SIDE ENDS ARE SHORTER.
* TYPE R-S:
ALLOY 11 CONDUCTORS HAVE A NEGATIVE POLARITY (NON - MAGNETIC) AND THE VACUUM SIDE ENDS ARE LONGER.
OFHC COPPER CONDUCTORS HAVE A POSITIVE POLARITY (NON - MAGNETIC) AND THE VACUUM SIDE ENDS ARE SHORTER.

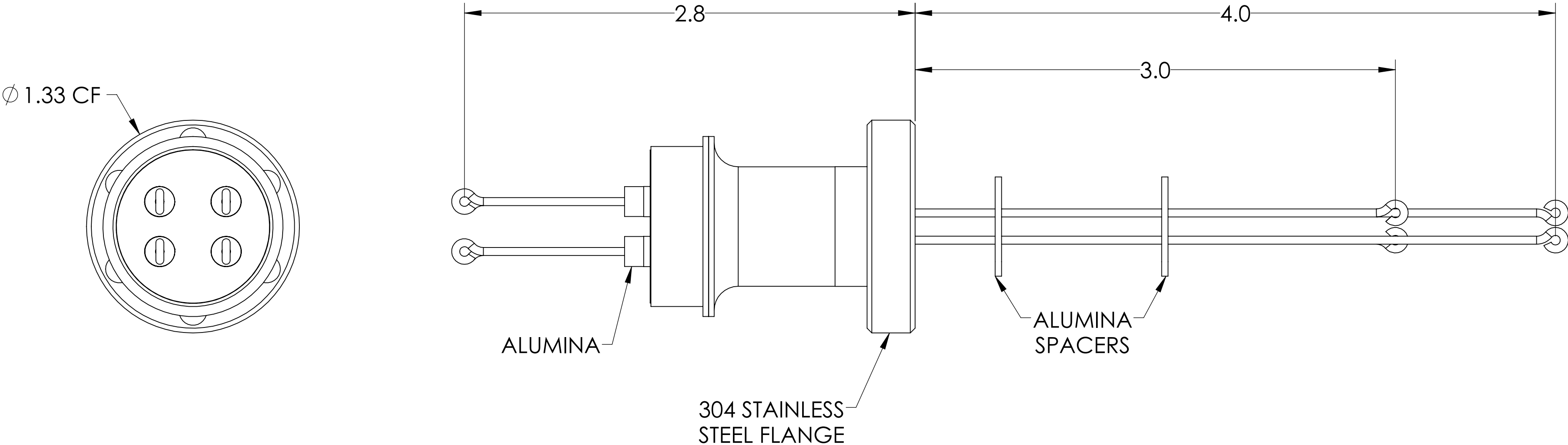
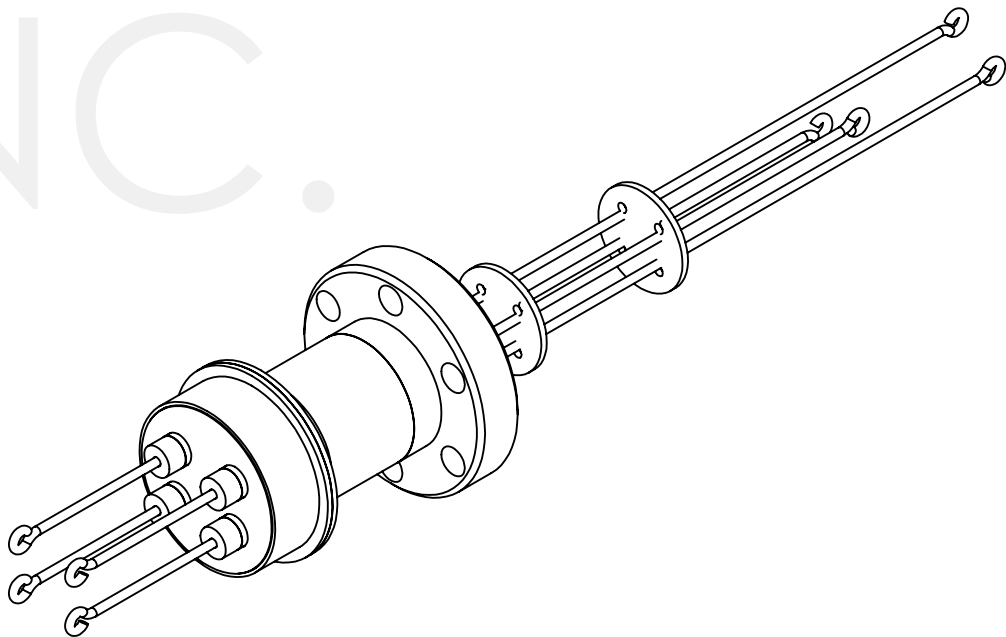

PART #	T/C TYPE
A0412-1-CF	T
A0412-2-CF	R-S
A0412-3-CF	N

SPECIFICATIONS:
1. TEMPERATURE RATING: -100 TO 450°C
2. LEAK RATE < 1X10-9 ATM CC/SEC HE

Thermocouple Feedthrough, 2 Pairs, Screw-type Connector, 1.33" Conflat Flange

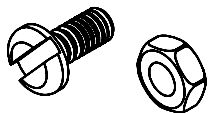

UNLESS OTHERWISE SPECIFIED: DIMENSIONS ARE IN INCHES TOLERANCES: ANGULAR: MACH ± 1/2° TWO PLACE DECIMAL ± .030 THREE PLACE DECIMAL ± .015 MATERIAL FINISH PLATING	QUOTATION # N/A			MPF PRODUCTS INC. TITLE: THERMOCOUPLE, 2 PAIRS, SCREW-TYPE, 133CF DOWNLOADED FROM MPFPI.COM DWG. NO. A0412 REV
	DRAWN	WJ	9/11/2015	
	CHECKED		9/11/2015	
	ENG APPR.	WJ	9/11/2015	
THIRD ANGLE: 				
APPLICATION NEXT ASSY USED ON				
SURFACE FINISH: 63 OR BETTER				
UNLESS OTHERWISE SPECIFIED: ALL DIAMETERS CONCENTRIC WITHIN .005. REMOVE ALL BURRS AND SHARP EDGES				Monday, August 5, 2019 9:58:35 AM