

MPF PRODUCTS INC.

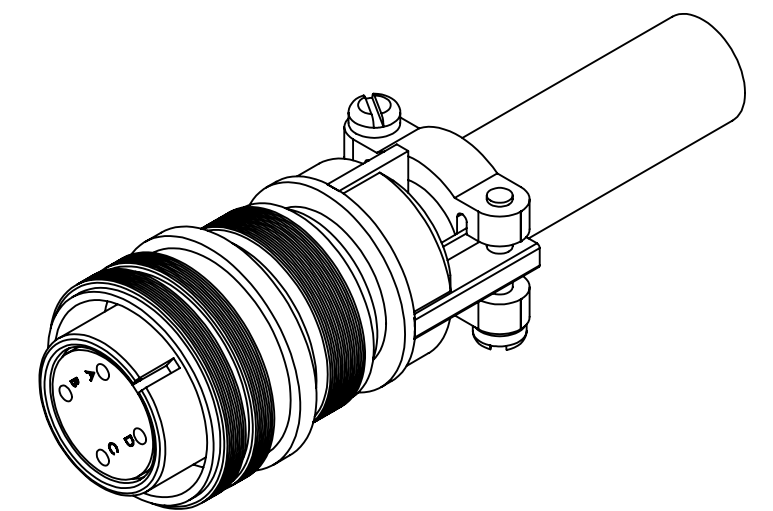
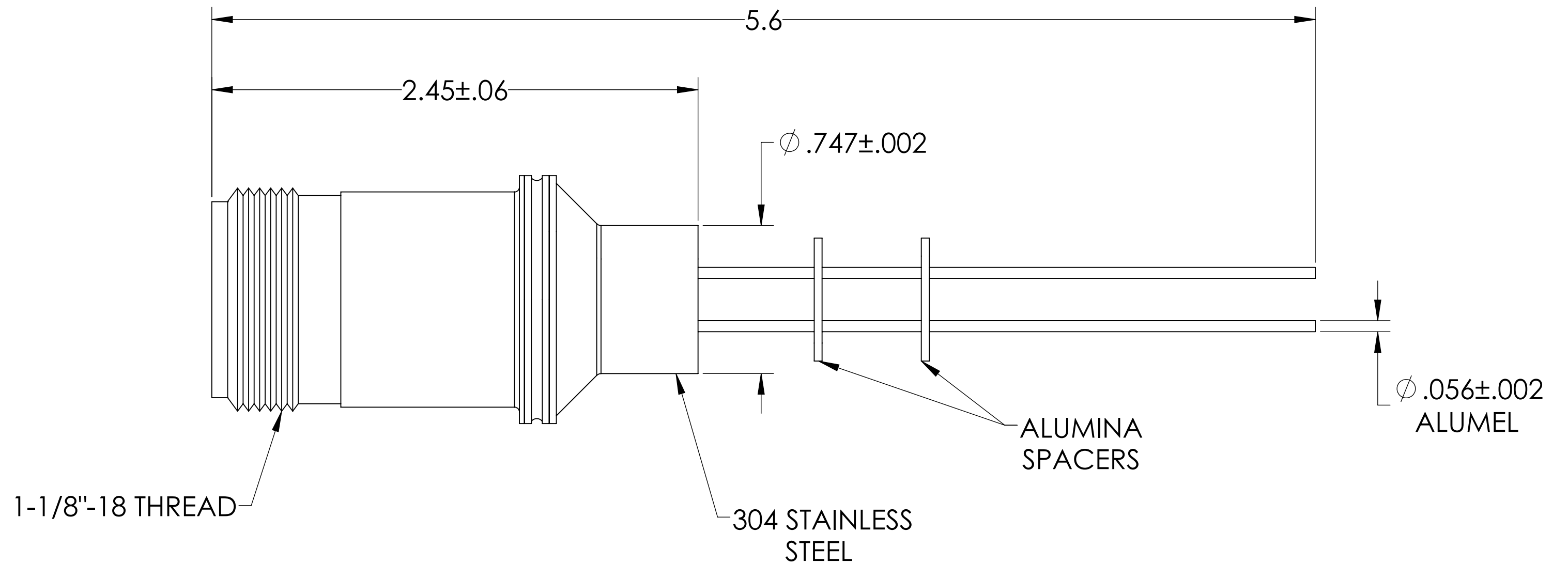
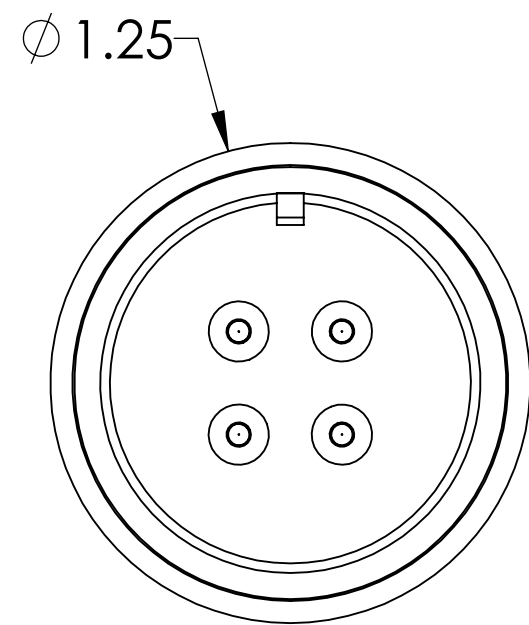
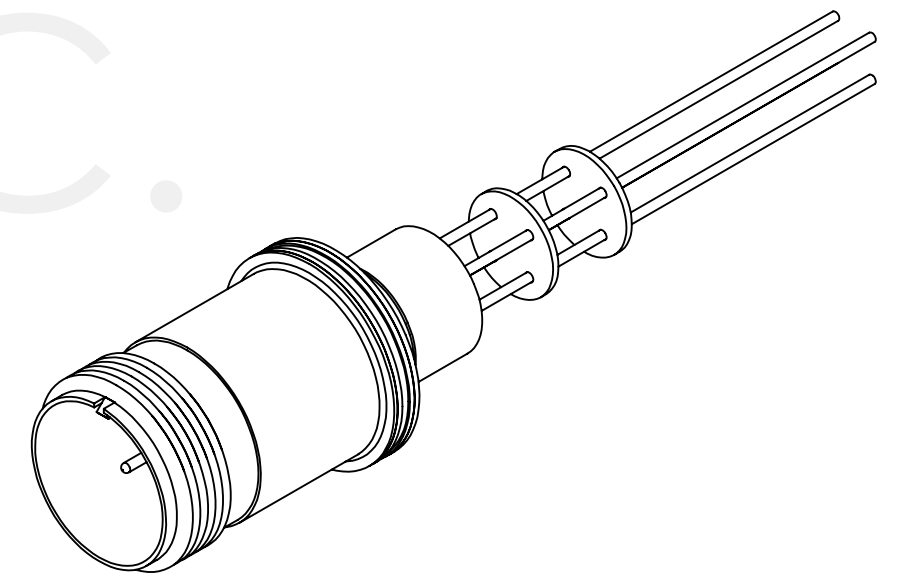

SPECIFICATIONS:

1. VOLTAGE: 700 VOLTS DC
2. CURRENT: 10 AMPS PER PIN, 28 AMPS FULL LOAD
3. TEMPERATURE RATING: -100 TO 450°C WITHOUT CONNECTOR
4. LEAK RATE < 1X10-9 ATM CC/SEC HE

MS Series, Multipin Feedthrough, 4 Pins, 700 Volts, 10 Amps per Pin, 0.056" Dia Conductors w/ Air-side Connector, 0.747" Weld Adapter

UNLESS OTHERWISE SPECIFIED:	QUOTATION #	N/A	
DIMENSIONS ARE IN INCHES TOLERANCES:	NAME	DATE	MPF PRODUCTS INC.
ANGULAR: MACH ± 1/2°	DRAWN	9/11/2015	
TWO PLACE DECIMAL ± .030	CHECKED	9/11/2015	
THREE PLACE DECIMAL ± .015	ENG APPR.	WJ 9/11/2015	
MATERIAL	THIRD ANGLE:	TITLE:	
		MULTIPIN, 4 PINS, 700V, 10A, .747" WELD ADAPTER	
FINISH	APPLICATION	DOWNLOADED FROM MPFPI.COM	
PLATING	NEXT ASSY	USED ON	DWG. NO.
	SURFACE FINISH:	63/ OR BETTER	A0429-4-W
	UNLESS OTHERWISE SPECIFIED:	REV	
	ALL DIAMETERS CONCENTRIC WITHIN .005. REMOVE ALL BURRS AND SHARP EDGES	Thursday, January 24, 2019 3:26:59 PM	