

MPF PRODUCTS INC.

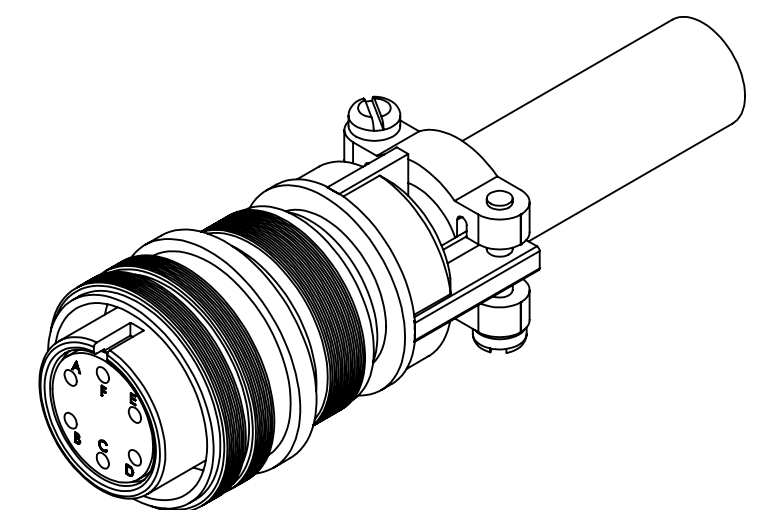
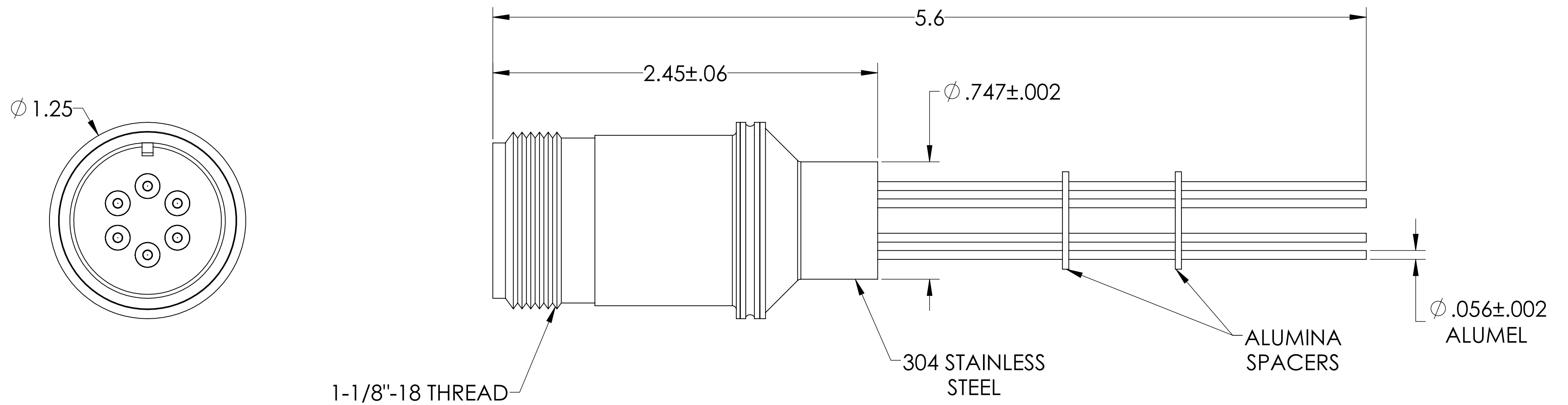
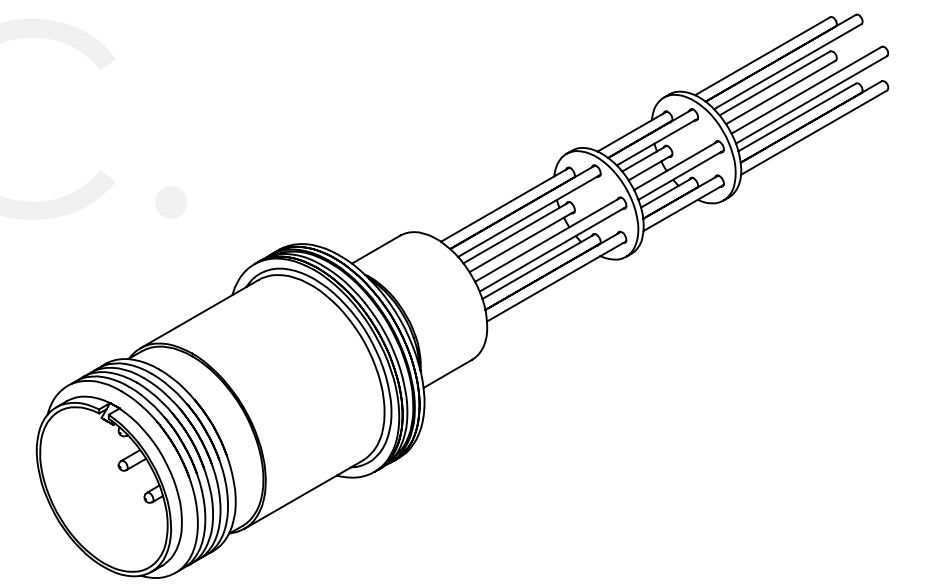

SPECIFICATIONS:

1. VOLTAGE: 700 VOLTS DC
2. CURRENT: 10 AMPS PER PIN, 36 AMPS FULL LOAD
3. TEMPERATURE RATING: -100 TO 450°C WITHOUT CONNECTOR
4. LEAK RATE <math> < 1 \times 10^{-9}</math> ATM CC/SEC HE

MS Series, Multipin Feedthrough, 6 Pins, 700 Volts, 10 Amps per Pin, 0.056" Dia Conductors w/ Air-side Connector, 0.747" Weld Adapter

UNLESS OTHERWISE SPECIFIED:		QUOTATION #		N/A	
DIMENSIONS ARE IN INCHES TOLERANCES:		NAME	DATE	MPF PRODUCTS INC.	
ANGULAR: MACH $\pm 1/2^\circ$		DRAWN	9/11/2015		
TWO PLACE DECIMAL $\pm .030$		CHECKED	9/11/2015		
THREE PLACE DECIMAL $\pm .015$		ENG APPR.	WJ 9/11/2015		
MATERIAL		THIRD ANGLE:		TITLE:	
				MULTIPIN, 6 PINS, 700V, 10A, .747" WELD ADAPTER	
FINISH		APPLICATION		DOWNLOADED FROM MPFPI.COM	
PLATING		NEXT ASSY		DWG. NO.	
		USED ON		REV	
		SURFACE FINISH: $\sqrt{63}$ OR BETTER		A0429-8-W	
		UNLESS OTHERWISE SPECIFIED:		Thursday, January 24, 2019 3:50:48 PM	
		ALL DIAMETERS CONCENTRIC WITHIN .005. REMOVE ALL BURRS AND SHARP EDGES			