

MPF PRODUCTS INC.

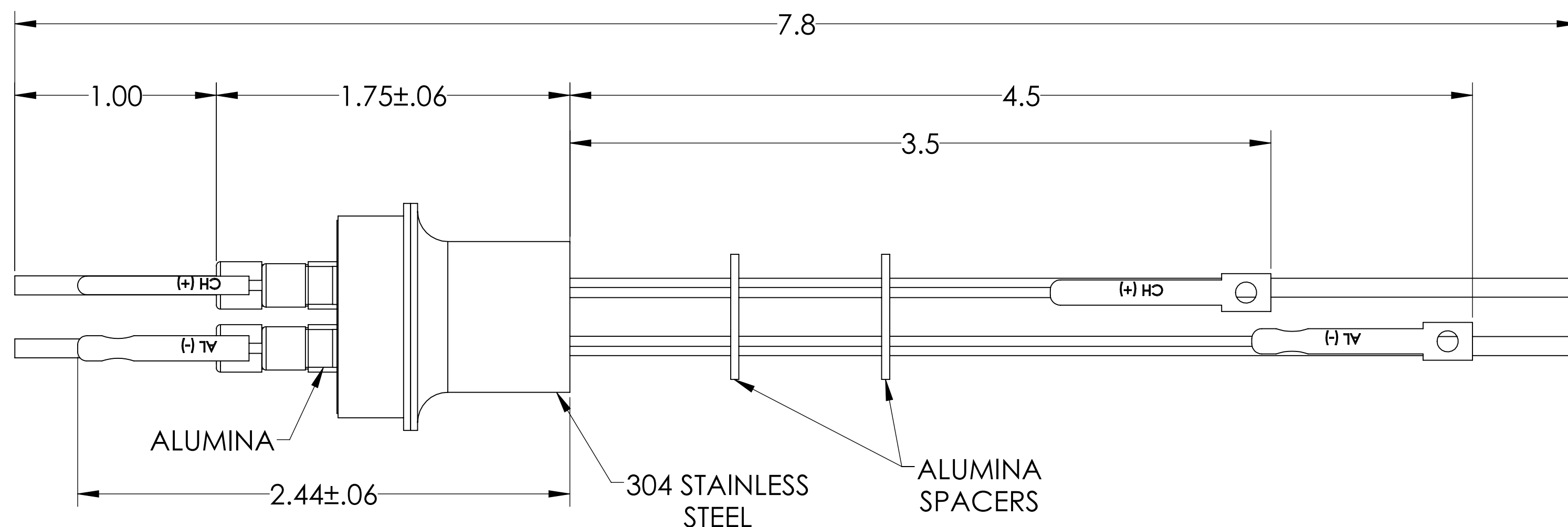
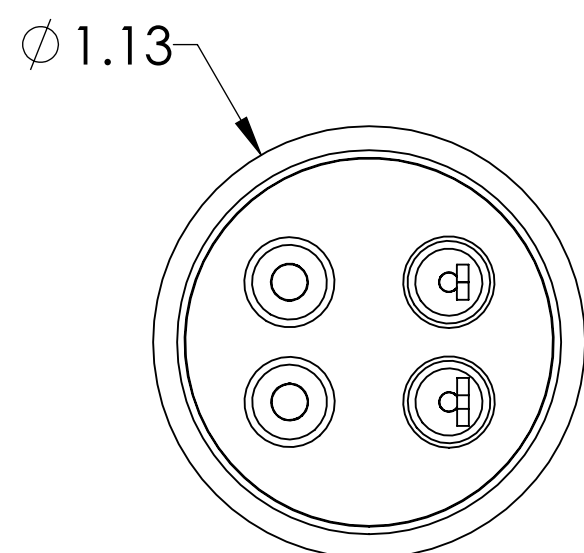
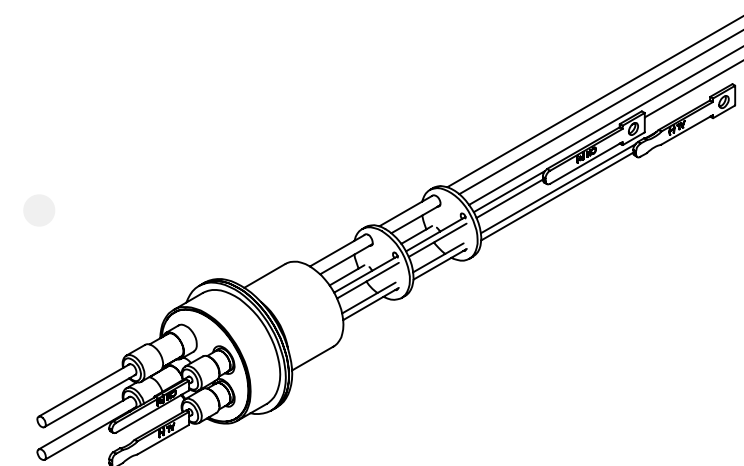

PART #	T/C TYPE	POWER LEADS	CURRENT RATINGS (POWER PINS ONLY)
A0442-1-W	K	COPPER	30 AMPS (PER PIN)
A0442-2-W	K	NICKEL	15 AMPS (PER PIN)
A0442-3-W	J	COPPER	30 AMPS (PER PIN)
A0442-4-W	J	NICKEL	15 AMPS (PER PIN)
A0442-5-W	C	COPPER	30 AMPS (PER PIN)
A0442-6-W	C	NICKEL	15 AMPS (PER PIN)
A0442-7-W	E	COPPER	30 AMPS (PER PIN)
A0442-8-W	E	NICKEL	15 AMPS (PER PIN)

SPECIFICATIONS:

- VOLTAGE: 5000 VOLTS DC
- CURRENT: SEE TABLE
- TEMPERATURE RATING: -100 TO 450°C
- LEAK RATE < 1X10-9 ATM CC/SEC HE

Thermocouple-Power Feedthrough, 1 Pair , w/ Miniature TC Connector, 5000 Volts, 2 Pins, 0.75" Stainless Steel Weld Adapter

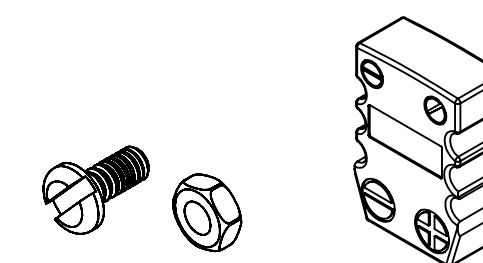

UNLESS OTHERWISE SPECIFIED:		QUOTATION #		N/A	
DIMENSIONS ARE IN INCHES TOLERANCES:		NAME	DATE	MPF PRODUCTS INC.	
ANGULAR: MACH ± 1/2°		DRAWN	9/11/2015		
TWO PLACE DECIMAL ± .030		CHECKED	9/11/2015		
THREE PLACE DECIMAL ± .015		ENG APPR.	9/11/2015		
MATERIAL		THIRD ANGLE:		THERMOCOUPLE-POWER, 1 PAIR, 5000V, 2 PINS, .747" WELD ADAPTER	
FINISH		APPLICATION			
PLATING		NEXT ASSY USED ON			
SURFACE FINISH: 63 OR BETTER		UNLESS OTHERWISE SPECIFIED:		DOWNLOADED FROM MPFPI.COM	
ALL DIAMETERS CONCENTRIC WITHIN .005. REMOVE ALL BURRS AND SHARP EDGES		DWG. NO.		REV	
		A0442		Friday, February 8, 2019 8:40:58 AM	