

MPF PRODUCTS INC.

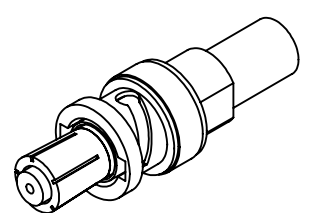
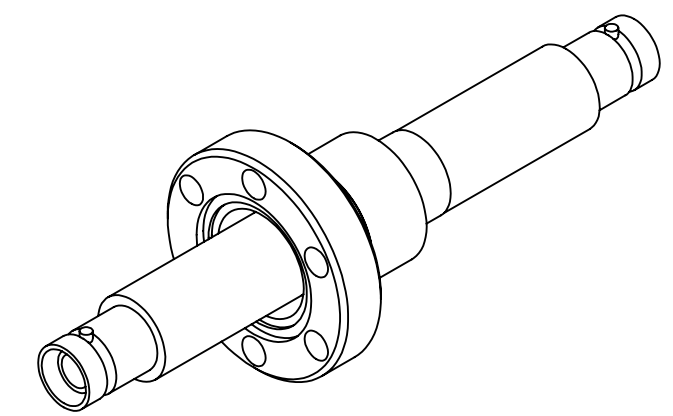
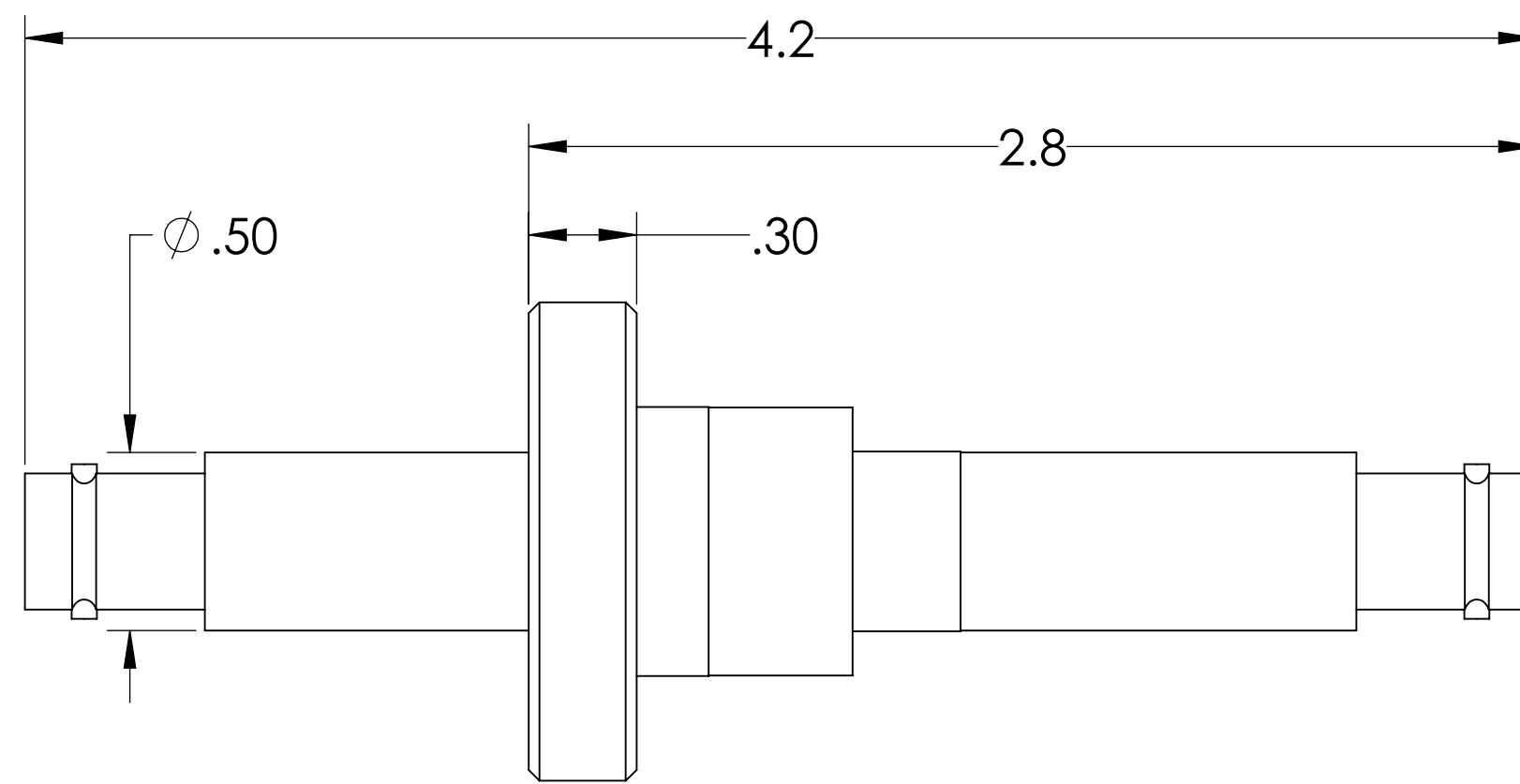
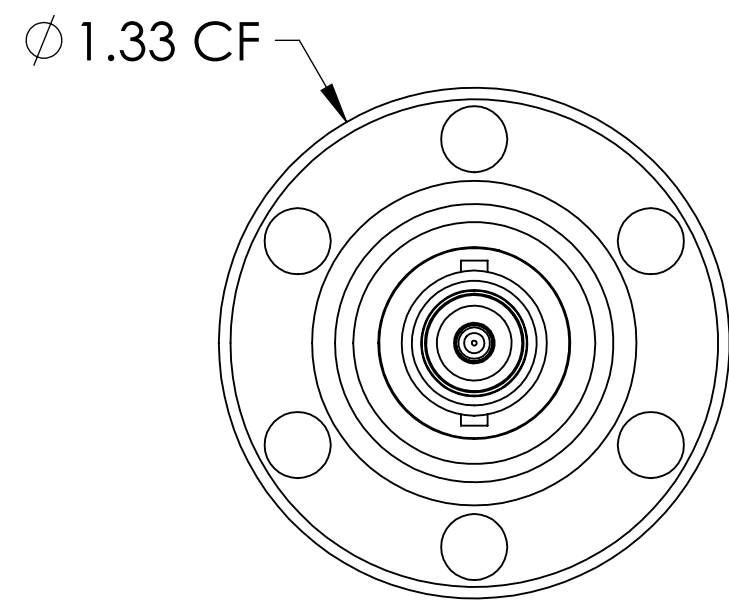

PART #	AIRSIDE CONNECTOR INCLUDED
A0472-5-CF	YES
A0472-6-CF	NO

NOTE:

1. SHIELD: GROUNDED
2. VOLTAGE: 5000 VOLTS DC
3. CURRENT: 5 AMPS
4. TEMPERATURE RATING: -200 TO 450°C (FEEDTHROUGH), 65 TO 165°C (AIRSIDE CONNECTOR)
5. IMPEDANCE: NON-CONSTANT

SHV-5 Coaxial Feedthrough, 1 Pin, Grounded Shield, Double Ended, 1.33" Conflat Flange, UHV Compatible

UNLESS OTHERWISE SPECIFIED:	QUOTATION #	N/A	
DIMENSIONS ARE IN INCHES TOLERANCES:	NAME	DATE	MPF PRODUCTS INC.
ANGULAR: MACH ± 1/2°	DRAWN	9/11/2015	
TWO PLACE DECIMAL ± .030	CHECKED	9/11/2015	
THREE PLACE DECIMAL ± .015	ENG APPR.	WJ 9/11/2015	
MATERIAL	THIRD ANGLE:	TITLE: SHV-5 COAXIAL FEEDTHROUGH, 1 PIN, GROUNDED SHIELD, DOUBLE ENDED, 1.33" CONFLAT FLANGE	
	APPLICATION	DOWNLOADED FROM MPFPI.COM	
	NEXT ASSY	USED ON	DWG. NO.
FINISH	SURFACE FINISH:	63 OR BETTER	REV
PLATING	UNLESS OTHERWISE SPECIFIED:	A0472 SHV	
	ALL DIAMETERS CONCENTRIC WITHIN .005. REMOVE ALL BURRS AND SHARP EDGES	Monday, January 21, 2019 9:18:37 AM	