

# MPF PRODUCTS INC.

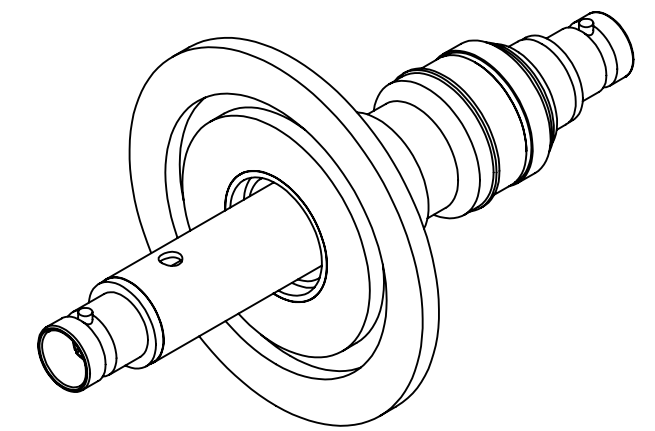
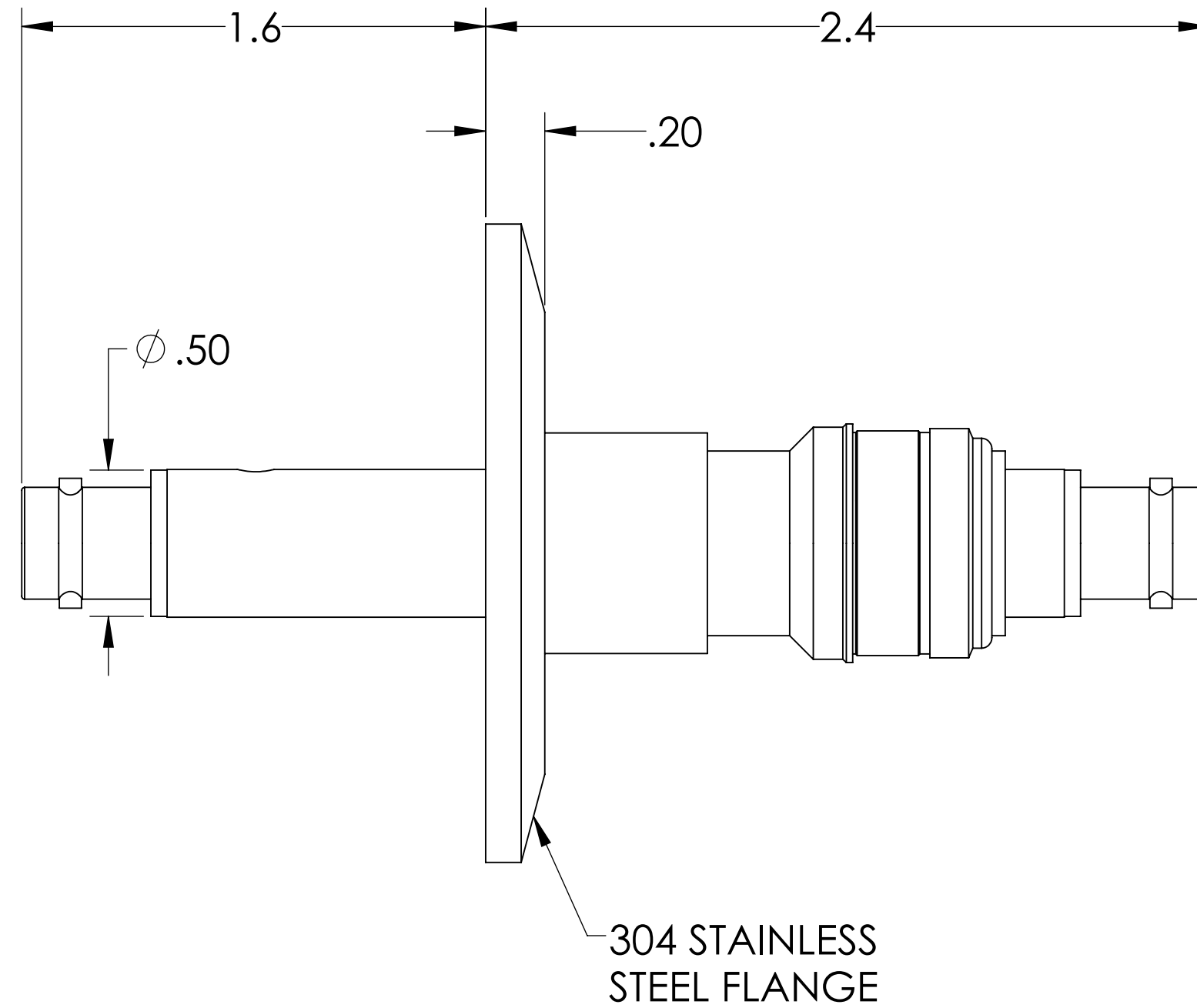
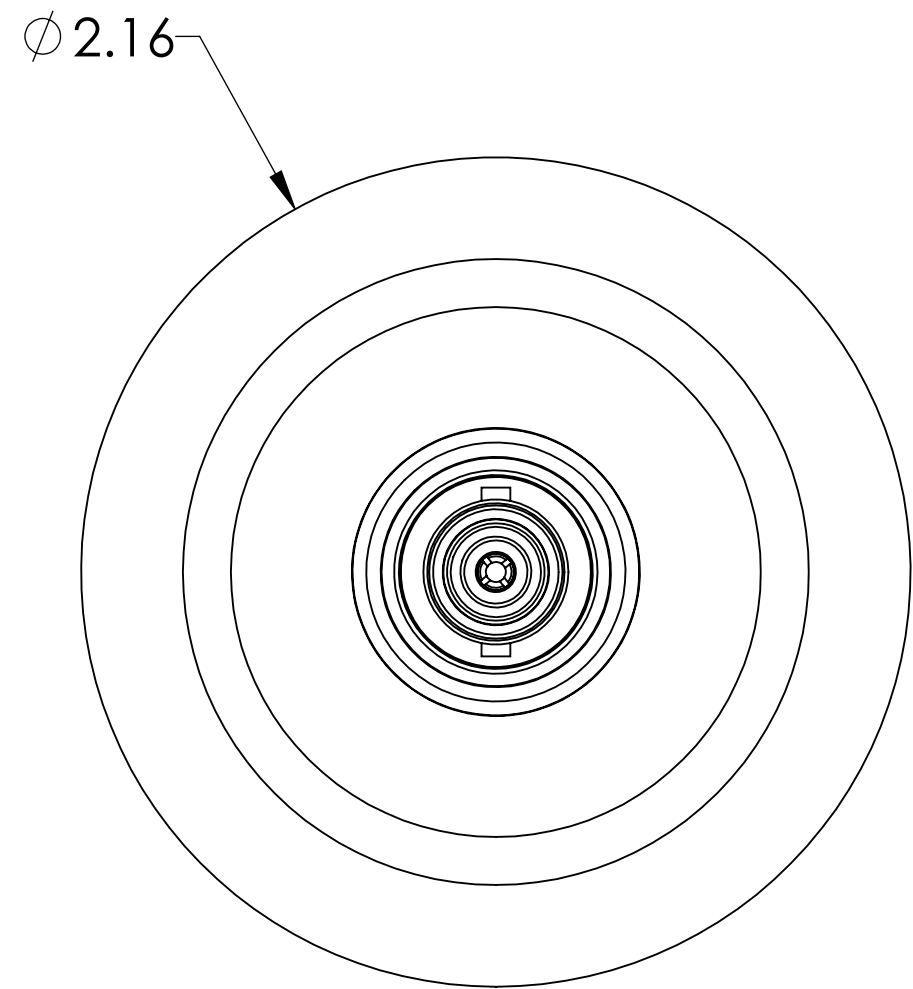

PART #	AIRSIDE CONNECTOR INCLUDED
A0481-1-QF	YES
A0481-4-QF	NO

**NOTE:**

1. SHIELD: FLOATING
2. VOLTAGE: 2500 VOLTS DC SHIELD TO GROUND, 500V PIN TO SHEILD
3. CURRENT: 3 AMPS
4. TEMPERATURE RATING: -200 TO 450°C (FEEDTHROUGH), 65 TO 165°C ( AIRSIDE CONNECTOR)
5. IMPEDANCE: NON-CONSTANT

BNC Coaxial Feedthrough, 1 Pin, Floating Shield, Double Ended, 2.16" QF/KF, UHV Compatible

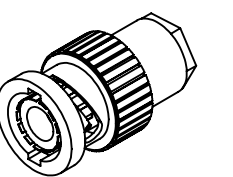

UNLESS OTHERWISE SPECIFIED:	QUOTATION #	N/A					
DIMENSIONS ARE IN INCHES TOLERANCES:	DRAWN	NAME	DATE				
ANGULAR: MACH ± 1/2°	WJ	WJ	9/11/2015				
TWO PLACE DECIMAL ± .030	CHECKED		9/11/2015				
THREE PLACE DECIMAL ± .015	ENG APPR.	WJ	9/11/2015				
MATERIAL	THIRD ANGLE:						
FINISH	APPLICATION	<table border="1"> <tr> <th>NEXT ASSY</th> <th>USED ON</th> </tr> <tr> <td> </td> <td> </td> </tr> </table>		NEXT ASSY	USED ON		
NEXT ASSY	USED ON						
PLATING	SURFACE FINISH:	<table border="1"> <tr> <td>63</td> <td>OR BETTER</td> </tr> </table>		63	OR BETTER		
63	OR BETTER						
	UNLESS OTHERWISE SPECIFIED:	<table border="1"> <tr> <td>ALL DIAMETERS CONCENTRIC WITHIN .005.</td> <td>REMOVE ALL BURRS AND SHARP EDGES</td> </tr> </table>		ALL DIAMETERS CONCENTRIC WITHIN .005.	REMOVE ALL BURRS AND SHARP EDGES		
ALL DIAMETERS CONCENTRIC WITHIN .005.	REMOVE ALL BURRS AND SHARP EDGES						
	TITLE:	<b>MPF PRODUCTS INC.</b> BNC COAXIAL FEEDTHROUGH, 1 PIN, FLOATING SHIELD, DOUBLE ENDED, 2.16" QF/KF					
	DWG. NO.	A0481	BNC				
	REV						
	DATE:	Friday, January 18, 2019 8:03:47 AM					