

MPF PRODUCTS INC.

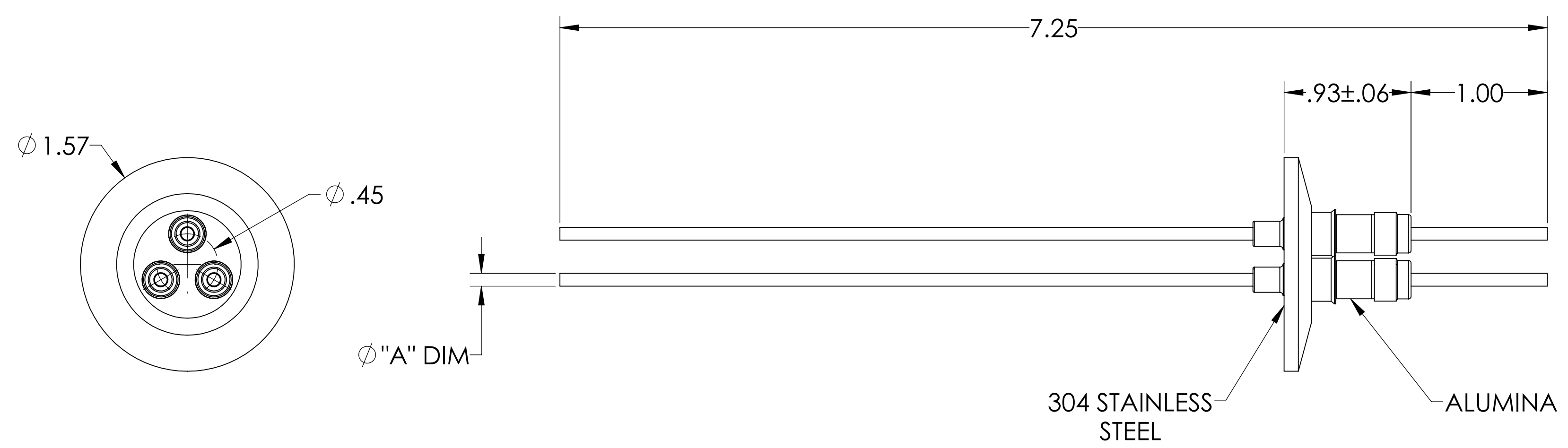
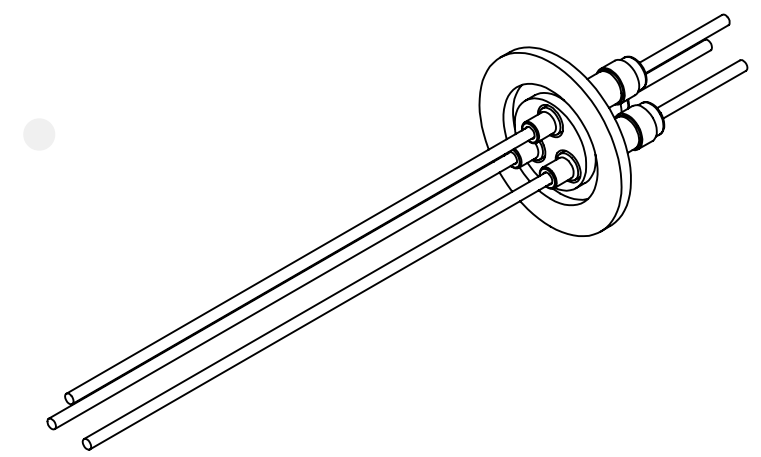

PART #	Ø "A" DIM	CONDUCTOR MATERIAL	CURRENT RATING
A0514-1-QF	.092	NICKEL 200	15 AMPS
A0514-2-QF	.094	OFHC COPPER	50 AMPS
A0514-7-QF	.092	MOLYBDENUM	28 AMPS

- NOTE:
1. VOLTAGE: 5,000 VOLTS DC
 2. CURRENT: SEE TABLE
 3. TEMPERATURE RATING: -100 TO 450°C

Power Feedthrough, 5,000 Volts, 3 Pins, 1.57" QF/KF, UHV Rated, Bakeable to 450°C

UNLESS OTHERWISE SPECIFIED:		QUOTATION #		N/A	
DIMENSIONS ARE IN INCHES TOLERANCES:		NAME	DATE	MPF PRODUCTS INC.	
ANGULAR: MACH ± 1/2"		DRAWN	9/11/2015		
TWO PLACE DECIMAL ± .030		CHECKED	9/11/2015		
THREE PLACE DECIMAL ± .015		ENG APPR.	9/11/2015		
MATERIAL		THIRD ANGLE:		POWER FEEDTHROUGH, 5000 VOLTS, 3 PINS, 1.57" QF/KF	
		APPLICATION			
		NEXT ASSY	USED ON		
FINISH		SURFACE FINISH: 63 OR BETTER		DOWNLOADED FROM MPFPI.COM	
PLATING		UNLESS OTHERWISE SPECIFIED:		DWG. NO. A0514	
		ALL DIAMETERS CONCENTRIC WITHIN .005. REMOVE ALL BURRS AND SHARP EDGES		REV.	
				Wednesday, December 5, 2018 12:42:35 PM	