

MPF PRODUCTS INC.

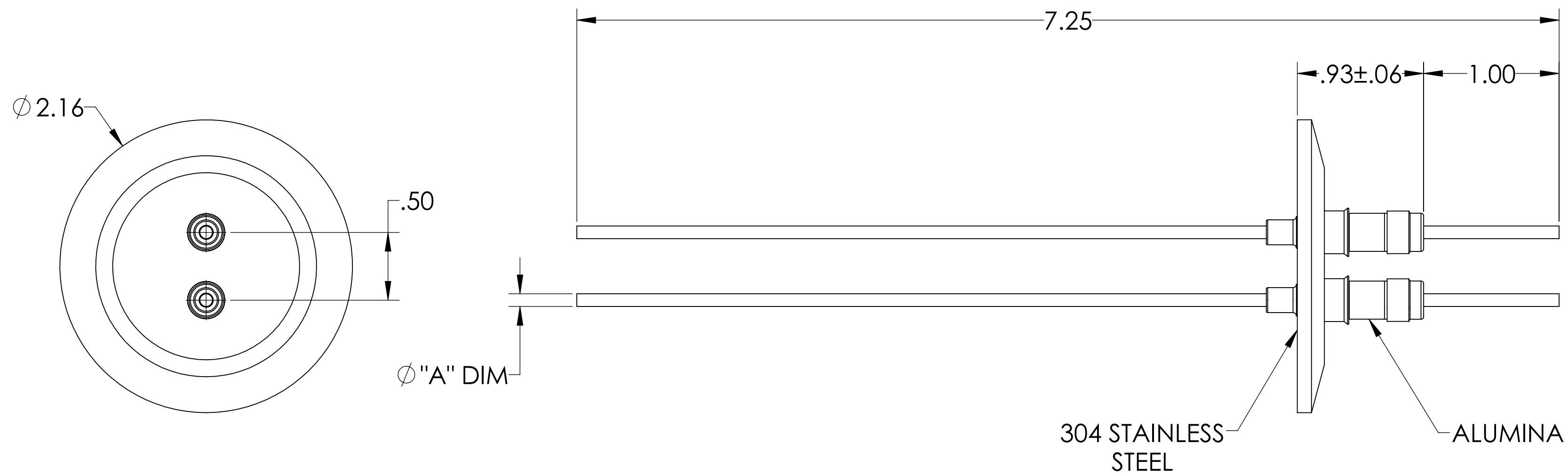
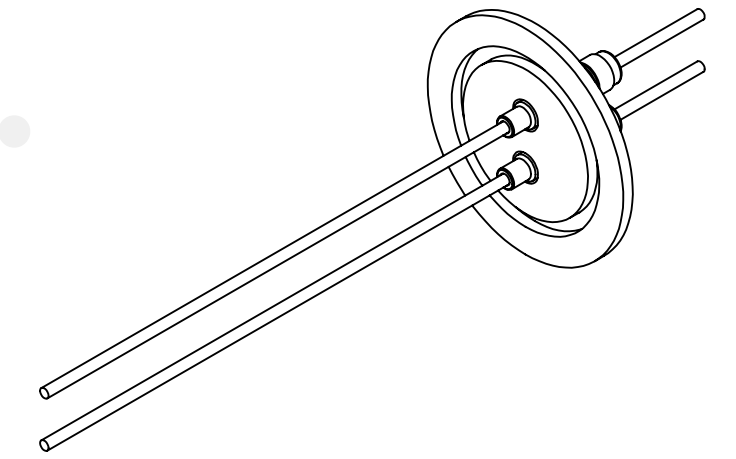

PART #	Ø "A" DIM	CONDUCTOR MATERIAL	CURRENT RATING
A0515-1-QF	.092	NICKEL 200	15 AMPS
A0515-2-QF	.094	OFHC COPPER	50 AMPS
A0515-7-QF	.092	MOLYBDENUM	28 AMPS

NOTE:

1. VOLTAGE: 5,000 VOLTS DC
2. CURRENT: SEE TABLE
3. TEMPERATURE RATING: -100 TO 450°C

Power Feedthrough, 5,000 Volts, 2 Pins, 2.16" QF/KF, UHV Rated, Bakeable to 450°C

UNLESS OTHERWISE SPECIFIED:		QUOTATION #		N/A	
DIMENSIONS ARE IN INCHES TOLERANCES:		NAME	DATE	MPF PRODUCTS INC. TITLE: POWER FEEDTHROUGH, 5000 VOLTS, 2 PINS, 2.16" QF/KF	
ANGULAR: MACH ± 1/2"		DRAWN	9/11/2015		
TWO PLACE DECIMAL ± .030		CHECKED	9/11/2015		
THREE PLACE DECIMAL ± .015		ENG APPR.	WJ 9/11/2015		
MATERIAL		THIRD ANGLE:		DWG. NO. A0515 REV. DOWNLOADED FROM MPFPI.COM	
FINISH					
PLATING		APPLICATION: NEXT ASSY USED ON			
SURFACE FINISH:		63/ OR BETTER		DWG. NO. A0515 REV. Wednesday, December 5, 2018 12:42:44 PM	
UNLESS OTHERWISE SPECIFIED:		ALL DIAMETERS CONCENTRIC WITHIN .005. REMOVE ALL BURRS AND SHARP EDGES			