

# MPF PRODUCTS INC.

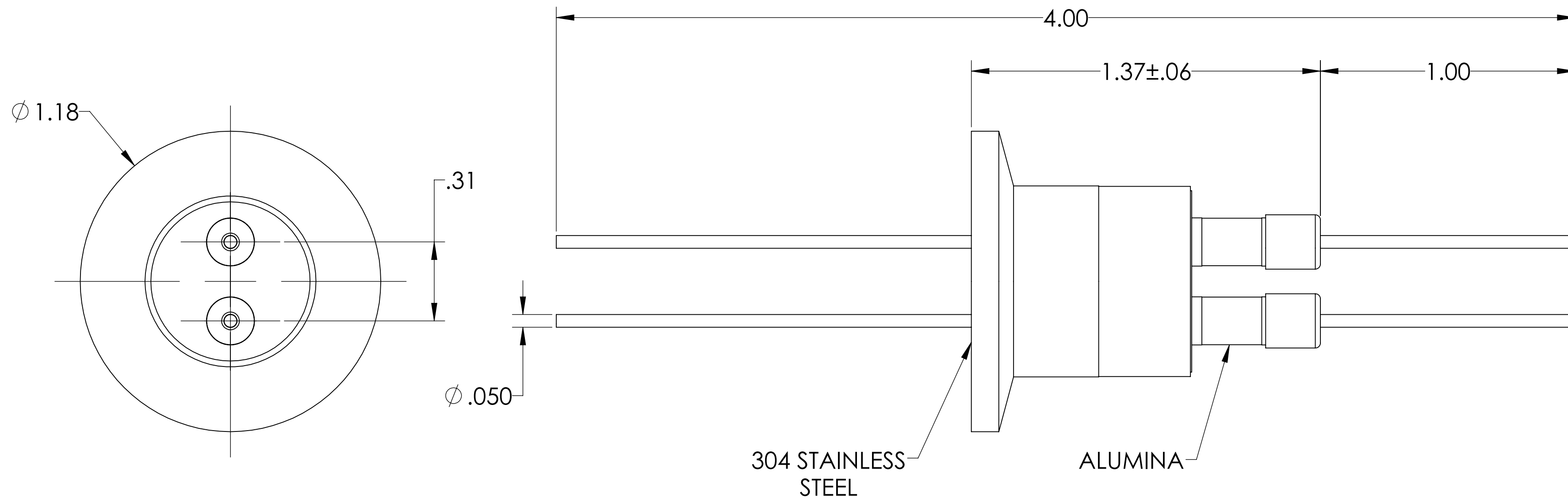
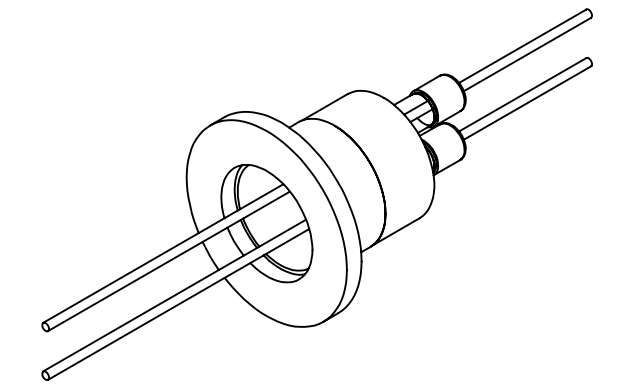

PART #	CONDUCTOR MATERIAL	CURRENT RATING
A0534-1-QF	NICKEL 200	8 AMPS
A0534-2-QF	304 STAINLESS STEEL	1 AMP
A0534-3-QF	OFHC COPPER	25 AMPS
A0534-4-QF	MOLYBDENUM	13 AMPS

**NOTE:**

1. VOLTAGE: 5000 VOLTS DC
2. CURRENT: SEE TABLE
3. TEMPERATURE RATING: -100 TO 450°C

Power Feedthrough, 5000 Volts, 2 Pins, 0.050" Conductor, 1.18" QF/KF, UHV Rated, Bakeable to 450°C

UNLESS OTHERWISE SPECIFIED:	QUOTATION #	N/A
DIMENSIONS ARE IN INCHES TOLERANCES:	NAME	DATE
ANGULAR: MACH ± 1/2°	DRAWN	9/11/2015
TWO PLACE DECIMAL ± .030	CHECKED	9/11/2015
THREE PLACE DECIMAL ± .015	ENG APPR.	WJ 9/11/2015
MATERIAL	THIRD ANGLE:	
FINISH	APPLICATION	
PLATING	NEXT ASSY USED ON	
	SURFACE FINISH:	63 OR BETTER
	UNLESS OTHERWISE SPECIFIED:	
	ALL DIAMETERS CONCENTRIC WITHIN .005. REMOVE ALL BURRS AND SHARP EDGES	
	TITLE: <b>POWER FEEDTHROUGH,                  5000 VOLTS, 2 PINS,                  1.18" QF/KF</b>	
	DWG. NO. <b>A0534</b>	
	Thursday, December 6, 2018 4:12:31 PM	