

MPF PRODUCTS INC.

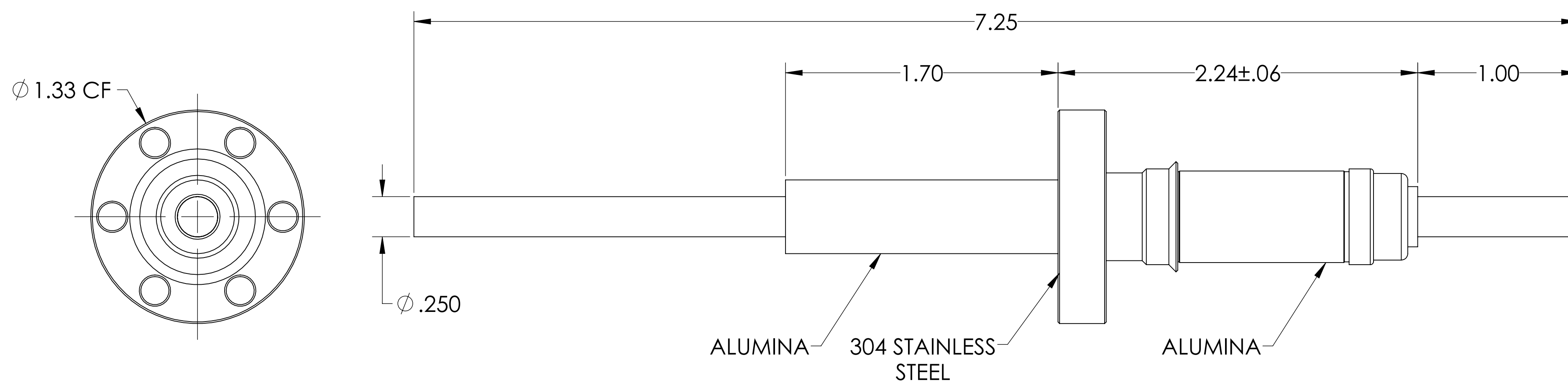
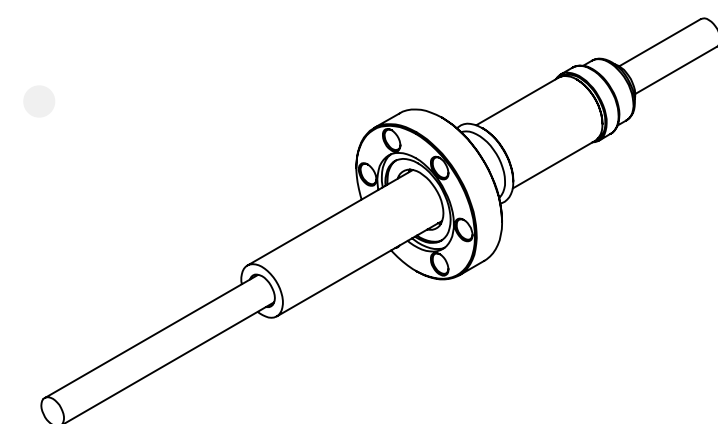

PART #	CONDUCTOR MATERIAL	CURRENT RATING
A0549-1-CF	OFHC COPPER	180 AMPS
A0549-2-CF	304 STN STL	7 AMPS
A0549-3-CF	NICKEL 200	55 AMPS

- NOTE:
- VOLTAGE: 12,000 VOLTS DC
 - CURRENT: SEE TABLE
 - TEMPERATURE RATING: -100 TO 450°C

Power Feedthrough, 12 KV, 1 Pin, 0.250" Conductor, 1.33" Conflat Flange, UHV Rated, Bakeable to 450°C

UNLESS OTHERWISE SPECIFIED:	QUOTATION #	N/A
DIMENSIONS ARE IN INCHES TOLERANCES:	NAME	DATE
ANGULAR: MACH ± 1/2°	DRAWN	9/11/2015
TWO PLACE DECIMAL ± .030	CHECKED	9/11/2015
THREE PLACE DECIMAL ± .015	ENG APPR.	WJ 9/11/2015
MATERIAL	THIRD ANGLE:	
FINISH	APPLICATION	
PLATING	NEXT ASSY USED ON	
	SURFACE FINISH:	63 OR BETTER
	UNLESS OTHERWISE SPECIFIED:	
	ALL DIAMETERS CONCENTRIC WITHIN .005.	REMOVE ALL BURRS AND SHARP EDGES
	TITLE: POWER FEEDTHROUGH, 12 KV, 1 PIN, 1.33" CONFLAT FLANGE	
	DWG. NO. A0549	
	Friday, August 16, 2019 8:02:41 AM	