

MPF PRODUCTS INC.

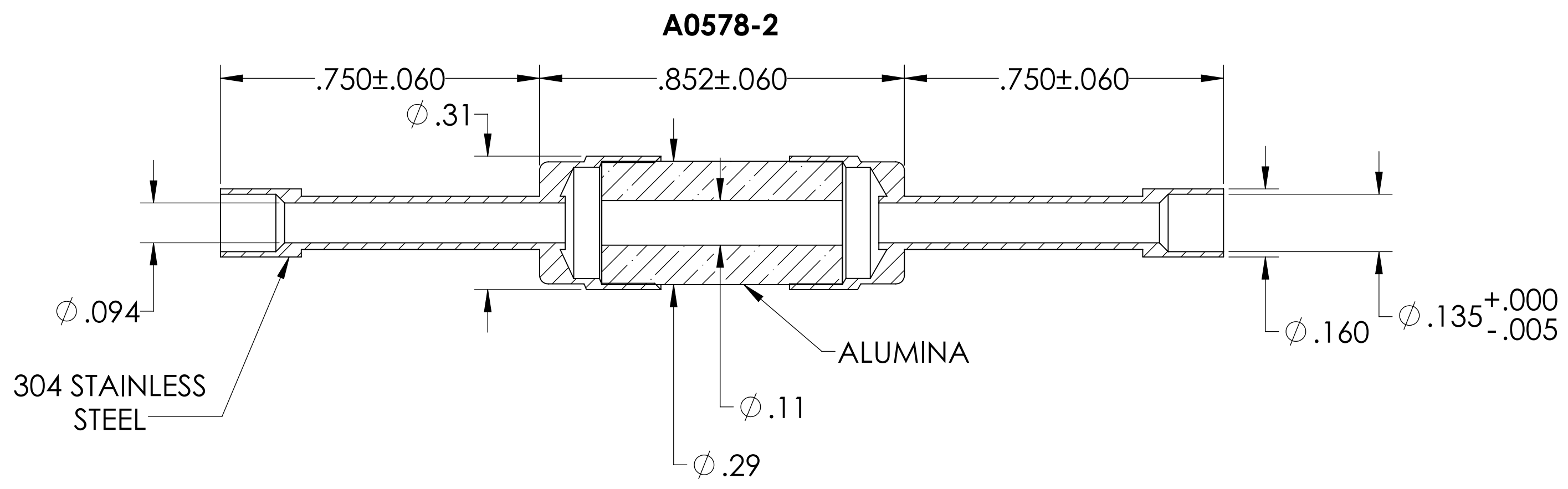
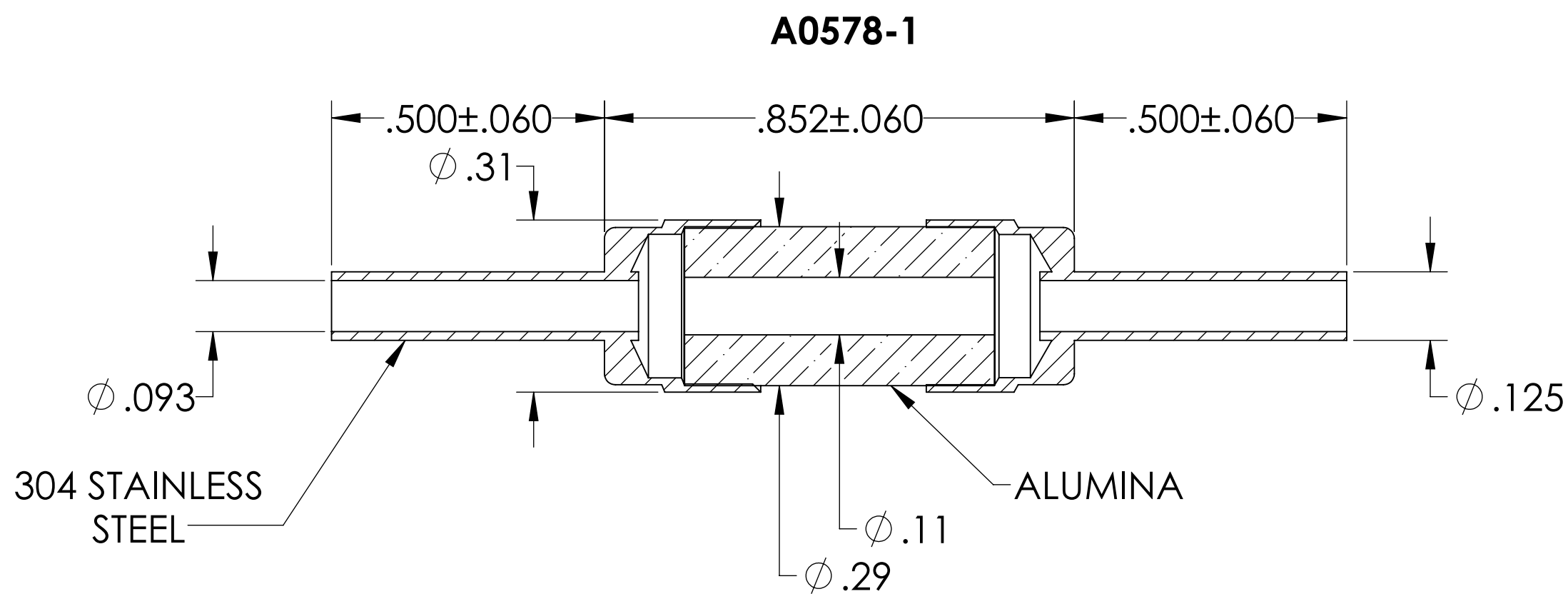
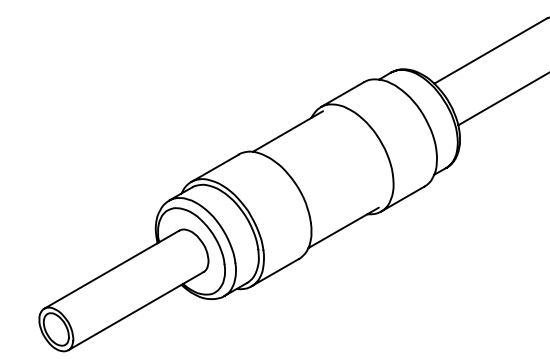

SPECIFICATIONS:

1. VOLTAGE: 5KV
2. TEMPERATURE: -200°C TO 450°C
3. LEAK RATE < 1X10-9 ATM CC/SEC HE

Break, 5KV Isolation, Stainless Steel Tube Adapters, High Voltage Isolation, Thermal Isolation, Weldable Tube Ends, UHV Compatible

UNLESS OTHERWISE SPECIFIED:	QUOTATION #	N/A	
DIMENSIONS ARE IN INCHES	DRAWN	NAME	DATE
TOLERANCES:	WJ	WJ	9/11/2015
ANGULAR: MACH ± 1/2°	CHECKED		9/11/2015
TWO PLACE DECIMAL ± .030	ENG APPR.	WJ	9/11/2015
THREE PLACE DECIMAL ± .015	THIRD ANGLE:		
MATERIAL	APPLICATION		
	NEXT ASSY	USED ON	
FINISH	SURFACE FINISH:	63	OR BETTER
PLATING	UNLESS OTHERWISE SPECIFIED:	ALL DIAMETERS CONCENTRIC WITHIN .005. REMOVE ALL BURRS AND SHARP EDGES	
	TITLE:	BREAK, 5KV ISOLATION, DIA STAINLESS STEEL TUBE ADAPTERS	
	DOWNLOADED FROM MPFPI.COM	DWG. NO.	REV
		A0578	
	Thursday, January 24, 2019 9:24:26 AM		