

# MPF PRODUCTS INC.

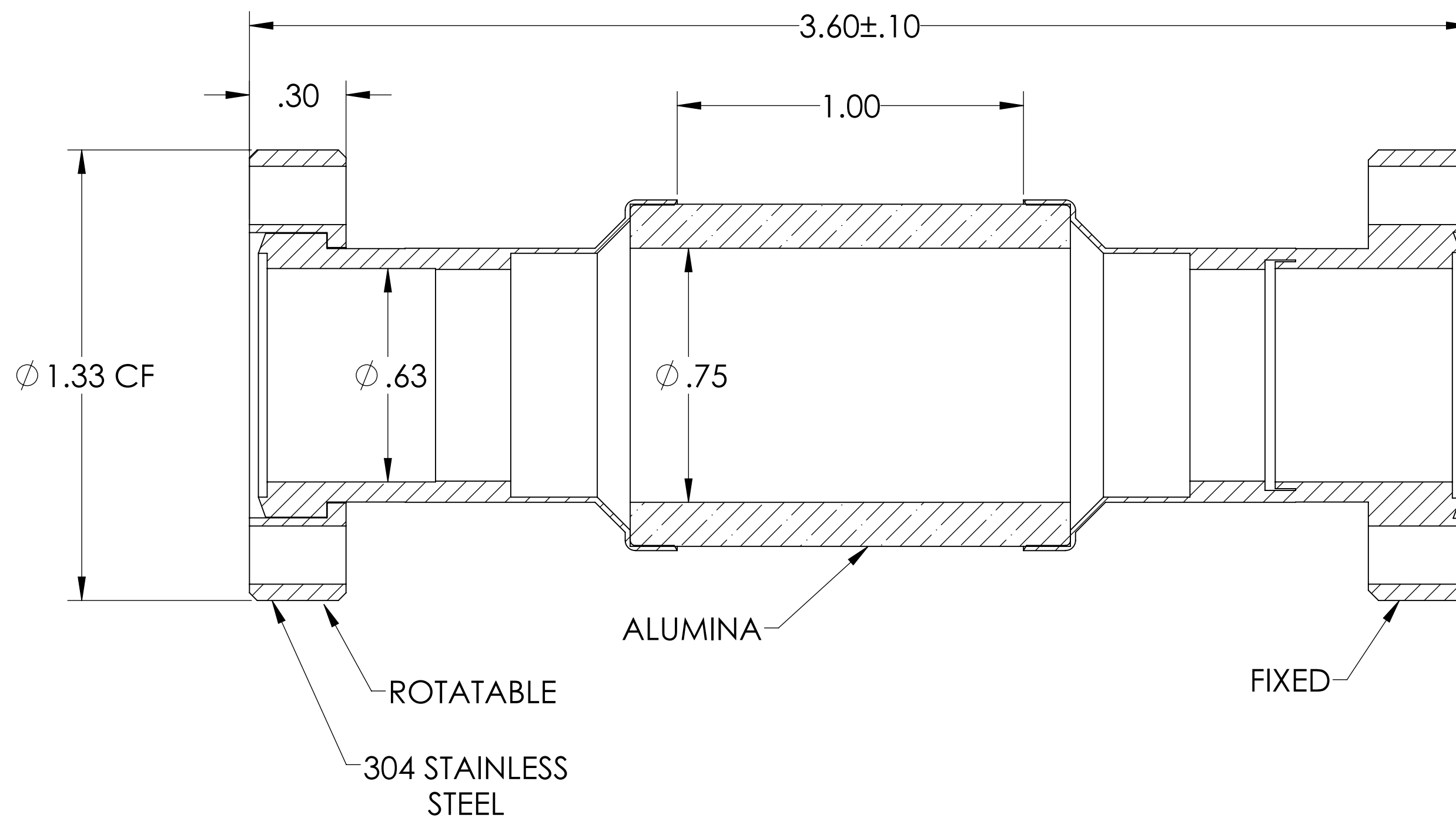
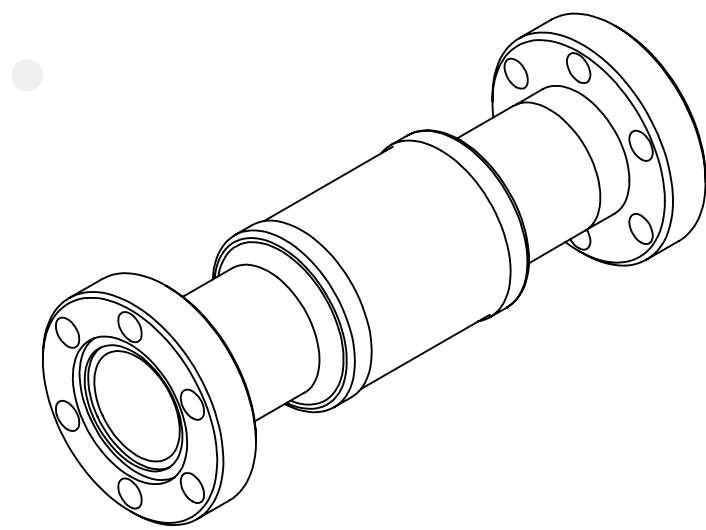

**SPECIFICATIONS:**

1. VOLTAGE: 15KV
2. TEMPERATURE: -200°C TO 450°C
3. LEAK RATE < 1X10<sup>-9</sup> ATM CC/SEC HE

Break, 15KV Isolation, 0.63" Inner Dia, 1.33" Conflat Flange, High Voltage Isolation, Thermal Isolation, Rotatable Conflat Flange, UHV Compatible

UNLESS OTHERWISE SPECIFIED:	QUOTATION #		N/A
DIMENSIONS ARE IN INCHES	NAME	DATE	MPF PRODUCTS INC.
TOLERANCES:	WJ	9/11/2015	
ANGULAR: MACH ± 1/2°	CHECKED	9/11/2015	
TWO PLACE DECIMAL ± .030	ENG APPR.	WJ 9/11/2015	
THREE PLACE DECIMAL ± .015	THIRD ANGLE:		TITLE: BREAK, 15KV ISOLATION, 0.63" INNER DIA, 1.33" CONFLAT FLANGE
MATERIAL			
FINISH	APPLICATION	NEXT ASSY	USED ON
PLATING	SURFACE FINISH: 63/ OR BETTER		UNLESS OTHERWISE SPECIFIED:
ALL DIAMETERS CONCENTRIC WITHIN .005. REMOVE ALL BURRS AND SHARP EDGES			DOWNLOADED FROM MPFPI.COM
			DWG. NO. A0585-1-CF
			REV.
			Thursday, January 24, 2019 9:23:22 AM