

MPF PRODUCTS INC.

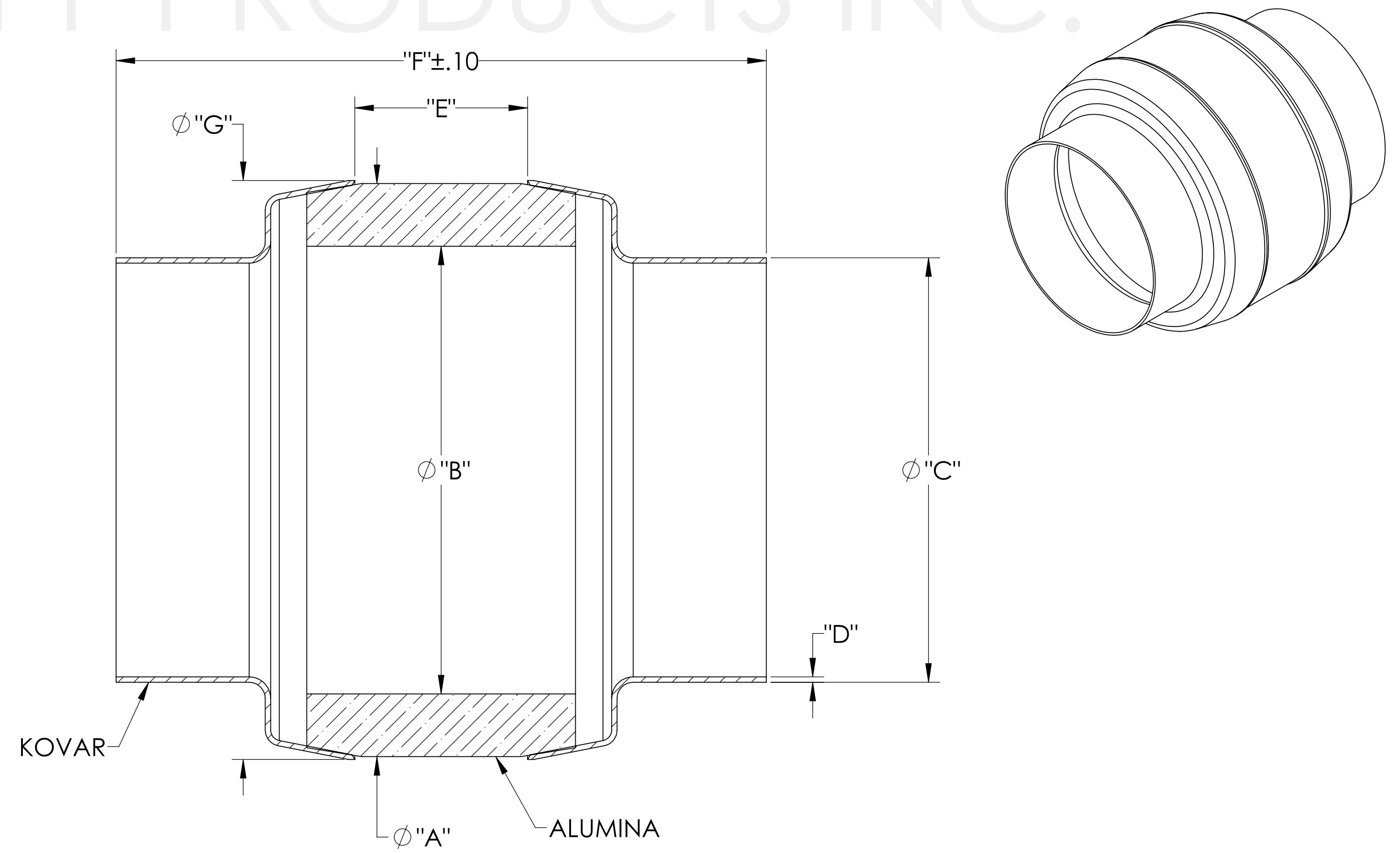

PART #	A	Ø B ±.025	Ø C ±.005	D ±.002	E MIN	F ±.10	(G)	KV RATING
A0625-1-W	3.20	2.50	2.370	.030	.75	3.630	3.23	10
A0625-2-W	4.20	3.50	3.810	.030	.75	3.570	4.25	10
A0625-3-W	6.88	6.00	6.080	.040	1.50	4.500	3.80	20
A0625-4-W	8.63	7.75	7.830	.040	1.50	4.640	5.80	20

SPECIFICATIONS:

1. VOLTAGE: 10, 20KV
2. TEMPERATURE: -200°C TO 450°C
3. LEAK RATE < 1X10-9 ATM CC/SEC HE HE

Break, 10, 20KV Isolation, Stainless Steel Tube Adapters, UHV Compatible

UNLESS OTHERWISE SPECIFIED:		QUOTATION #		N/A	
DIMENSIONS ARE IN INCHES TOLERANCES:		NAME	DATE	MPF PRODUCTS INC.	
ANGULAR: MACH ± 1/2°		DRAWN	9/11/2015		
TWO PLACE DECIMAL ± .030		CHECKED	9/11/2015		
THREE PLACE DECIMAL ± .015		ENG APPR.	9/11/2015		
MATERIAL		THIRD ANGLE:		TITLE: BREAK, 10, 20KV ISOLATION, STAINLESS STEEL TUBE ADAPTERS	
FINISH					
PLATING		APPLICATION NEXT ASSY USED ON			
SURFACE FINISH:		63/ OR BETTER		DOWNLOAD FROM MPFPI.COM DWG. NO. REV	
UNLESS OTHERWISE SPECIFIED:		ALL DIAMETERS CONCENTRIC WITHIN .005. REMOVE ALL BURRS AND SHARP EDGES		A0625 Friday, January 25, 2019 8:51:17 AM	