

MPF PRODUCTS INC.

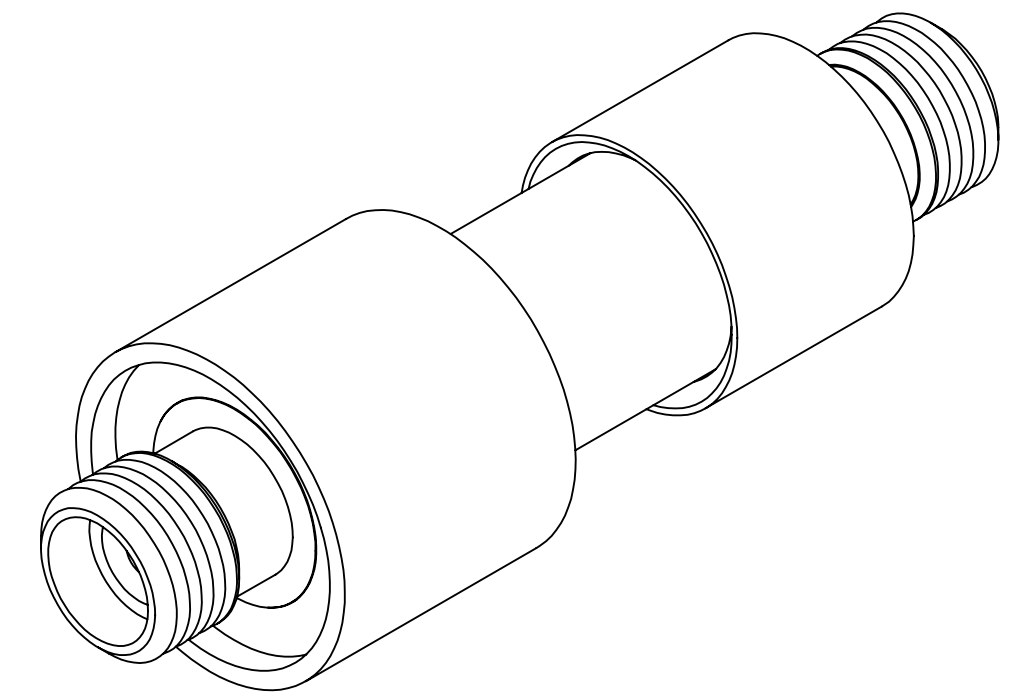

PART #	AIRSIDE CONNECTOR INCLUDED
A0645-1-W	YES
A0645-2-W	NO

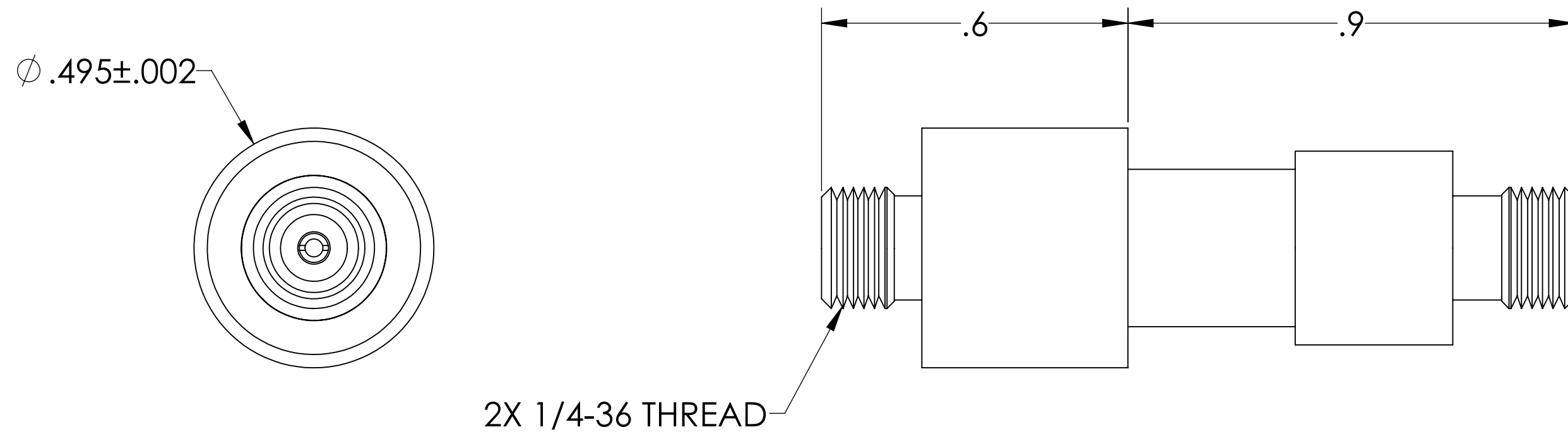
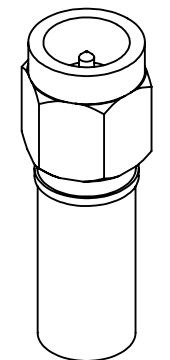

NOTE:

1. SHIELD: GROUNDED
2. VOLTAGE: 700 VOLTS DC
3. CURRENT: 1 AMP
4. TEMPERATURE RATING: -200 TO 450°C (FEEDTHROUGH), 65 TO 165°C (AIRSIDE CONNECTOR)
5. IMPEDANCE: 50 OHM

SMA Coaxial Feedthrough, 50 Ohm Matched Impedance, 1 Pin, Grounded Shield, Double Ended, 0.495" Dia SS Weld Adapter, UHV Compatible

UNLESS OTHERWISE SPECIFIED:		QUOTATION #		N/A	
DIMENSIONS ARE IN INCHES TOLERANCES:		NAME	DATE	MPF PRODUCTS INC.	
ANGULAR: MACH ± 1/2°		DRAWN	9/11/2015		
TWO PLACE DECIMAL ± .030		CHECKED	9/11/2015		
THREE PLACE DECIMAL ± .015		ENG APPR.	9/11/2015		
MATERIAL		THIRD ANGLE:		TITLE:	
				SMA, COAXIAL FEEDTHROUGH, 50 OHM, 1 PIN, GROUNDED SHIELD, DOUBLE ENDED, 0.495" DIA SS WELD ADAPTER	
FINISH		SURFACE FINISH: 63/ OR BETTER		DOWNLOADED FROM MPFPI.COM	
PLATING		UNLESS OTHERWISE SPECIFIED:		DWG. NO. A0645 REV	
		ALL DIAMETERS CONCENTRIC WITHIN .005. REMOVE ALL BURRS AND SHARP EDGES		Thursday, January 17, 2019 2:17:39 PM	