

MPF PRODUCTS INC.

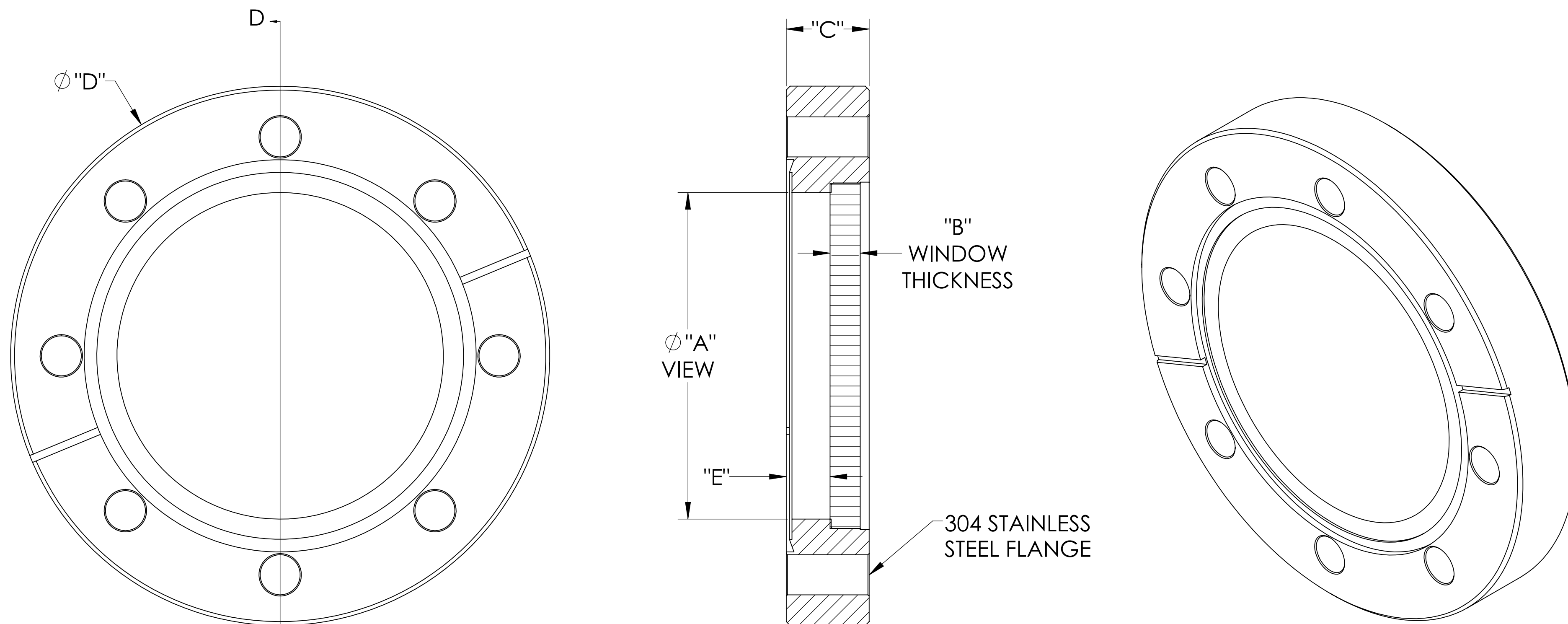

PART #	Ø "A" VIEW	"B"	"C"	"D"	"E"
A0651-1-CF	1.40	.13	.50	2.75	.35
A0651-2-CF	1.40	.13	.62	3.37	.35
A0651-3-CF	2.69	.25	.68	4.50	.41
A0651-4-CF	2.69	.25	.75	4.62	.41
A0651-5-CF	3.88	.25	.78	6.00	.51
A0651-6-CF	3.88	.25	.84	6.75	.51
A0651-7-CF	5.38	.37	.88	8.00	.48
A0651-8-CF	7.78	.37	.97	10.00	.53

SPECIFICATIONS:

1. MATERIAL: CORNING HPFS 7980 FUSED SILICA OR EQUIVALENT
2. TWD < 10λ @ 632NM (PEAK TO VALLEY)
3. SURFACE FINISH: 40/20 SCRATCH-DIG
4. PARALLELISM < 30 ARC MINUTES
5. THERMAL RANGE: -100 °C TO 200 °C
6. HOMOGENEITY GRADE: F
7. INCLUSION CLASS: 2
8. LEAK RATE < 1 X 10⁻⁹ ATM-CC/SEC HE

UV Grade Fused Silica Viewport, Zero Length Profile, 1.40" 2.69", 3.88", 5.38", 7.78" View Dia, Conflat Flange

UNLESS OTHERWISE SPECIFIED:		QUOTATION #		N/A		
DIMENSIONS ARE IN INCHES TOLERANCES:		NAME	DATE	MPF PRODUCTS INC.		
ANGULAR: MACH ± 1/2°		DRAWN	WJ			9/11/2015
TWO PLACE DECIMAL ± .030		CHECKED				9/11/2015
THREE PLACE DECIMAL ± .015		ENG APPR.	WJ			9/11/2015
MATERIAL		THIRD ANGLE:		VIEWPORT, FUSED SILICA, UV, CF FLANGE		
FINISH		APPLICATION				
PLATING		NEXT ASSY USED ON				
SURFACE FINISH: 63 OR BETTER		UNLESS OTHERWISE SPECIFIED:		DOWNLOADED FROM MPFPI.COM		
ALL DIAMETERS CONCENTRIC WITHIN .005. REMOVE ALL BURRS AND SHARP EDGES		DWG. NO.		REV		
		A0651		Thursday, January 24, 2019 10:41:44 AM		