

MPF PRODUCTS INC.

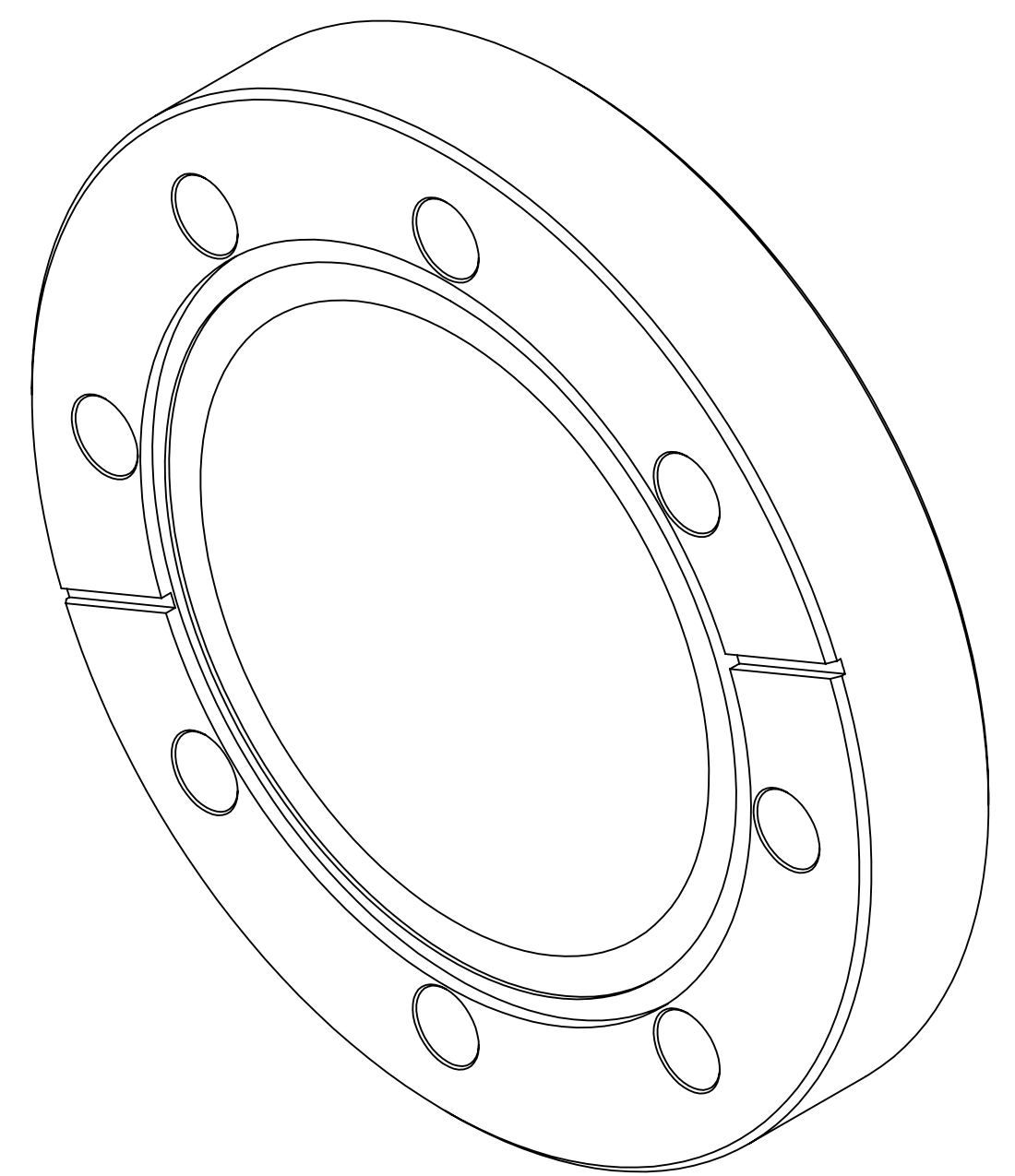
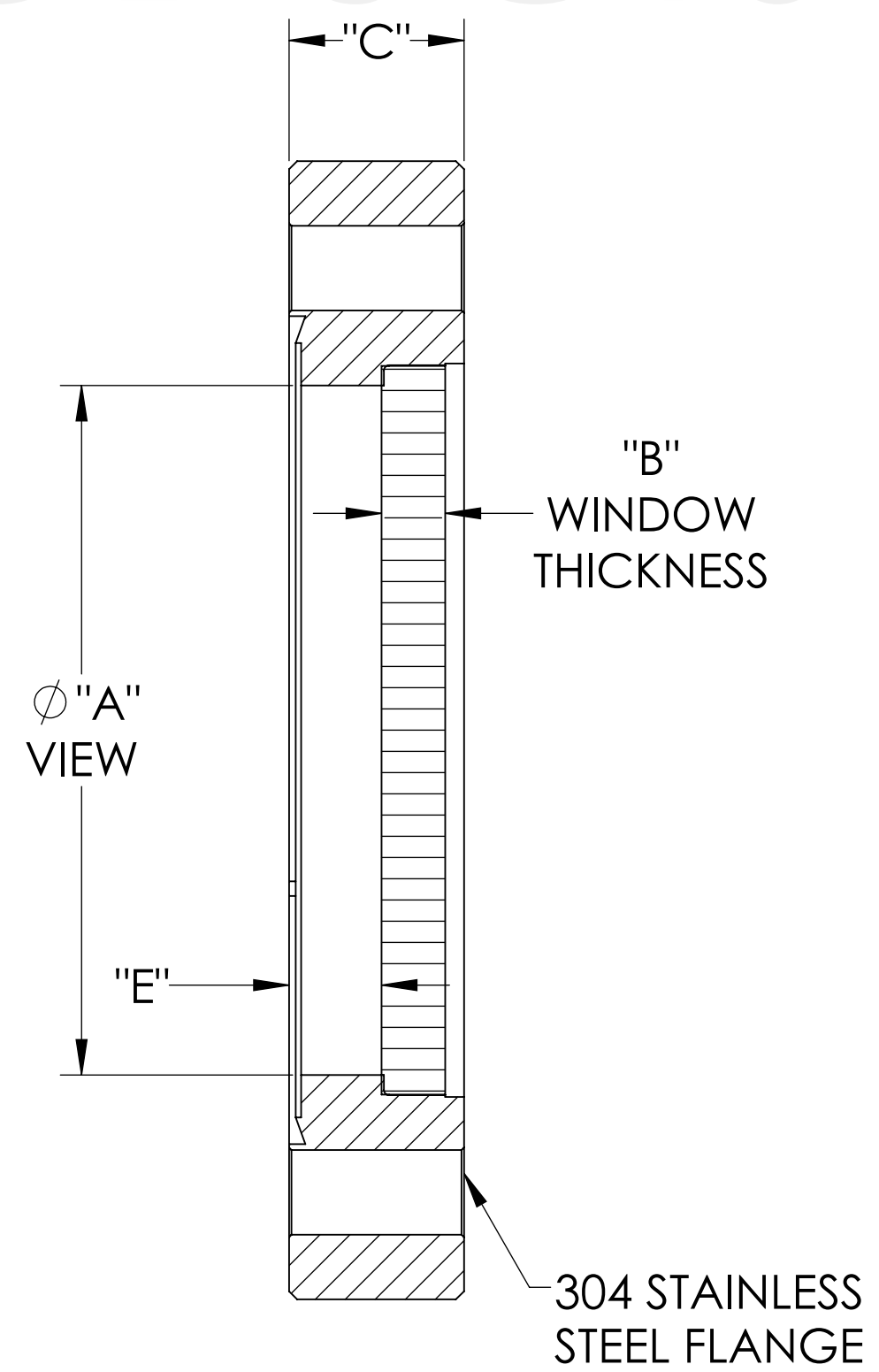
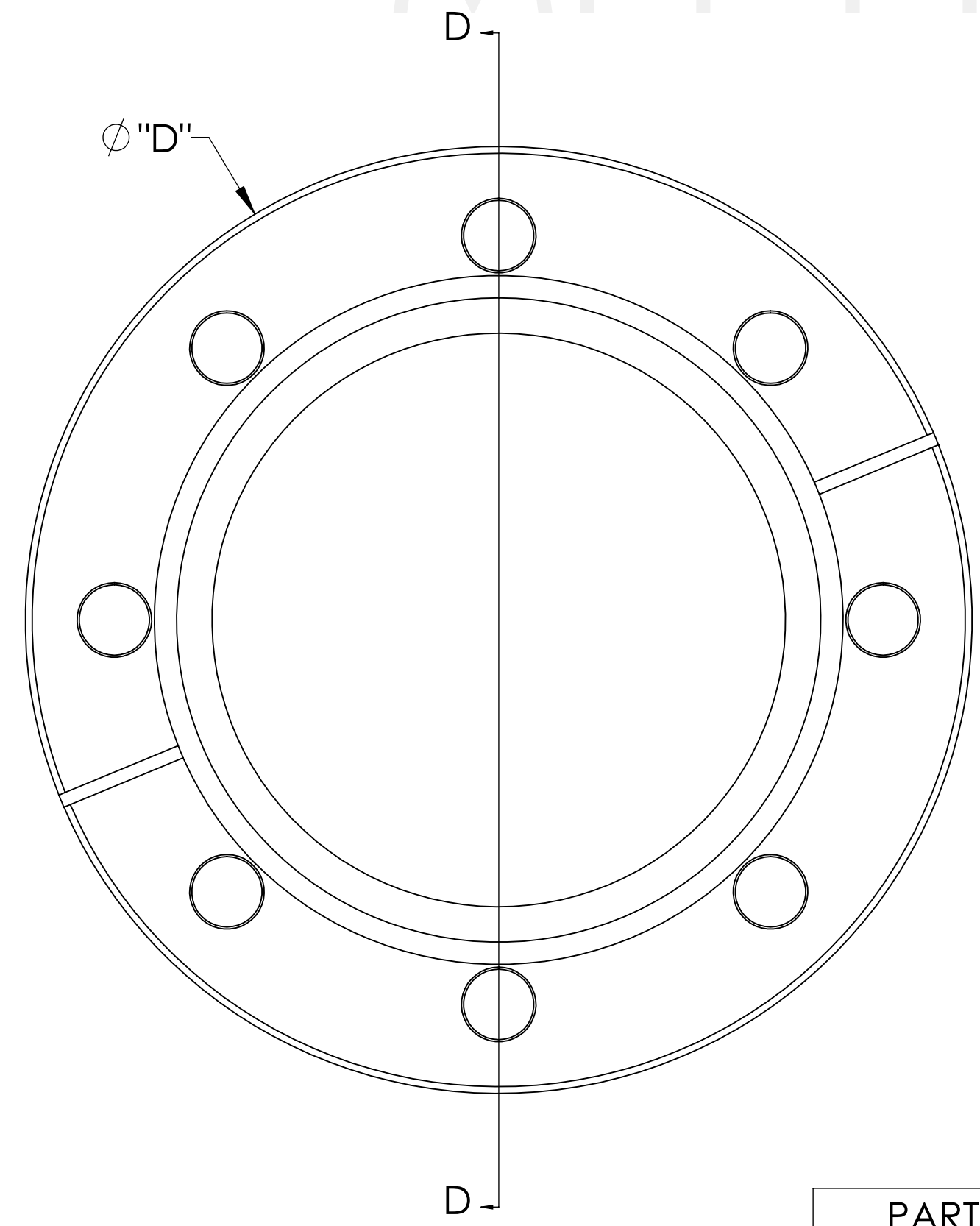

| PART# | Ø "A" VIEW | "B" | "C" | "D" | "E" |
|------------|------------|-----|-----|-------|-----|
| A0652-1-CF | 1.40 | .13 | .50 | 2.75 | .35 |
| A0652-2-CF | 1.40 | .13 | .63 | 3.38 | .35 |
| A0652-3-CF | 2.69 | .25 | .68 | 4.47 | .42 |
| A0652-4-CF | 2.69 | .25 | .75 | 4.62 | .42 |
| A0652-5-CF | 3.88 | .25 | .78 | 6.00 | .51 |
| A0652-6-CF | 3.88 | .25 | .84 | 6.75 | .51 |
| A0652-7-CF | 5.38 | .37 | .88 | 8.00 | .48 |
| A0652-8-CF | 7.78 | .37 | .97 | 10.00 | .53 |

SPECIFICATIONS:

1. MATERIAL: CORNING HPFS 7980 EXCIMER GRADE 193 FUSED SILICA
2. TWD: $\lambda/4$ @ 632NM (PEAK TO VALLEY)
3. PARALLELISM: <10 ARC SECONDS
4. SURFACE FINISH: 20/10 SCRATCH-DIG
5. THERMAL RANGE: -100°C TO 200°C
6. TRANSMISSION: >99.5% @ 193NM (INTERNAL)
7. HOMOGENEITY GRADE: A
8. INCLUSION CLASS: 0
9. LEAK RATE: <1 X 10⁻⁹ ATM-CC/SEC HE

EUV Grade Fused Silica Viewport, Zero Length Profile, 1.40" 2.69" View Dia, Conflat Flange

| | | | | | |
|---|--|-----------------------------|-----------|---|--|
| UNLESS OTHERWISE SPECIFIED: | | QUOTATION # | | N/A | |
| DIMENSIONS ARE IN INCHES TOLERANCES: | | NAME | DATE | MPF PRODUCTS INC. | |
| ANGULAR: MACH ± 1/2° | | DRAWN | 9/11/2015 | | |
| TWO PLACE DECIMAL ± .030 | | CHECKED | 9/11/2015 | | |
| THREE PLACE DECIMAL ± .015 | | ENG APPR. | 9/11/2015 | | |
| MATERIAL | | THIRD ANGLE: | | VIEWPORT, FUSED SILICA, EUV, CF FLANGE | |
| FINISH | | APPLICATION | | | |
| PLATING | | NEXT ASSY USED ON | | | |
| SURFACE FINISH: $\sqrt{63}$ OR BETTER | | UNLESS OTHERWISE SPECIFIED: | | DOWNLOADED FROM MPFPI.COM | |
| ALL DIAMETERS CONCENTRIC WITHIN .005. REMOVE ALL BURRS AND SHARP EDGES | | DWG. NO. | | REV | |
| | | A0652 | | Thursday, January 24, 2019 9:33:34 AM | |