

MPF PRODUCTS INC.

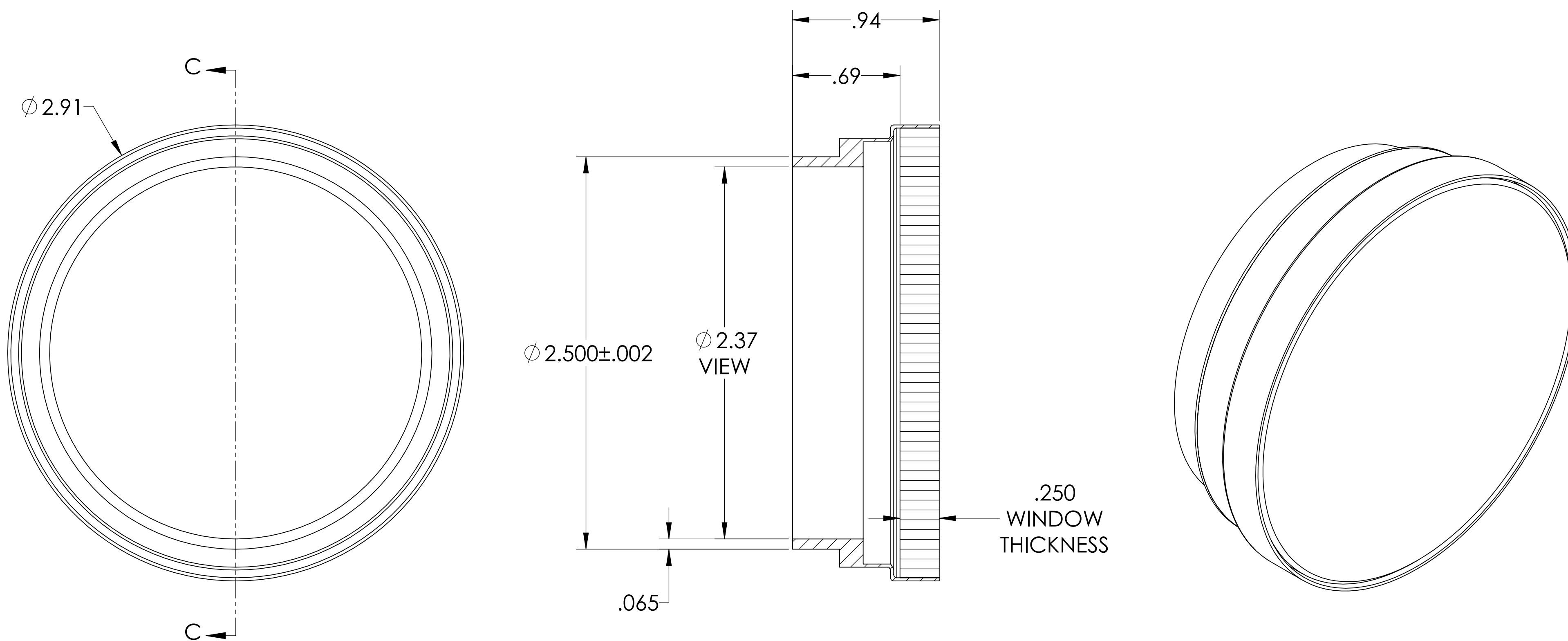

SECTION C-C
SCALE 2 : 1

NOTES:

1. MATERIAL: CORNING HPFS 7980 FUSED SILICA OR EQUIVALENT
2. TWD <math>< \lambda/4 @ 632\text{NM}</math> (PEAK TO VALLEY)
3. PARALLELISM <math>< 10</math> ARC SECONDS
4. SURFACE FINISH: 20/10 SCRATCH-DIG
5. THERMAL RANGE: -100 °C TO 200 °C
6. HOMOGENEITY GRADE: A
7. INCLUSION CLASS: 0
8. LEAK RATE <math>< 1 \times 10^{-9}</math> ATM/CC SEC HE

Laser Grade Fused Silica Viewport, 2.37" View Dia, 2.50" Dia Stainless Steel Weld Adapter

UNLESS OTHERWISE SPECIFIED:	QUOTATION #	N/A	APPROVED
DIMENSIONS ARE IN INCHES TOLERANCES:	DRAWN	WJ	9/11/2015
ANGULAR: MACH ± 1/2°	CHECKED	WJ	9/11/2015
TWO PLACE DECIMAL ± .030	ENG APPR.	WJ	9/11/2015
THREE PLACE DECIMAL ± .015	THIRD ANGLE:		
MATERIAL	APPLICATION		
Material <not specified>	NEXT ASSY	USED ON	TITLE: VIEWPORT, FUSED SILICA, LASER GRADE, 2.4 VIEW, WELD ADAPTER DOWNLOADED FROM MPFPI.COM
FINISH	SURFACE FINISH:	63 OR BETTER	
PLATING	UNLESS OTHERWISE SPECIFIED:	ALL DIAMETERS CONCENTRIC WITHIN .005. REMOVE ALL BURRS AND SHARP EDGES	DWG. NO. A0657-7-W REV. Thursday, January 24, 2019 11:02:07 AM