

# MPF PRODUCTS INC.

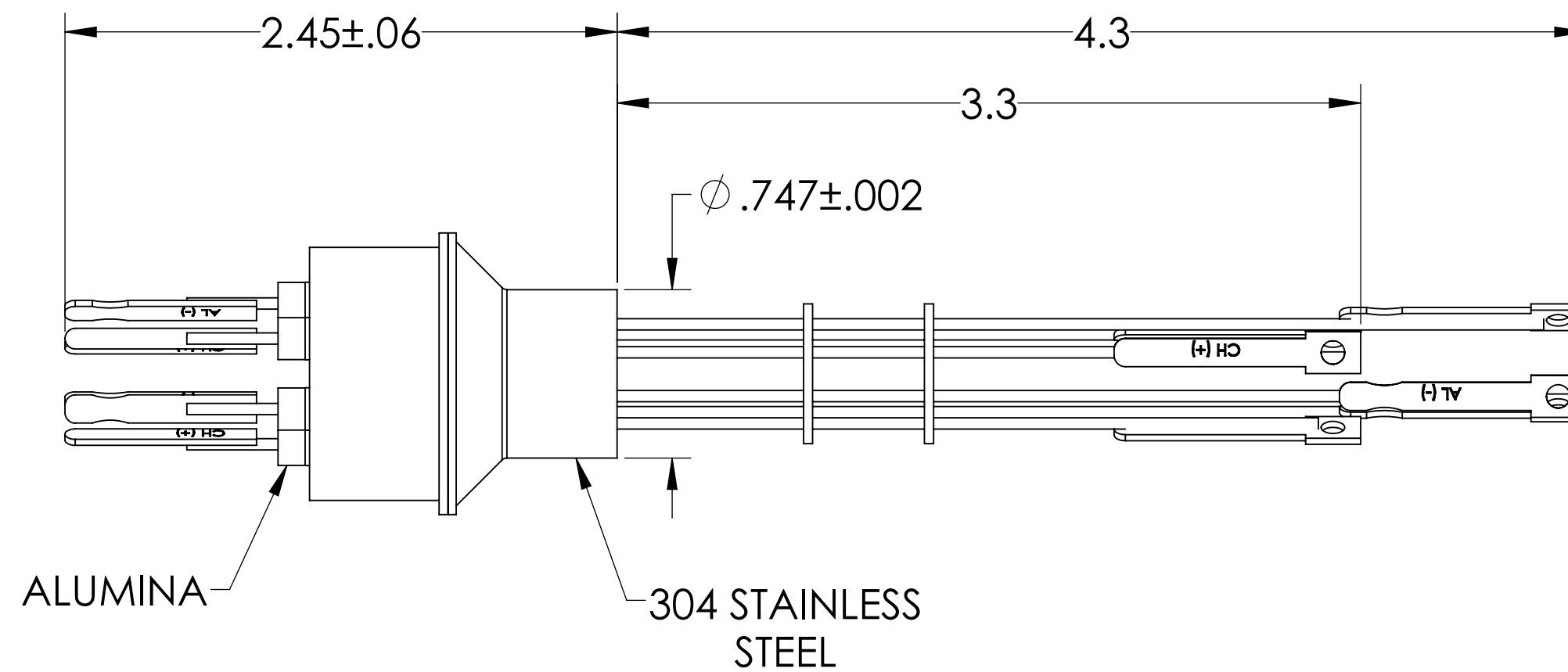

PART #	T/C TYPE
A0661-1-W	K
A0661-2-W	J
A0661-3-W	E
A0661-4-W	C

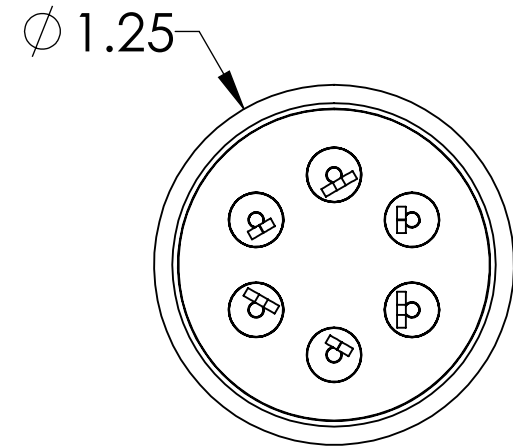
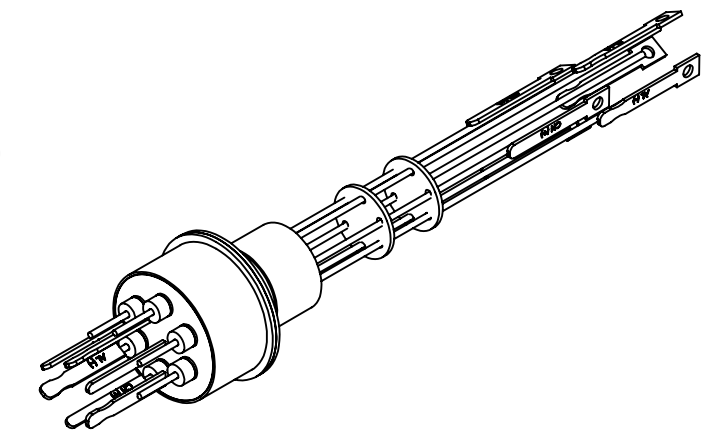
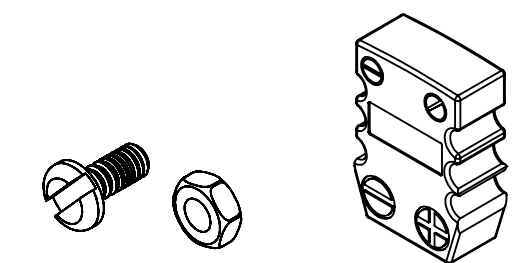

**SPECIFICATIONS:**

1. TEMPERATURE RATING: -100 TO 450°C
2. LEAK RATE < 1X10-9 ATM CC/SEC HE

Thermocouple Feedthrough, 3 Pairs, Miniature Connector, 0.75" Stainless Steel Weld Adapter

UNLESS OTHERWISE SPECIFIED:	QUOTATION #	N/A
DIMENSIONS ARE IN INCHES TOLERANCES:	NAME	DATE
ANGULAR: MACH ± 1/2°	DRAWN	9/11/2015
TWO PLACE DECIMAL ± .030	CHECKED	9/11/2015
THREE PLACE DECIMAL ± .015	ENG APPR.	WJ 9/11/2015
MATERIAL	THIRD ANGLE:	
FINISH	APPLICATION	
PLATING	NEXT ASSY	USED ON
	SURFACE FINISH:	63/ OR BETTER
	UNLESS OTHERWISE SPECIFIED:	
	ALL DIAMETERS CONCENTRIC WITHIN .005.	REMOVE ALL BURRS AND SHARP EDGES
	TITLE:	<b>MPF PRODUCTS INC.</b>
		<b>THERMOCOUPLE, 3 PAIRS, CONNECTOR, .747" WELD ADAPTER</b>
	DOWNLOADED FROM MPFPI.COM	
	DWG. NO.	<b>A0661</b>
	REV	
	Friday, February 8, 2019 8:33:34 AM	