

# MPF PRODUCTS INC.

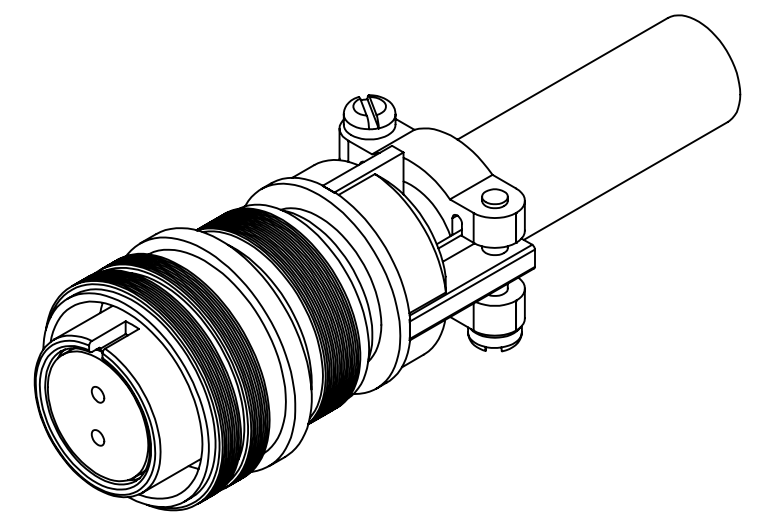
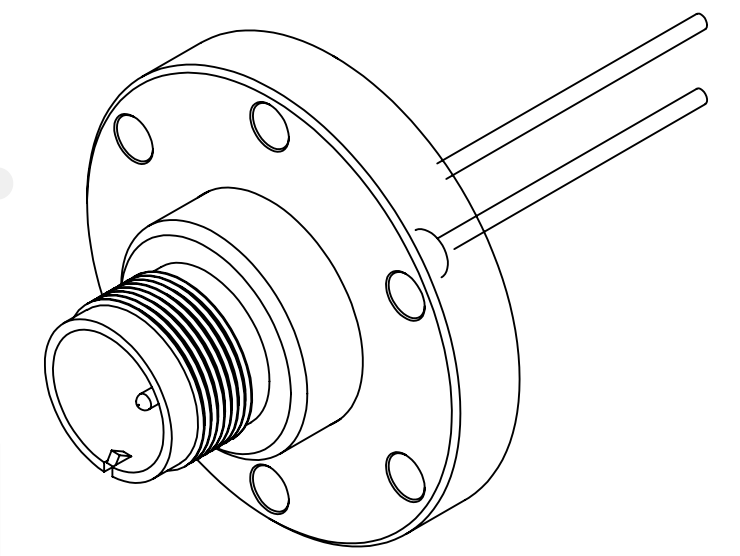
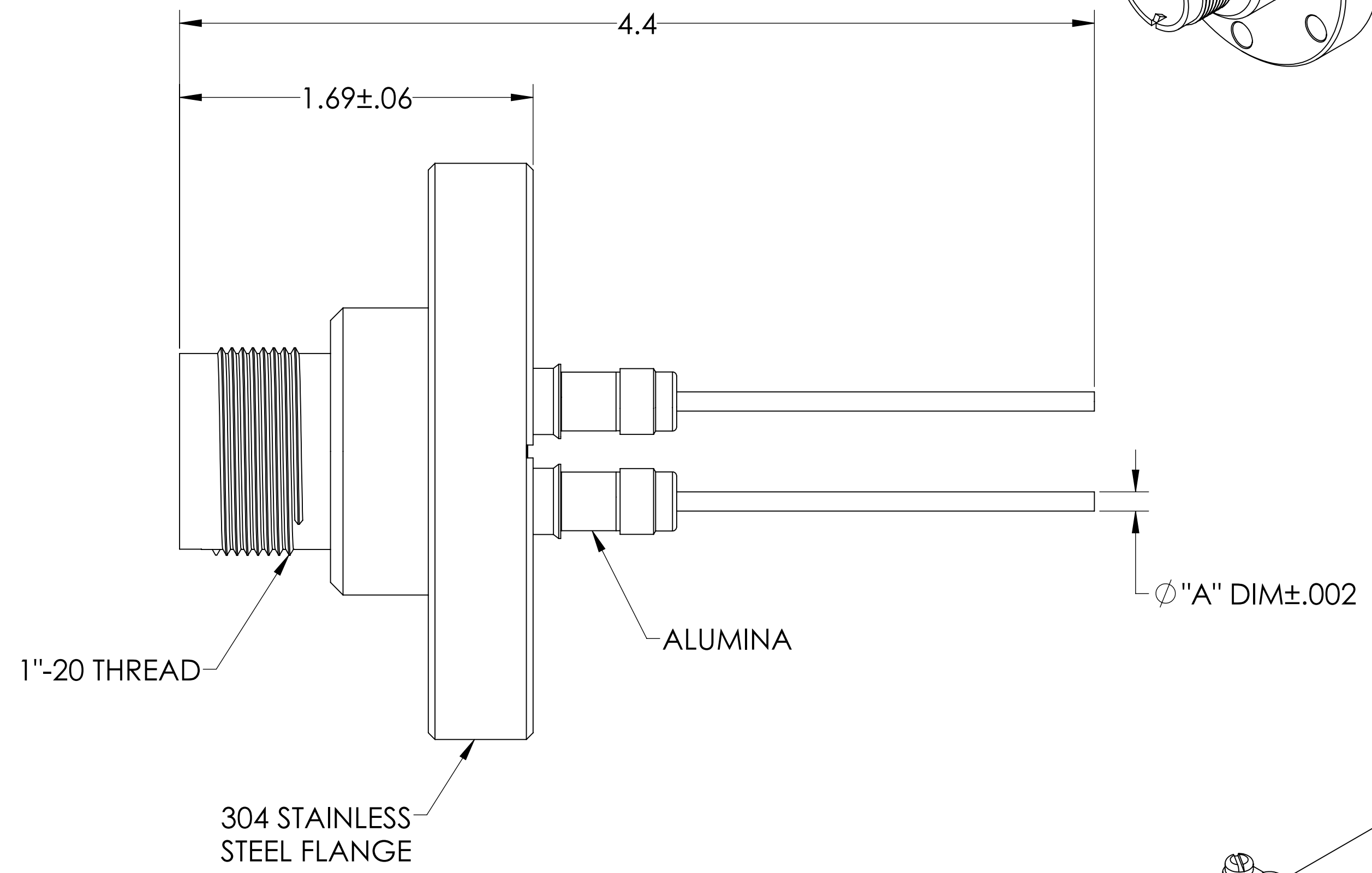
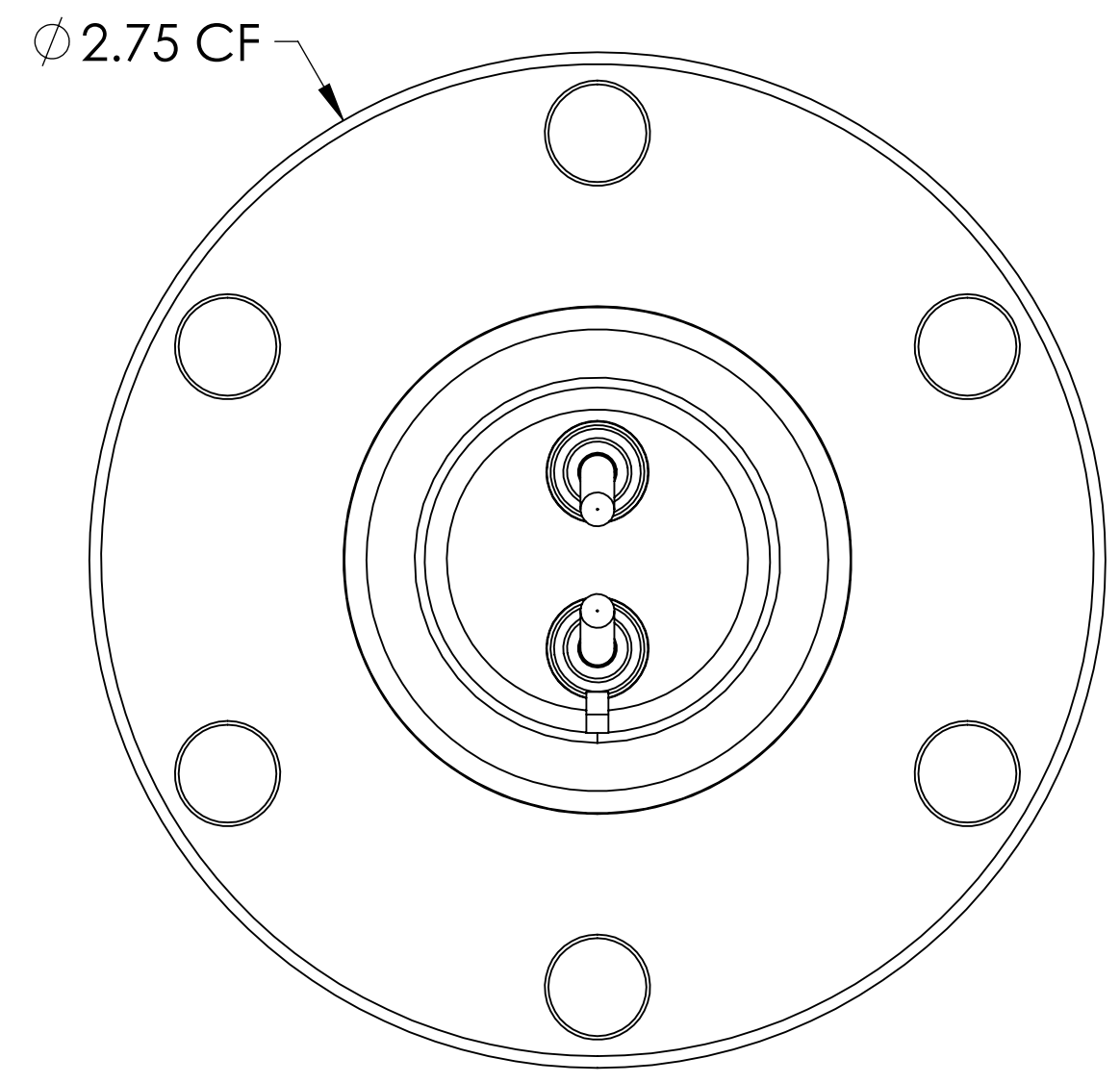

PART #	"A" DIM	CONDUCTOR MATERIAL	CURRENT RATING (PER PIN)
A0754-1-CF	.094	OFHC COPPER	23 AMPS
A0754-2-CF	.092	NICKEL 200	15 AMPS

**SPECIFICATIONS:**

1. VOLTAGE: 700 VOLTS DC
2. CURRENT: SEE TABLE
3. TEMPERATURE RATING: -100 TO 450°C WITHOUT CONNECTOR
4. LEAK RATE < 1X10-9 ATM CC/SEC HE

MS Series, Multipin Feedthrough, 2 Pins, 700 Volts, w/ Air-side Connector, 2.75" Conflat Flange

UNLESS OTHERWISE SPECIFIED:	QUOTATION #	N/A
DIMENSIONS ARE IN INCHES TOLERANCES:	NAME	DATE
ANGULAR: MACH ± 1/2°	DRAWN	9/11/2015
TWO PLACE DECIMAL ± .030	CHECKED	9/11/2015
THREE PLACE DECIMAL ± .015	ENG APPR.	WJ 9/11/2015
MATERIAL	THIRD ANGLE:	
FINISH	APPLICATION	
PLATING	SURFACE FINISH:	63/ OR BETTER UNLESS OTHERWISE SPECIFIED: ALL DIAMETERS CONCENTRIC WITHIN .005. REMOVE ALL BURRS AND SHARP EDGES
TITLE:		MPF PRODUCTS INC.
MULTIPIN, 2 PINS, 700V, 275CF		DOWNLOADED FROM MPFPI.COM
DWG. NO.		A0754
REV		Friday, January 25, 2019 9:40:18 AM