

MPF PRODUCTS INC.

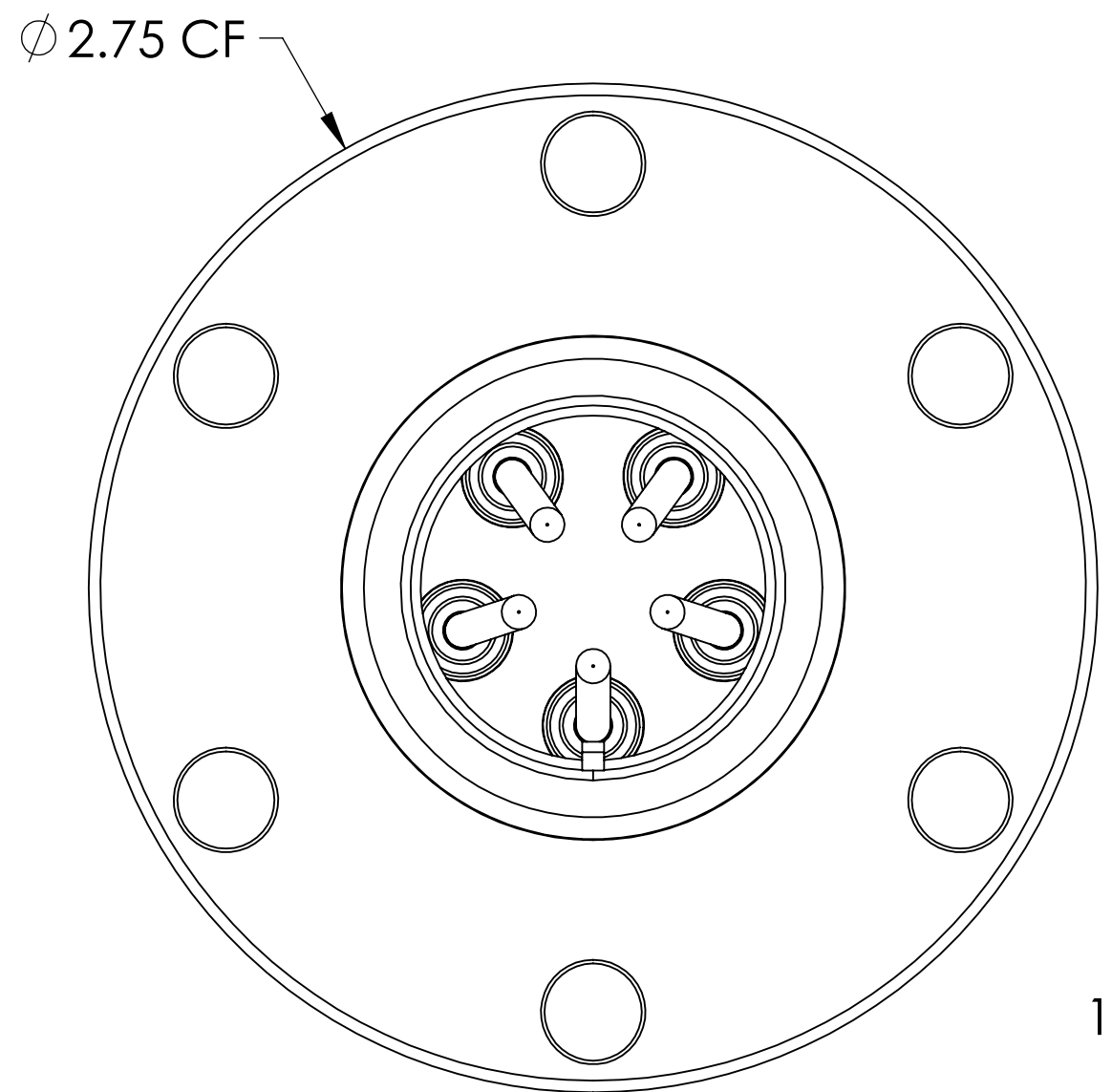

Ø 2.75 CF

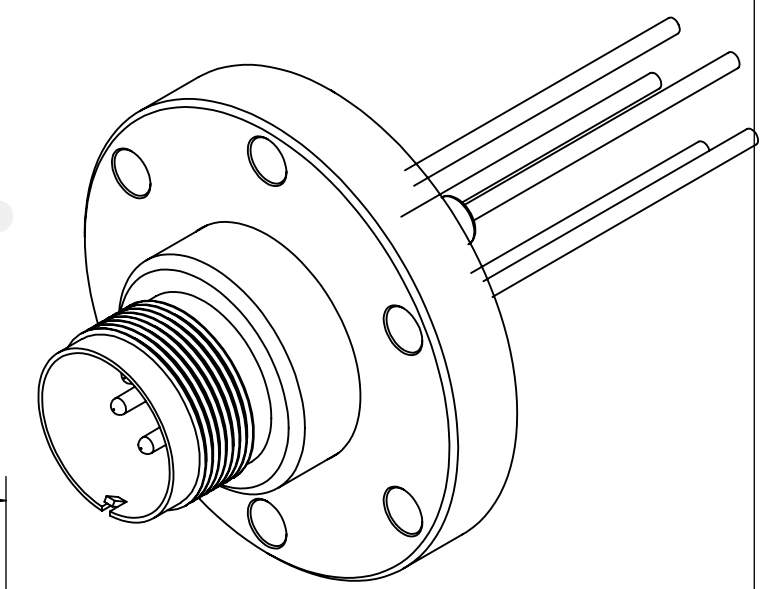
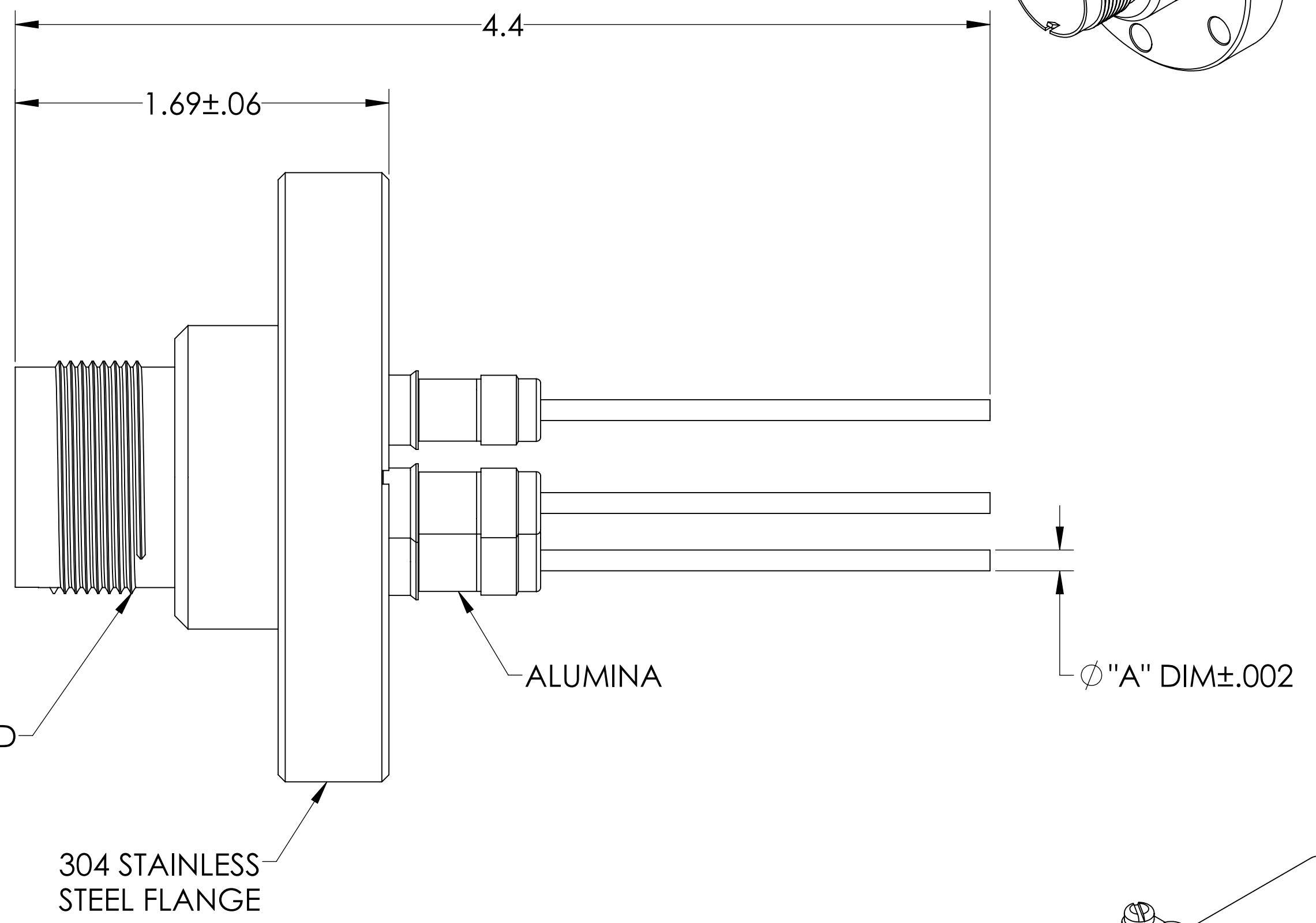

PART #	"A" DIM	CONDUCTOR MATERIAL	CURRENT RATING (PER PIN)
A0755-1-CF	.094	OFHC COPPER	23 AMPS
A0755-2-CF	.092	NICKEL 200	15 AMPS

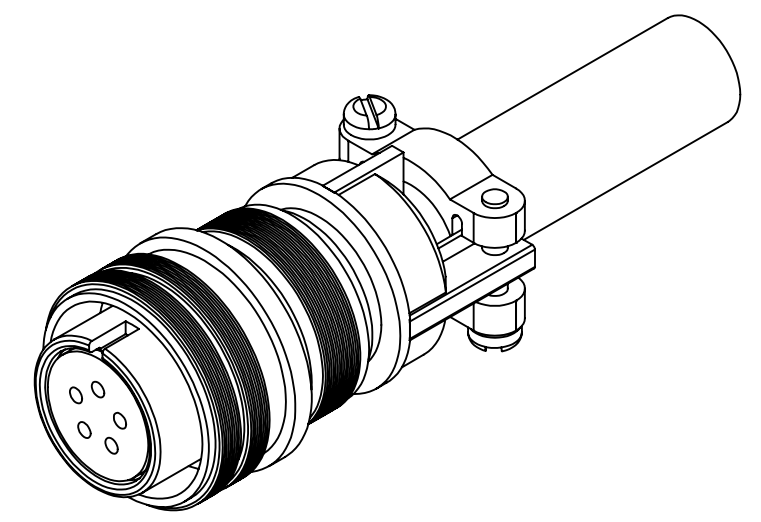

SPECIFICATIONS:

1. VOLTAGE: 700 VOLTS DC
2. CURRENT: SEE TABLE
3. TEMPERATURE RATING: -100 TO 450°C WITHOUT CONNECTOR
4. LEAK RATE < 1X10-9 ATM CC/SEC HE

MS Series, Multipin Feedthrough, 5 Pins, 700 Volts, w/ Air-side Connector, 2.75" Conflat Flange

UNLESS OTHERWISE SPECIFIED:		QUOTATION #		N/A	
DIMENSIONS ARE IN INCHES TOLERANCES:		NAME	DATE	MPF PRODUCTS INC.	
ANGULAR: MACH ± 1/2°		DRAWN	9/11/2015		
TWO PLACE DECIMAL ± .030		CHECKED	9/11/2015		
THREE PLACE DECIMAL ± .015		ENG APPR.	9/11/2015		
MATERIAL		THIRD ANGLE:		MULTIPIN, 5 PINS, 700V, 275CF	
FINISH		APPLICATION			
PLATING		NEXT ASSY USED ON			
SURFACE FINISH: 63/ OR BETTER		UNLESS OTHERWISE SPECIFIED:		DOWNLOADED FROM MPFPI.COM	
ALL DIAMETERS CONCENTRIC WITHIN .005. REMOVE ALL BURRS AND SHARP EDGES		DWG. NO.		REV	
		A0755		Friday, January 25, 2019 9:39:42 AM	