

MPF PRODUCTS INC.

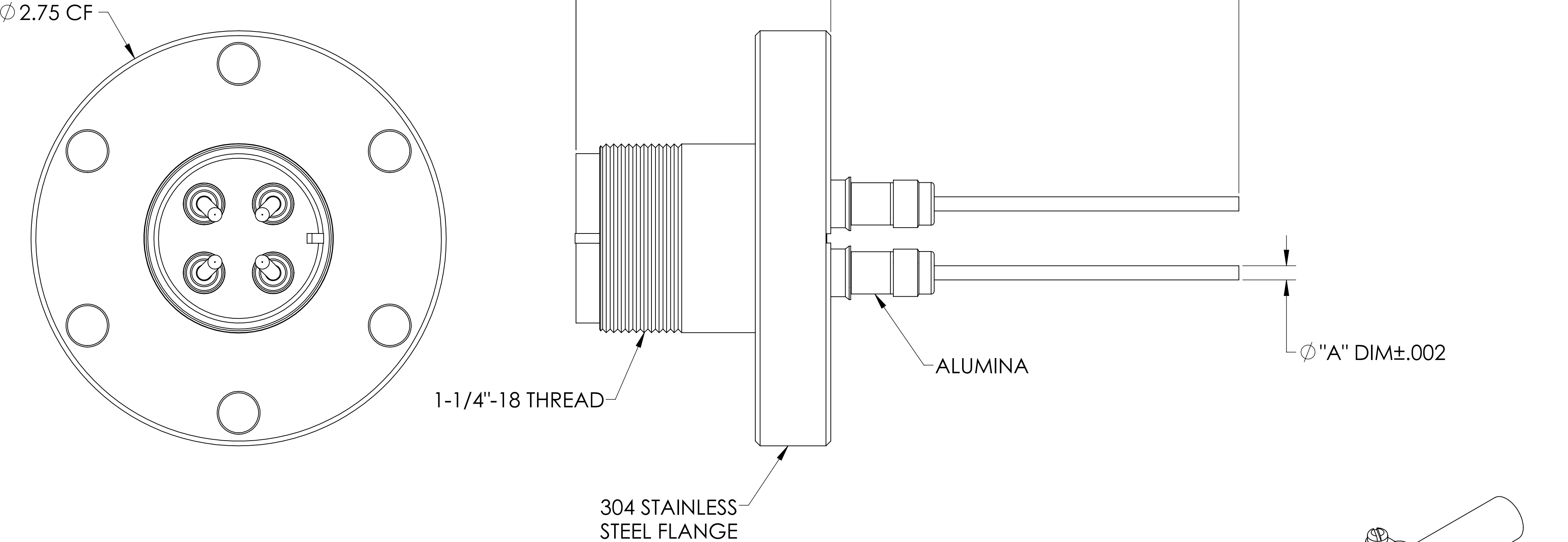

PART #	"A" DIM	CONDUCTOR MATERIAL	CURRENT RATING (PER PIN)
A0756-1-CF	.094	OFHC COPPER	23 AMPS
A0756-2-CF	.092	NICKEL 200	15 AMPS

- SPECIFICATIONS:
- 1. VOLTAGE: 700 VOLTS DC
 - 2. CURRENT: SEE TABLE
 - 3. TEMPERATURE RATING: -100 TO 450°C WITHOUT CONNECTOR
 - 4. LEAK RATE < 1X10-9 ATM CC/SEC HE

MS Series, Multipin Feedthrough, 4 Pins, 700 Volts, w/ Air-side Connector, 2.75" Conflat Flange

UNLESS OTHERWISE SPECIFIED:		QUOTATION #		N/A	
DIMENSIONS ARE IN INCHES TOLERANCES:		NAME	DATE	MPF PRODUCTS INC.	
ANGULAR: MACH ± 1/2°		DRAWN	WJ	9/11/2015	TITLE:
TWO PLACE DECIMAL ± .030		CHECKED		9/11/2015	
THREE PLACE DECIMAL ± .015		ENG APPR.	WJ	9/11/2015	
MATERIAL		THIRD ANGLE:		MULTIPIN, 4 PINS, 700V, 275CF	
		APPLICATION		DOWNLOADED FROM MPFPI.COM	
		NEXT ASSY		DWG. NO.	
FINISH		SURFACE FINISH: 63/ OR BETTER		REV	
PLATING		UNLESS OTHERWISE SPECIFIED:		A0756	
		ALL DIAMETERS CONCENTRIC WITHIN .005. REMOVE ALL BURRS AND SHARP EDGES		Wednesday, October 11, 2023 3:11:30 PM	