

MPF PRODUCTS INC.

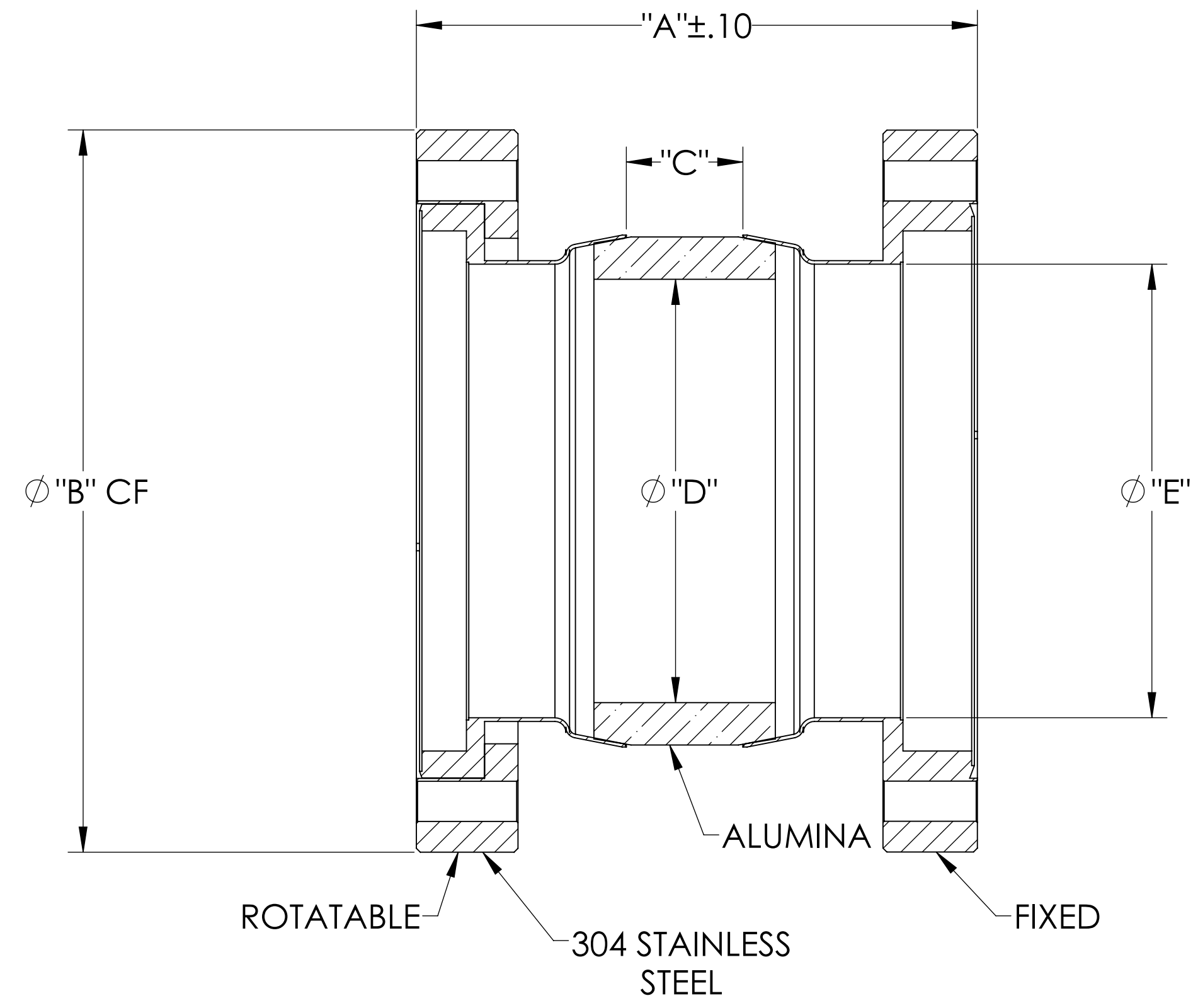
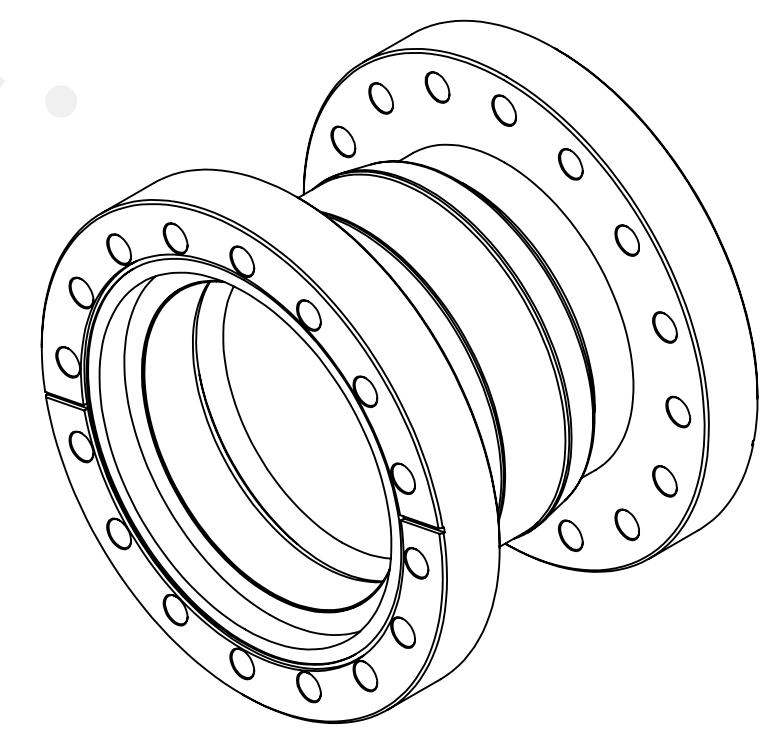

PART #	"A"±.10	Ø"B"	"C" MIN	"D"	"E" MIN	KV RATING
A0805-1-CF	4.50	4.50	.75	2.50	2.30	10
A0805-2-CF	4.62	6.00	.75	2.50	3.75	10
A0805-3-CF	5.50	8.00	1.50	6.00	6.00	20
A0805-4-CF	5.55	10.00	1.50	7.75	7.75	20

SPECIFICATIONS:

1. VOLTAGE: 10KV
2. TEMPERATURE: -200°C TO 450°C
3. LEAK RATE < 1X10-9 ATM CC/SEC HE

Break, 10, 20KV Isolation, Conflat Flange, UHV Compatible

UNLESS OTHERWISE SPECIFIED:		QUOTATION #		N/A		
DIMENSIONS ARE IN INCHES		NAME	DATE	MPF PRODUCTS INC.		
TOLERANCES:		DRAWN	WJ			9/11/2015
ANGULAR: MACH ± 1/2°		CHECKED				9/11/2015
TWO PLACE DECIMAL ± .030		ENG APPR.	WJ			9/11/2015
THREE PLACE DECIMAL ± .015		THIRD ANGLE:		TITLE: BREAK, 10, 20KV ISOLATION, CONFLAT FLANGE		
MATERIAL						
FINISH		APPLICATION NEXT ASSY USED ON				
PLATING		SURFACE FINISH: 63/ OR BETTER		DOWNLOADED FROM MPFPI.COM DWG. NO. REV		
		UNLESS OTHERWISE SPECIFIED:		A0805		
		ALL DIAMETERS CONCENTRIC WITHIN .005. REMOVE ALL BURRS AND SHARP EDGES		Friday, January 25, 2019 11:56:26 AM		