

MPF PRODUCTS INC.

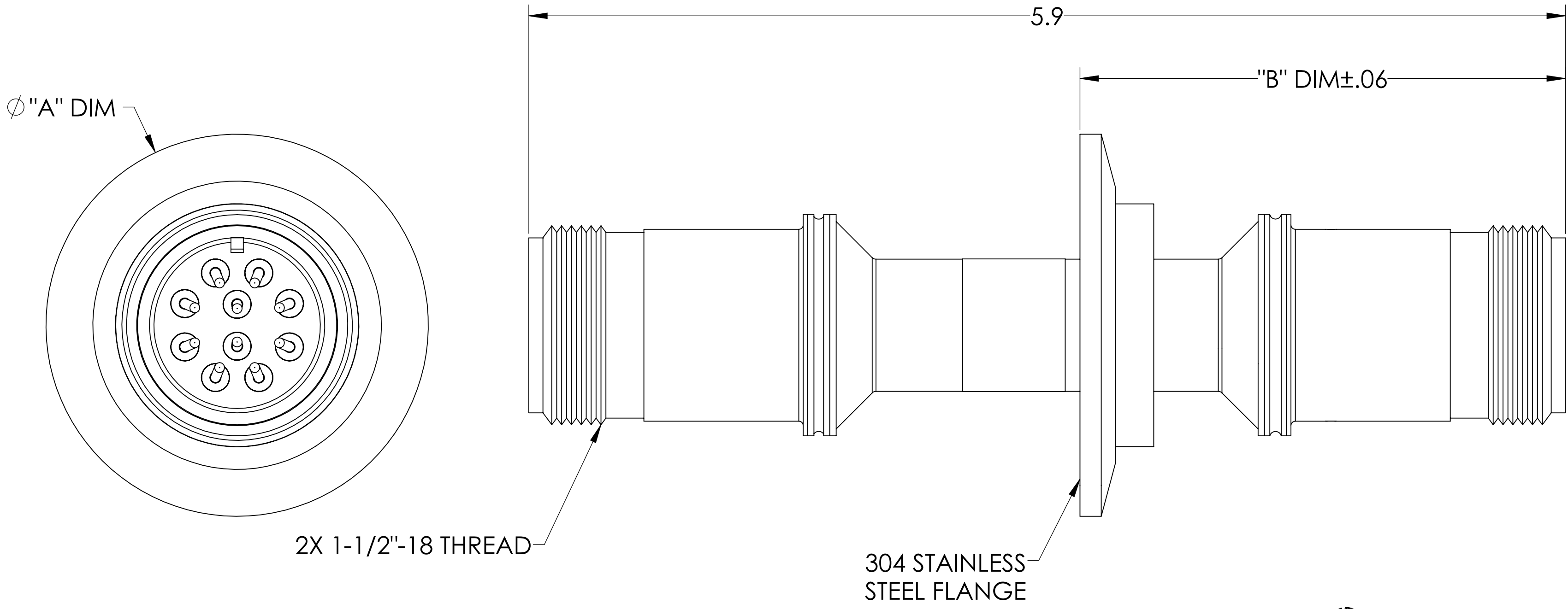
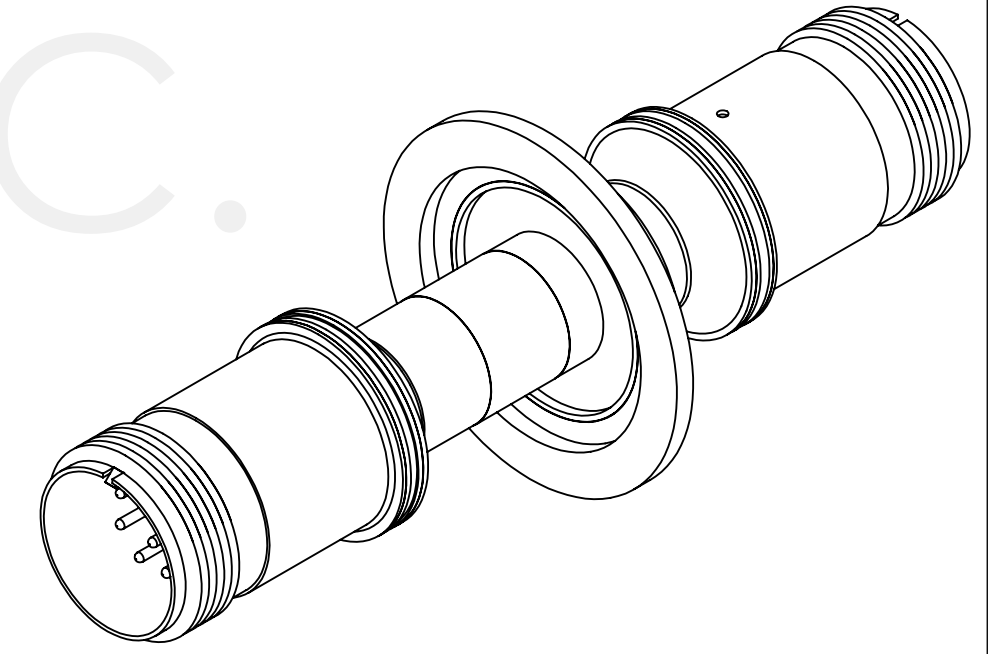

2X 1-1/2"-18 THREAD

304 STAINLESS STEEL FLANGE

PART #	"A" DIM	"B" DIM
A0757-1-CF	2.16	2.74
A0757-2-CF	2.95	2.64

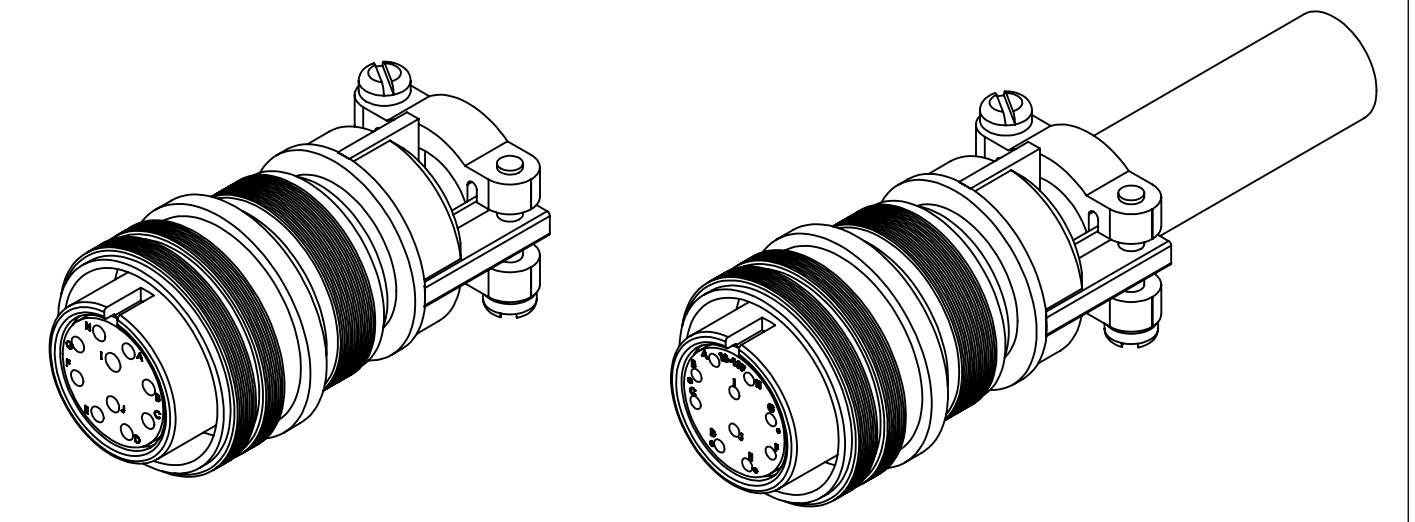

SPECIFICATIONS:

1. VOLTAGE: 700 VOLTS DC
2. CURRENT: 10 AMPS PER PIN, 50 AMPS FULL LOAD
3. TEMPERATURE RATING: -100 TO 450°C WITHOUT CONNECTOR
4. LEAK RATE <math>< 1 \times 10^{-9}</math> ATM CC/SEC HE

MS Series, Multipin Feedthrough, 10 Pins, 700 Volts, 10 Amps per Pin, Double-Ended w/ Air & Vacuum-side Connectors, QF/KF

UNLESS OTHERWISE SPECIFIED:		QUOTATION #		N/A		
DIMENSIONS ARE IN INCHES		NAME	DATE	MPF PRODUCTS INC.		
TOLERANCES:		DRAWN	WJ			9/11/2015
ANGULAR: MACH $\pm 1/2^\circ$		CHECKED	WJ			9/11/2015
TWO PLACE DECIMAL $\pm .030$		ENG APPR.	WJ			9/11/2015
THREE PLACE DECIMAL $\pm .015$		THIRD ANGLE:		MULTIPIN, 10 PINS, 700V, 10 A, DOUBLE ENDED, QF/KF		
MATERIAL						
FINISH		APPLICATION				
PLATING		NEXT ASSY	USED ON	DOWNLOADED FROM MPFPI.COM		
SURFACE FINISH: $\sqrt{63}$ OR BETTER		UNLESS OTHERWISE SPECIFIED:		DWG. NO.	REV	
ALL DIAMETERS CONCENTRIC WITHIN .005. REMOVE ALL BURRS AND SHARP EDGES		FRIDAY, JANUARY 25, 2019 1:12:42 PM		A1062		