

# MPF PRODUCTS INC.

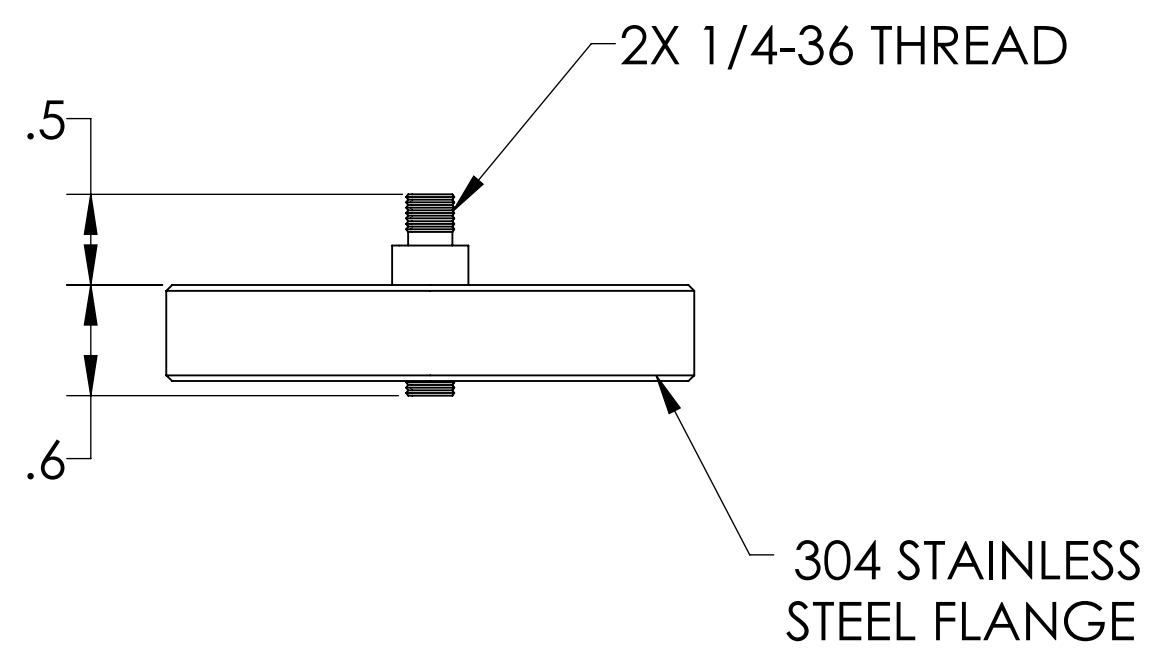

PART #	NUMBER OF PINS	"A" DIM
A12415-1-CF	1	N/A
A12415-2-CF	2	.88
A12415-3-CF	3	.88
A12415-4-CF	4	.95

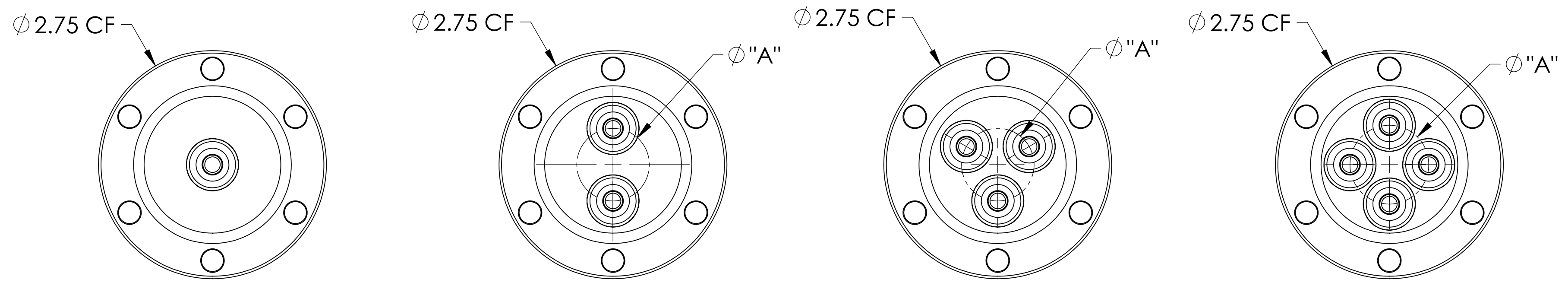
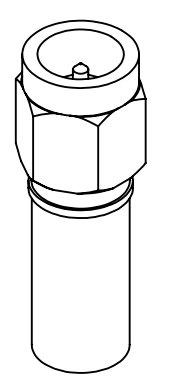

**NOTE:**

1. SHIELD: GROUNDING
2. VOLTAGE: 1000 VOLTS DC
3. CURRENT: 1 AMP
4. TEMPERATURE RATING: -200 TO 450°C (FEEDTHROUGH), 65 TO 165°C (AIRSIDE CONNECTOR)
5. IMPEDANCE: 50 OHM (40 GHz)

SMA Coaxial Feedthrough, 50 Ohm, 40 GHz, Grounded Shield, 2.75" Conflat Flange, UHV Compatible

UNLESS OTHERWISE SPECIFIED:	QUOTATION #	N/A	
DIMENSIONS ARE IN INCHES TOLERANCES:	DRAWN	NAME	DATE
ANGULAR: MACH ± 1/2°	WJ	WJ	9/11/2015
TWO PLACE DECIMAL ± .030	CHECKED		9/11/2015
THREE PLACE DECIMAL ± .015	ENG APPR.	WJ	9/11/2015
MATERIAL	THIRD ANGLE:		
FINISH	APPLICATION	NEXT ASSY      USED ON	
PLATING	SURFACE FINISH:	63/ OR BETTER	
	UNLESS OTHERWISE SPECIFIED:	ALL DIAMETERS CONCENTRIC WITHIN .005. REMOVE ALL BURRS AND SHARP EDGES	
	TITLE:	SMA COAXIAL FEEDTHROUGH, 50 OHM, 40 GHz, GROUNDING SHIELD, 2.75" CONFLAT FLANGE	
	DOWNLOADED FROM MPFPI.COM		
	DWG. NO.	A12415	REV
	Monday, April 8, 2019 2:31:43 PM		