

# MPF PRODUCTS INC.

DIRECTION OF PRESSURE

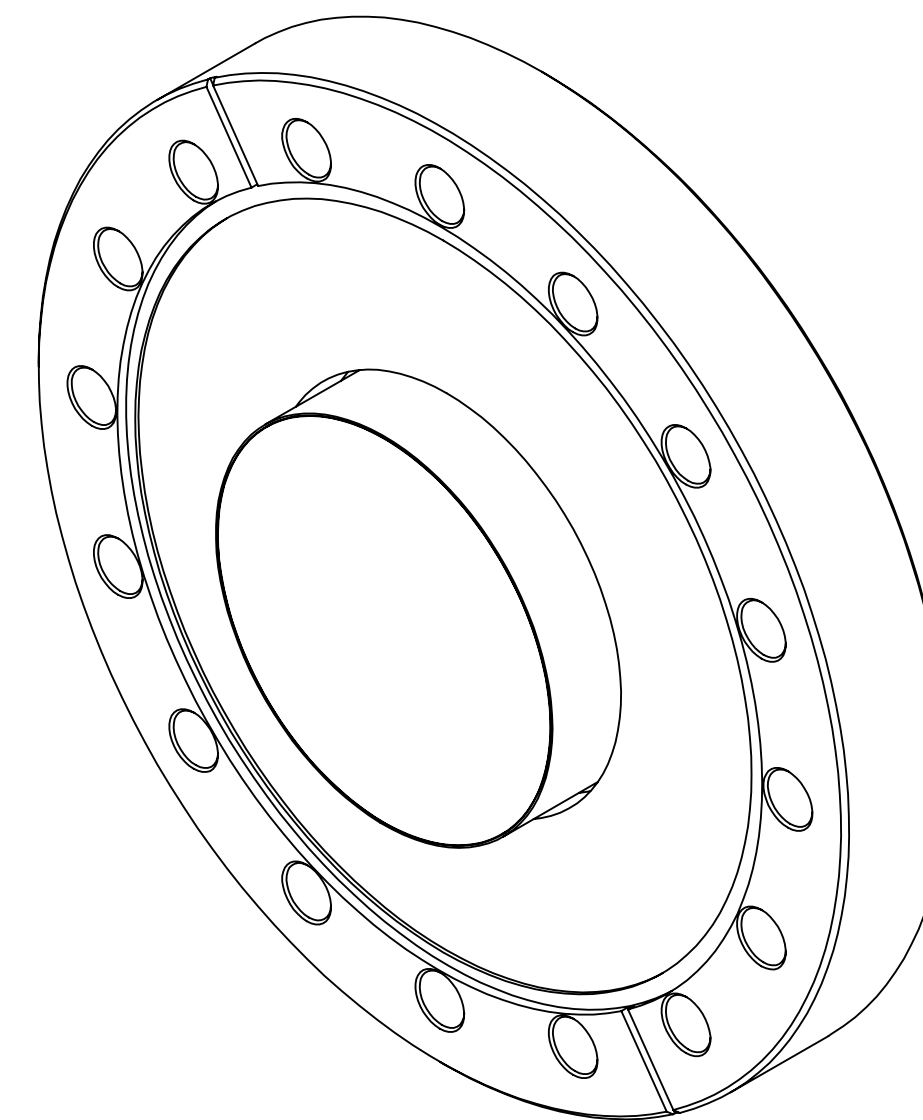
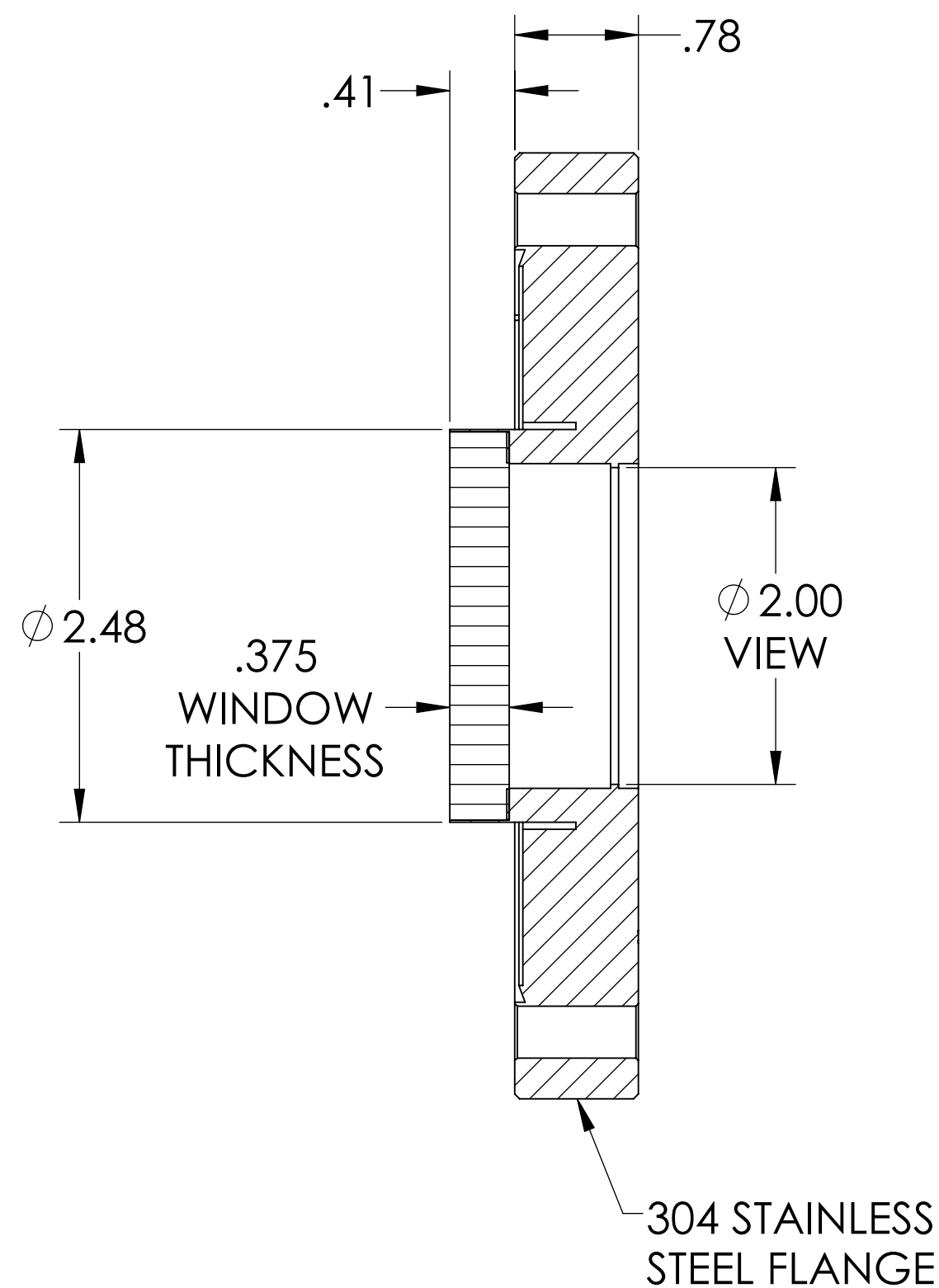
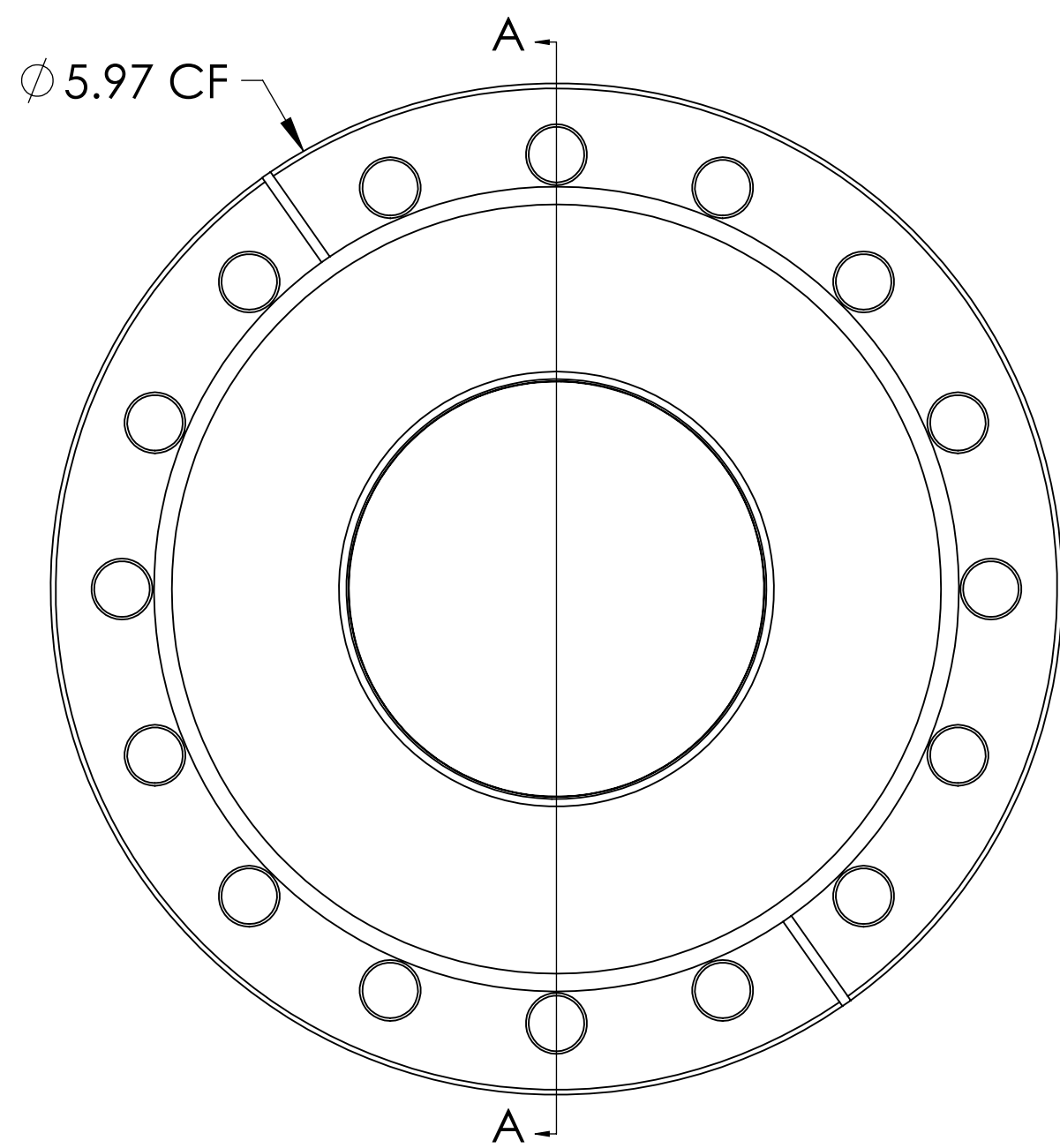

**SPECIFICATIONS:**

1. MATERIAL: SAPPHIRE
2. TWD < 8λ @ 632nm (PEAK TO VALLEY)
3. PARALLELISM < 3 ARC-MINUTES
4. SURFACE FINISH: 50-20 SCRATCH-DIG
5. THERMAL RANGE: -100 °C TO 450 °C
6. ORIENTATION: 0°
7. LEAK RATE < 1X10-9 ATM CC/SEC HE

UV Grade Sapphire Viewport, Over-Pressure, 2.00" View Dia, 6.00" Conflat Flange

UNLESS OTHERWISE SPECIFIED:		QUOTATION #		N/A	
DIMENSIONS ARE IN INCHES TOLERANCES:		DRAWN	WJ	DATE	9/11/2015
ANGULAR: MACH ± 1/2°		CHECKED	WJ	DATE	9/11/2015
TWO PLACE DECIMAL ± .030		ENG APPR.	WJ	DATE	9/11/2015
THREE PLACE DECIMAL ± .015		THIRD ANGLE:			
MATERIAL					
FINISH		APPLICATION			
PLATING		NEXT ASSY USED ON			
SURFACE FINISH: 63 OR BETTER		TITLE:			
UNLESS OTHERWISE SPECIFIED:		2.00" VIEW, OVER-PRESSURE, SAPPHIRE VIEWPORT			
ALL DIAMETERS CONCENTRIC WITHIN .005. REMOVE ALL BURRS AND SHARP EDGES		DOWNLOADED FROM MPFPI.COM DWG. NO. A12821-1-CF REV.			
		Friday, January 25, 2019 4:19:59 PM			