

MPF PRODUCTS INC.

NOTES:

- * TYPE K:
ALUMEL CONDUCTORS HAVE A NEGATIVE POLARITY (MAGNETIC).
CHROMEL CONDUCTORS HAVE A POSITIVE POLARITY (NON - MAGNETIC).
- * TYPE J:
CONSTANTAN CONDUCTORS HAVE A NEGATIVE POLARITY (NON - MAGNETIC).
IRON CONDUCTORS HAVE A POSITIVE POLARITY (MAGNETIC).
- * TYPE E:
CONSTANTAN CONDUCTORS HAVE A NEGATIVE POLARITY (NON - MAGNETIC).
CHROMEL CONDUCTORS HAVE A POSITIVE POLARITY (NON - MAGNETIC).

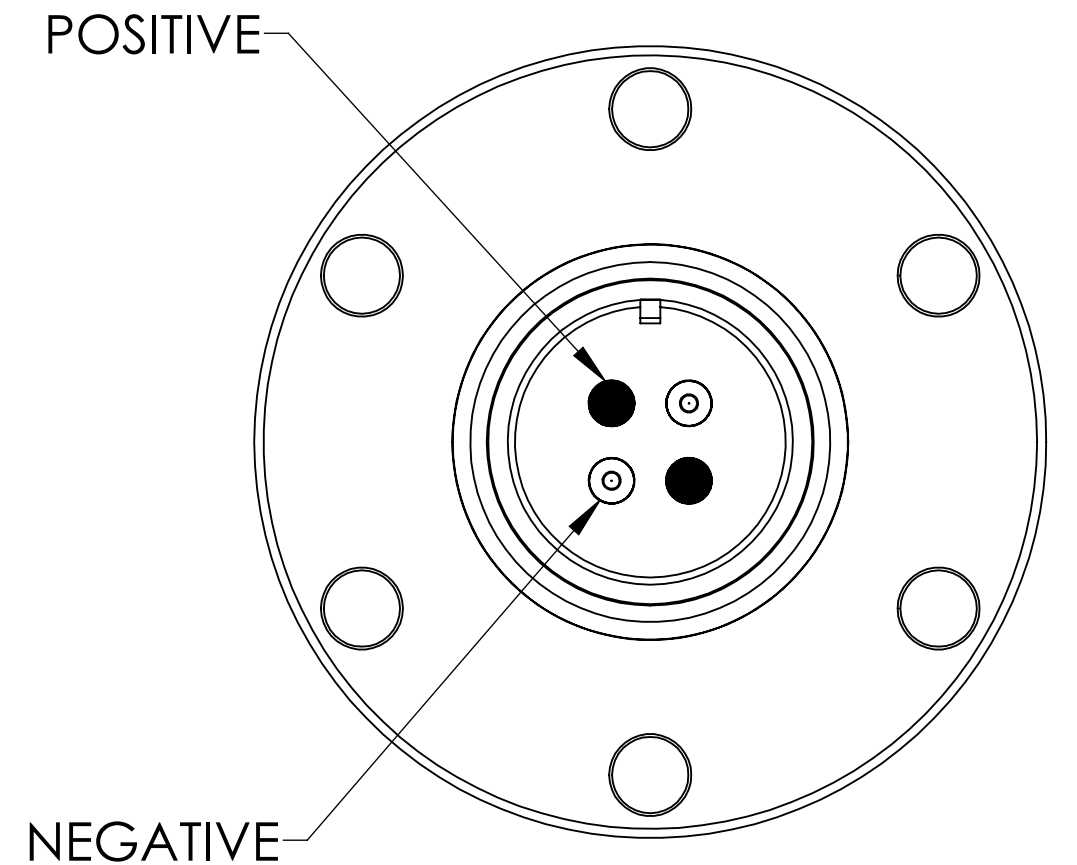
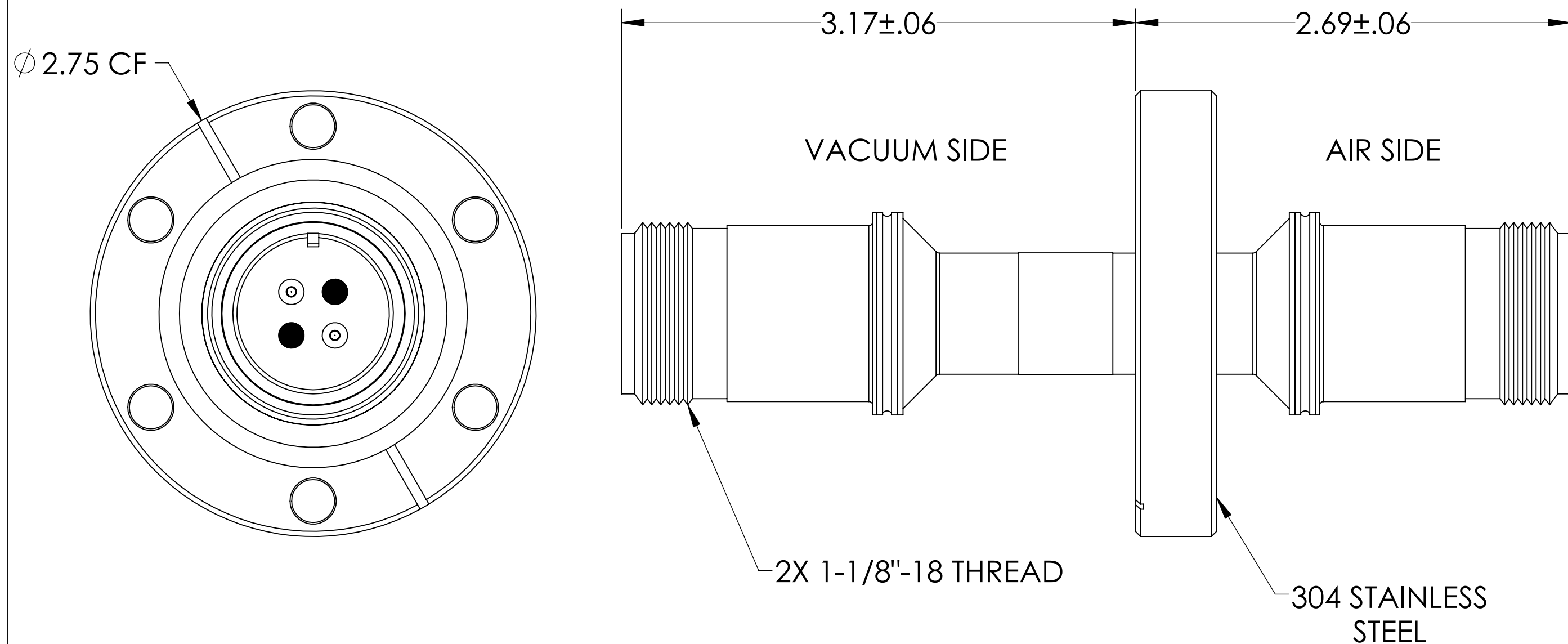
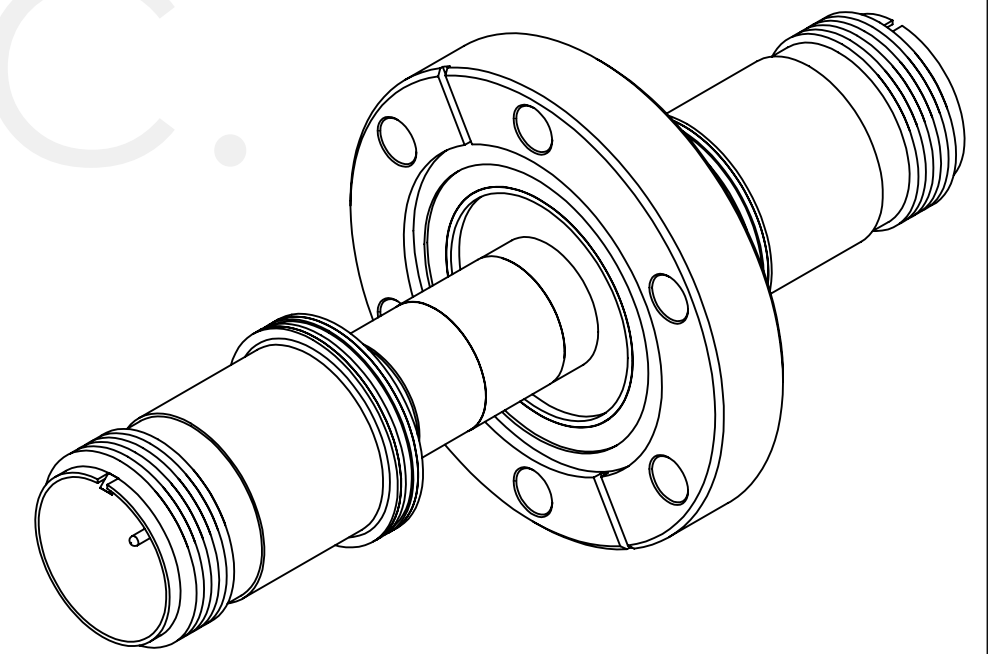

AIR-SIDE CONNECTOR

VACUUM-SIDE CONNECTOR

| PART # | T/C TYPE |
|------------|----------|
| A1323-1-CF | E |
| A1323-2-CF | J |
| A1323-3-CF | K |

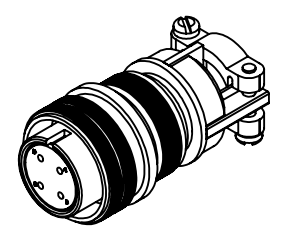
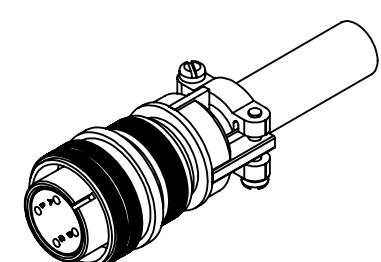

SPECIFICATIONS:

1. TEMPERATURE RATING: -100 TO 450°C
2. LEAK RATE < 1X10-9 ATM CC/SEC HE

MS Series, Thermocouple Feedthrough, 2 Pairs, Double-Ended, w/ Air & Vacuum-side Connectors, 2.75" Conflat Flange

| | | | | | | |
|-----------------------------|--|---|------|--|--|-----------|
| UNLESS OTHERWISE SPECIFIED: | | QUOTATION # | | N/A | | |
| DIMENSIONS ARE IN INCHES | | NAME | DATE | MPF PRODUCTS INC. | | |
| TOLERANCES: | | DRAWN | WJ | | | 9/11/2015 |
| ANGULAR: MACH ± 1/2° | | CHECKED | WJ | | | 9/11/2015 |
| TWO PLACE DECIMAL ± .030 | | ENG APPR. | WJ | | | 9/11/2015 |
| THREE PLACE DECIMAL ± .015 | | THIRD ANGLE: | | TITLE: | | |
| MATERIAL | | | | THERMOCOUPLE, 2 PAIRS, MS CONNECTOR, DOUBLE ENDED, 275CF | | |
| FINISH | | APPLICATION | | DOWNLOADED FROM MPFPI.COM | | |
| PLATING | | NEXT ASSY | | DWG. NO. | | |
| | | USED ON | | REV | | |
| | | SURFACE FINISH: 63 OR BETTER | | A1323-CF | | |
| | | UNLESS OTHERWISE SPECIFIED: | | Friday, February 8, 2019 11:34:34 AM | | |
| | | ALL DIAMETERS CONCENTRIC WITHIN .005. REMOVE ALL BURRS AND SHARP EDGES | | | | |