

# MPF PRODUCTS INC.

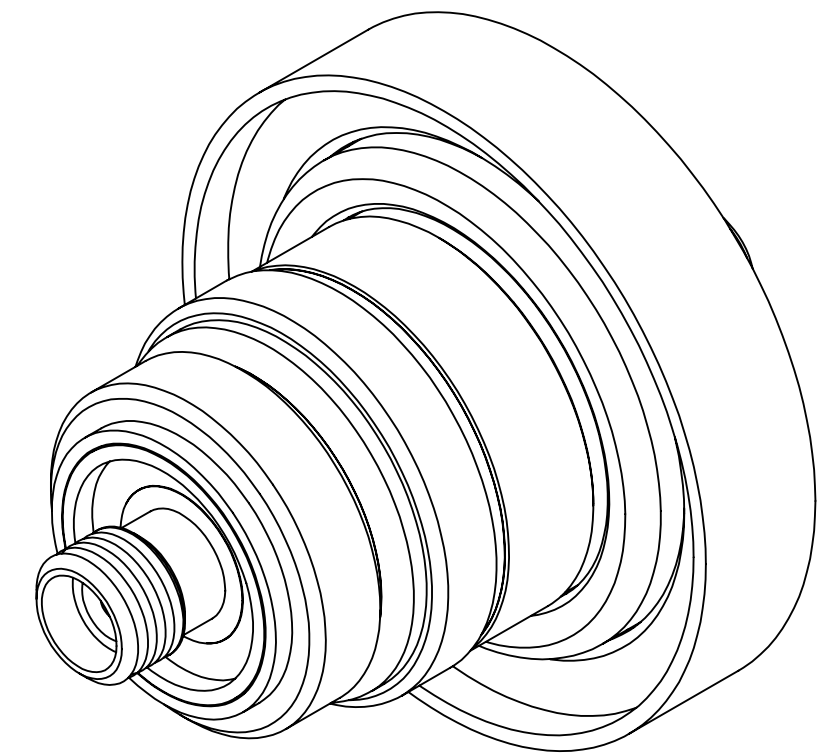

PART #	AIRSIDE CONNECTOR INCLUDED
A1409-1-W	YES
A1409-2-W	NO

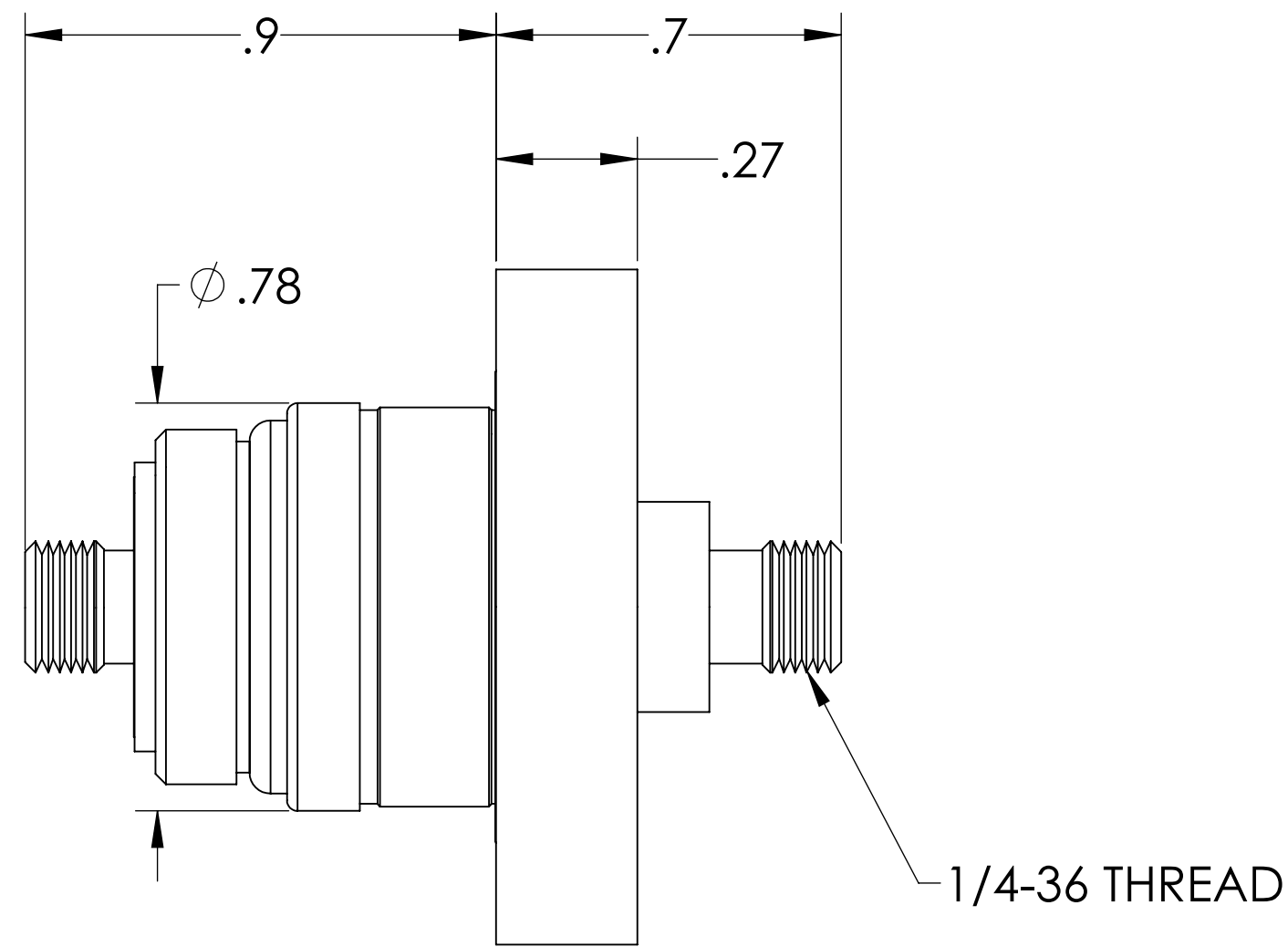
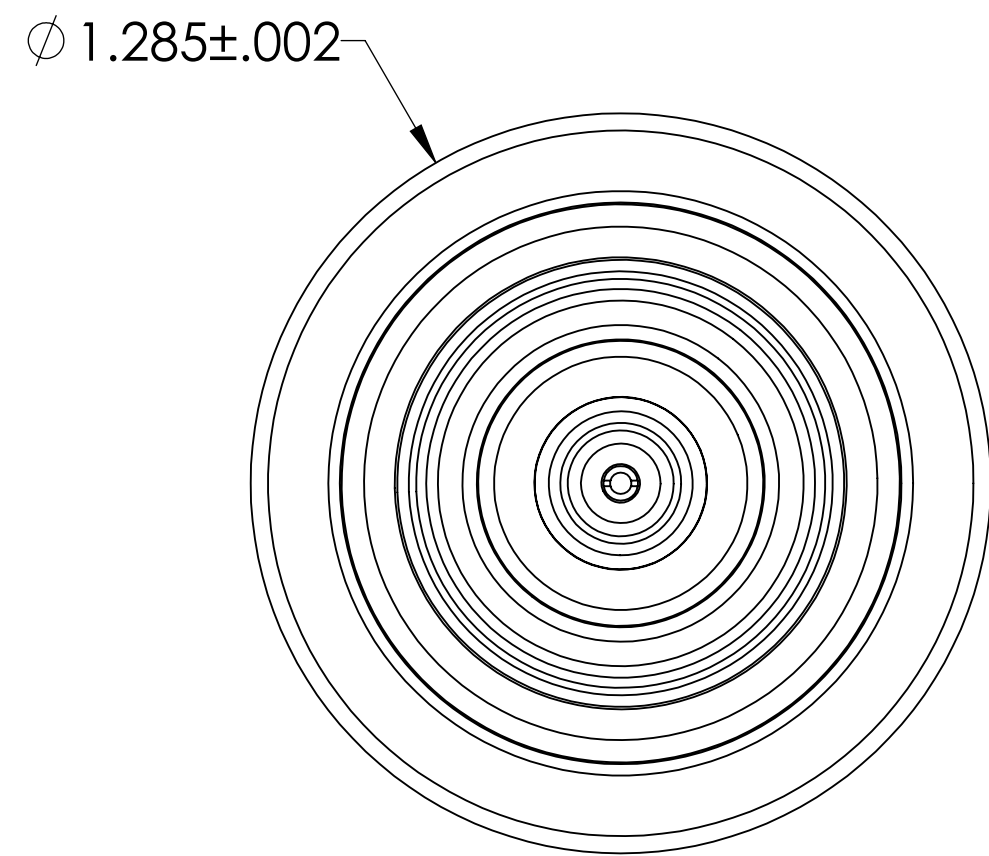
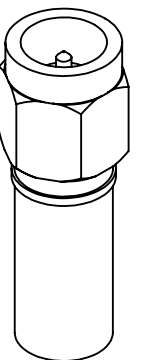

**NOTE:**

1. SHIELD: FLOATING
2. VOLTAGE: 2500 VOLTS DC SHIELD TO GROUND, 700V PIN TO SHEILD
3. CURRENT: 1 AMP
4. TEMPERATURE RATING: -200 TO 450°C (FEEDTHROUGH), 65 TO 165°C ( AIRSIDE CONNECTOR)
5. IMPEDANCE: 50 OHM

SMA Coaxial Feedthrough, 50 Ohm 1 Pin, Floating Shield, Double Ended 1.285" Dia SS Weld Adapter, UHV Compatible

UNLESS OTHERWISE SPECIFIED:		QUOTATION #		N/A	
DIMENSIONS ARE IN INCHES TOLERANCES:		DRAWN	WJ	DATE	9/11/2015
ANGULAR: MACH ± 1/2°		CHECKED	WJ	DATE	9/11/2015
TWO PLACE DECIMAL ± .030		ENG APPR.	WJ	DATE	9/11/2015
THREE PLACE DECIMAL ± .015		THIRD ANGLE:			
MATERIAL					
FINISH		SURFACE FINISH: 63 OR BETTER			
PLATING		UNLESS OTHERWISE SPECIFIED: ALL DIAMETERS CONCENTRIC WITHIN .005. REMOVE ALL BURRS AND SHARP EDGES			
		APPLICATION		TITLE:	
		NEXT ASSY	USED ON	SMA COAXIAL FEEDTHROUGH, 50 OHM, 1 PIN, FLOATING SHIELD, DOUBLE ENDED, 1.285" DIA SS WELD ADAPTER	
				DWG. NO. A1409	
				REV	
				DOWNLOADED FROM MPFPI.COM	
				Friday, January 18, 2019 9:40:38 AM	