

# MPF PRODUCTS INC.

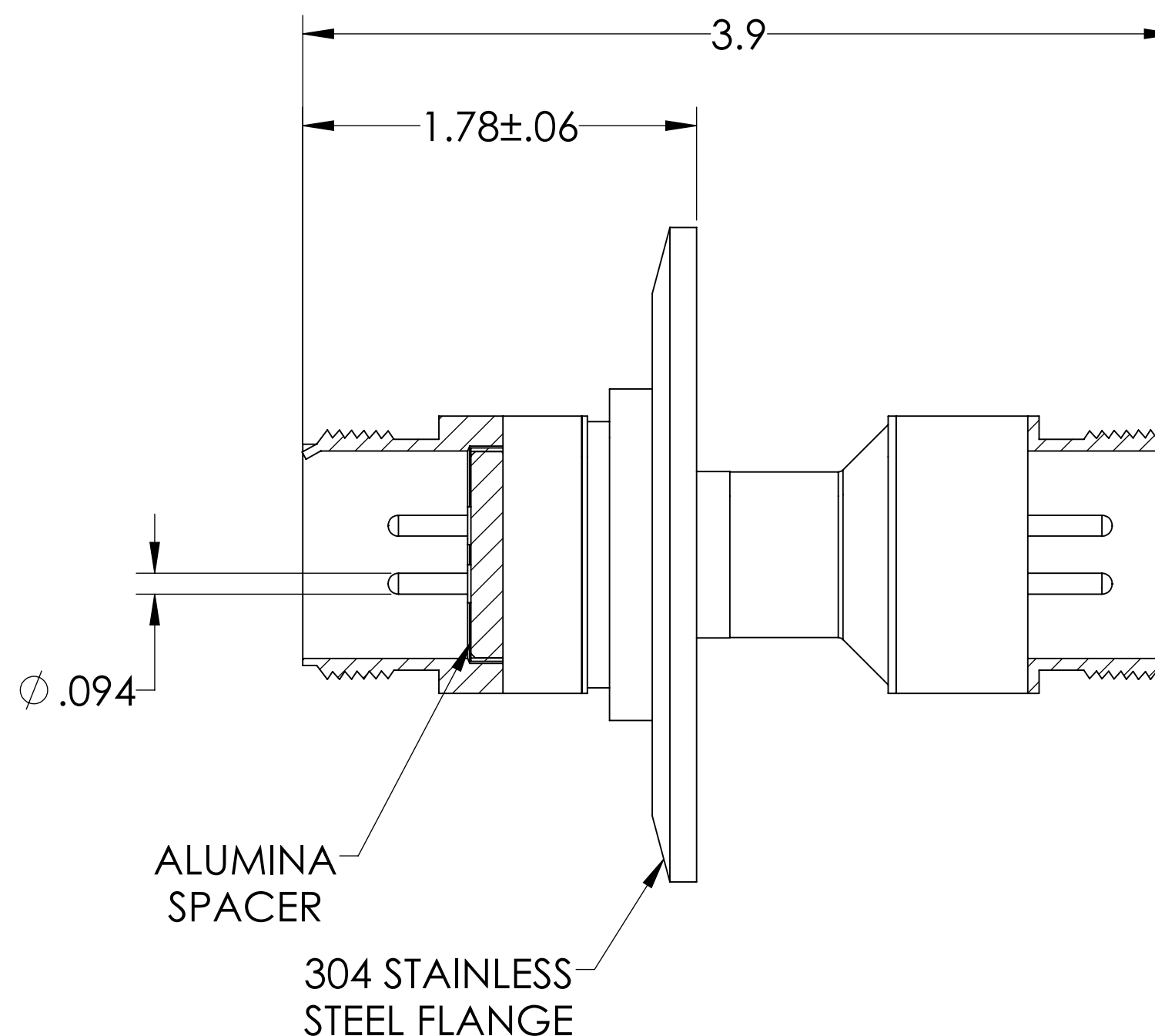

PART NUMBER	CONNECTOR	CONDUCTOR MATERIAL	CURRENT RATING
A14857-1-QF	YES	MOLYBDENUM	28 AMPS
A14857-2-QF	NO	MOLYBDENUM	28 AMPS
A14857-3-QF	YES	NICKEL	16 AMPS
A14857-4-QF	NO	NICKEL	16 AMPS

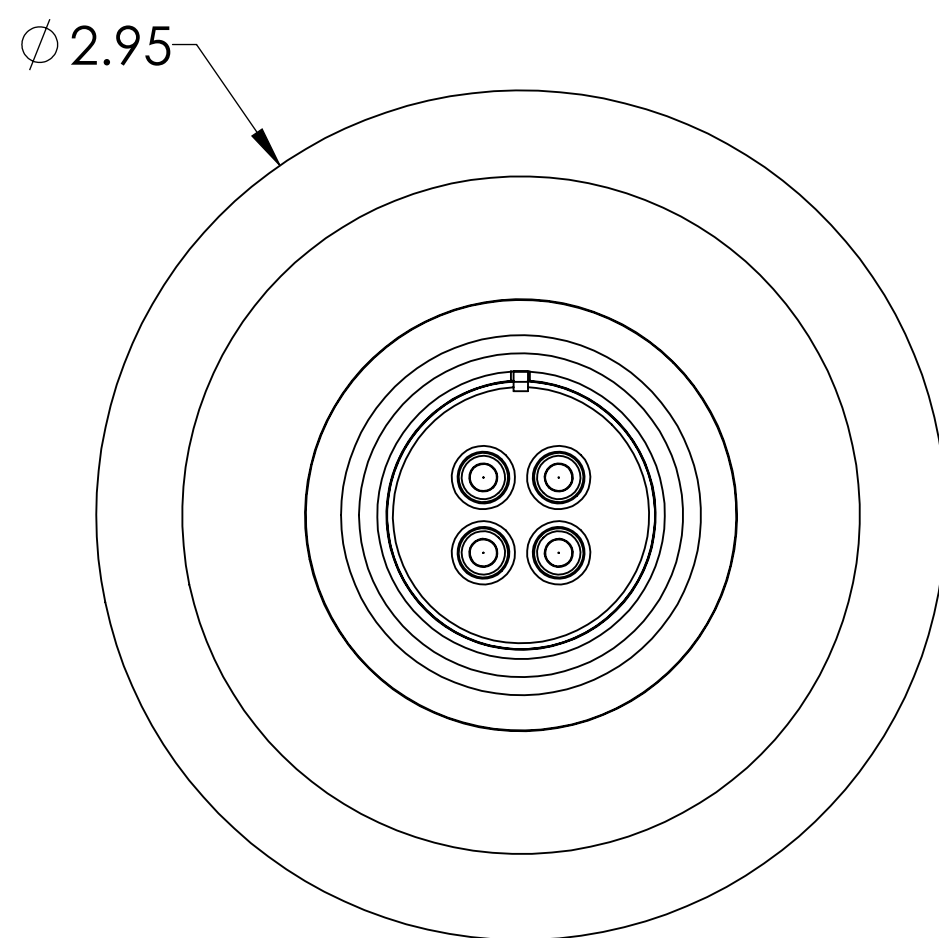
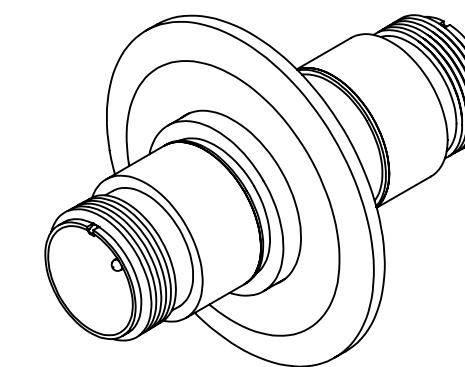
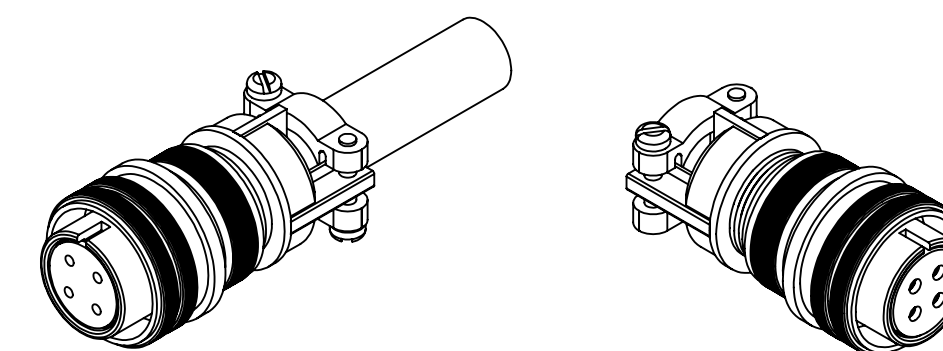

**SPECIFICATIONS:**

1. VOLTAGE: 700 VOLTS DC
2. CURRENT: SEE TABLE
3. TEMPERATURE RATING: -100 TO 450°C WITHOUT CONNECTOR
4. LEAK RATE < 1X10-9 ATM CC/SEC HE

MS Series, Multipin Feedthrough, 4 Pins, 700 Volts, 0.094" Dia Conductors w/ Air-side and Vacuum-side Connector, QF/KF

UNLESS OTHERWISE SPECIFIED:	QUOTATION #	N/A		
DIMENSIONS ARE IN INCHES	NAME	DATE	MPF PRODUCTS INC.	
TOLERANCES:	DRAWN	WJ		9/11/2015
ANGULAR: MACH ± 1/2°	CHECKED	WJ		9/11/2015
TWO PLACE DECIMAL ± .030	ENG APPR.	WJ		9/11/2015
THREE PLACE DECIMAL ± .015	THIRD ANGLE:			
MATERIAL	APPLICATION	TITLE: MULTIPIN, 4 PINS, 700V, QF/KF		
FINISH	NEXT ASSY	USED ON	DWG. NO. A14857 REV.	
PLATING	SURFACE FINISH:	63/ OR BETTER	DOWNLOAD FROM MPFPI.COM Tuesday, March 19, 2019 1:46:26 PM	
	UNLESS OTHERWISE SPECIFIED:	ALL DIAMETERS CONCENTRIC WITHIN .005. REMOVE ALL BURRS AND SHARP EDGES		