

MPF PRODUCTS INC.

FIBER CONSTRUCTION

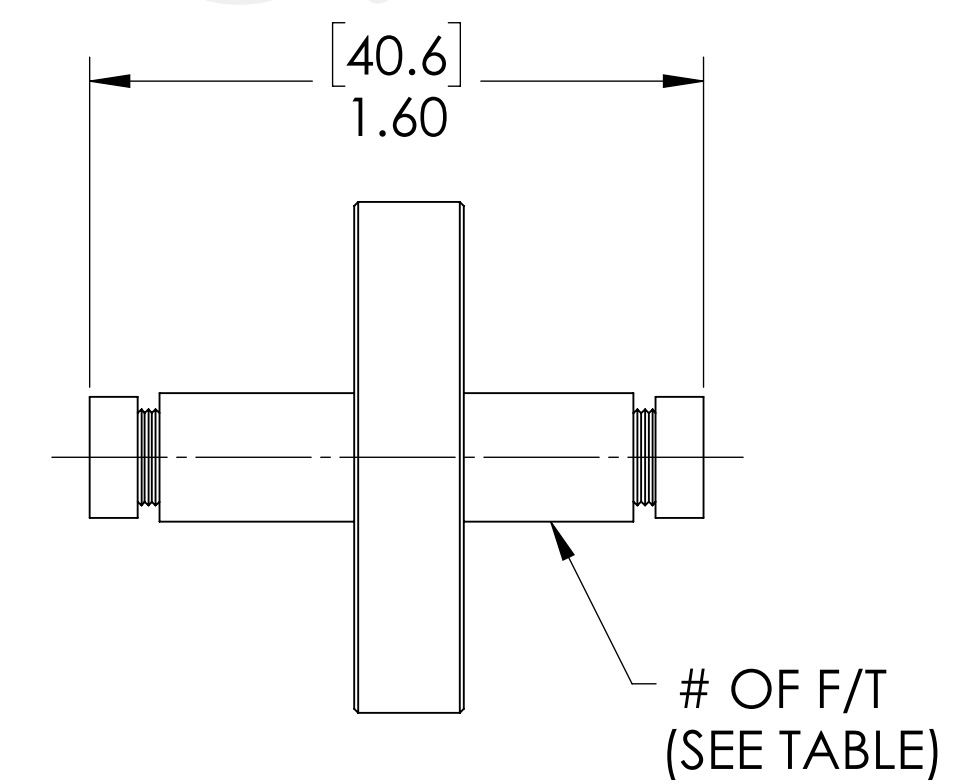
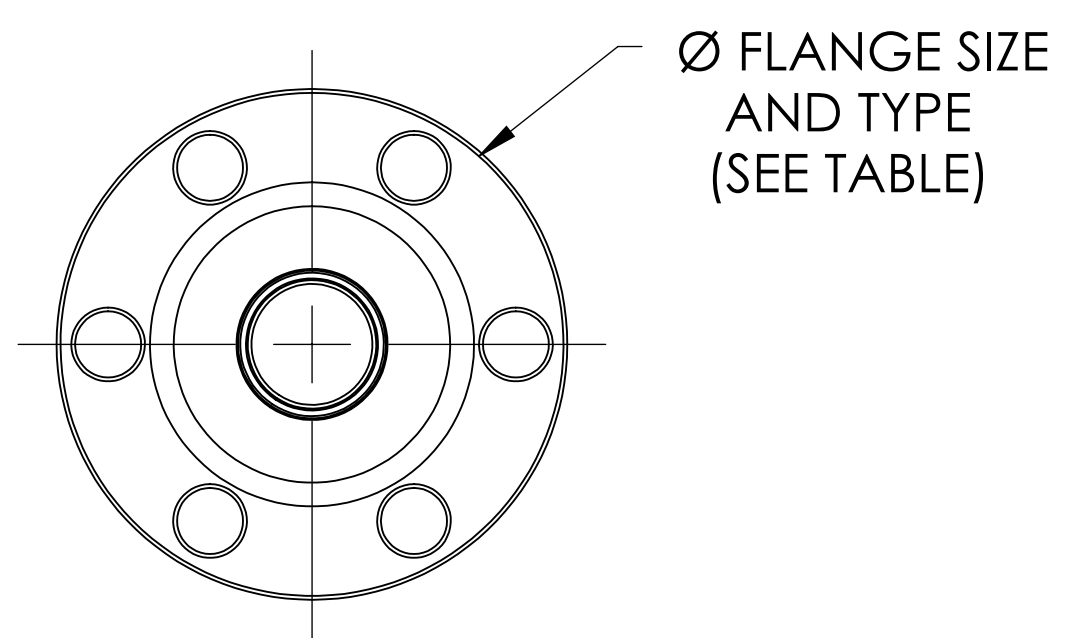
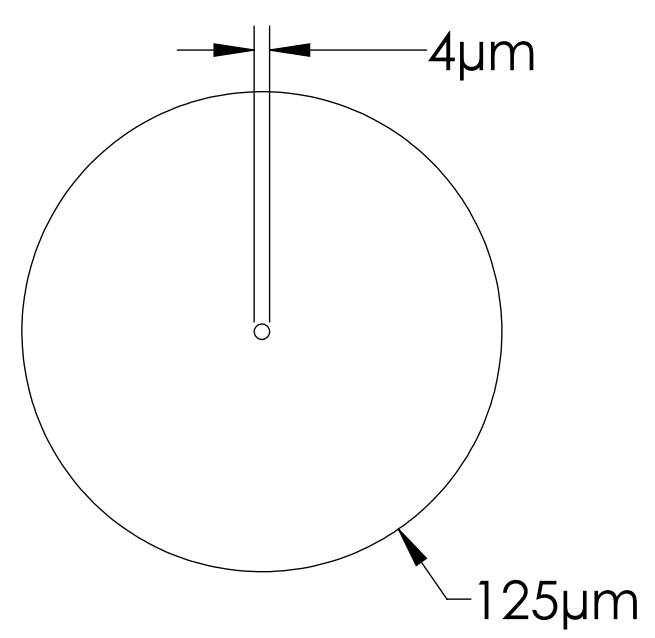

SM633 FC/APC NOTES:

1. WAVELENGTH: 633nm
2. NUMERICAL APERATURE: 0.12
3. CUT-OFF WAVELENGTH: 580nm
4. TYPICAL INSERTION LOSS: <1 dB
5. TYPICAL RETURN LOSS: > 60dB
6. FERRULE: 2.5mm CERAMICS (ZrO2)

PART #	FLANGE SIZE	# OF F/T	CONNECTOR TYPE
A14866-2	1.33" CF	1	FC/APC
A14866-3	2.75" CF	1	FC/APC
A14866-4	2.75" CF	2	FC/APC
A14866-5	2.75" CF	3	FC/APC
A14866-6	4.50" CF	1	FC/APC
A14866-7	4.50" CF	2	FC/APC
A14866-8	4.50" CF	3	FC/APC
A14866-9	4.50" CF	4	FC/APC
A14866-10	4.50" CF	5	FC/APC
A14866-11	1.18" QF	1	FC/APC
A14866-12	1.57" QF	1	FC/APC
A14866-13	2.16" QF	1	FC/APC
A14866-14	2.16" QF	2	FC/APC
A14866-15	2.16" QF	3	FC/APC
A14866-16	2.16" QF	4	FC/APC
A14866-17	2.16" QF	5	FC/APC
A14866-18	2.95" QF	1	FC/APC
A14866-19	2.95" QF	2	FC/APC
A14866-20	2.95" QF	3	FC/APC
A14866-21	2.95" QF	4	FC/APC
A14866-22	2.95" QF	5	FC/APC
A14866-23	2.95" QF	6	FC/APC

Single Mode 633nm Fiber Optic Feedthrough, FC/APC Connector

UNLESS OTHERWISE SPECIFIED:		QUOTATION #		N/A	
DIMENSIONS ARE IN INCHES TOLERANCES:		DRAWN	NAME	DATE	MPF PRODUCTS INC.
ANGULAR: MACH ± 1/2°		WJ	WJ	9/11/2015	
TWO PLACE DECIMAL ± .030		CHECKED		9/11/2015	
THREE PLACE DECIMAL ± .015		ENG APPR.	WJ	9/11/2015	
MATERIAL		THIRD ANGLE:		TITLE:	
				SINGLE MODE FIBER OPTIC FEEDTHROUGH (FIBER SM633)	
FINISH		APPLICATION		DOWNLOADED FROM MPFPI.COM	
PLATING		NEXT ASSY		DWG. NO.	
		USED ON		A14866	
		SURFACE FINISH: 63 OR BETTER		REV	
		UNLESS OTHERWISE SPECIFIED:		Tuesday, July 23, 2019 12:46:16 PM	
		ALL DIAMETERS CONCENTRIC WITHIN .005. REMOVE ALL BURRS AND SHARP EDGES			