

MPF PRODUCTS INC.

FIBER CONSTRUCTION

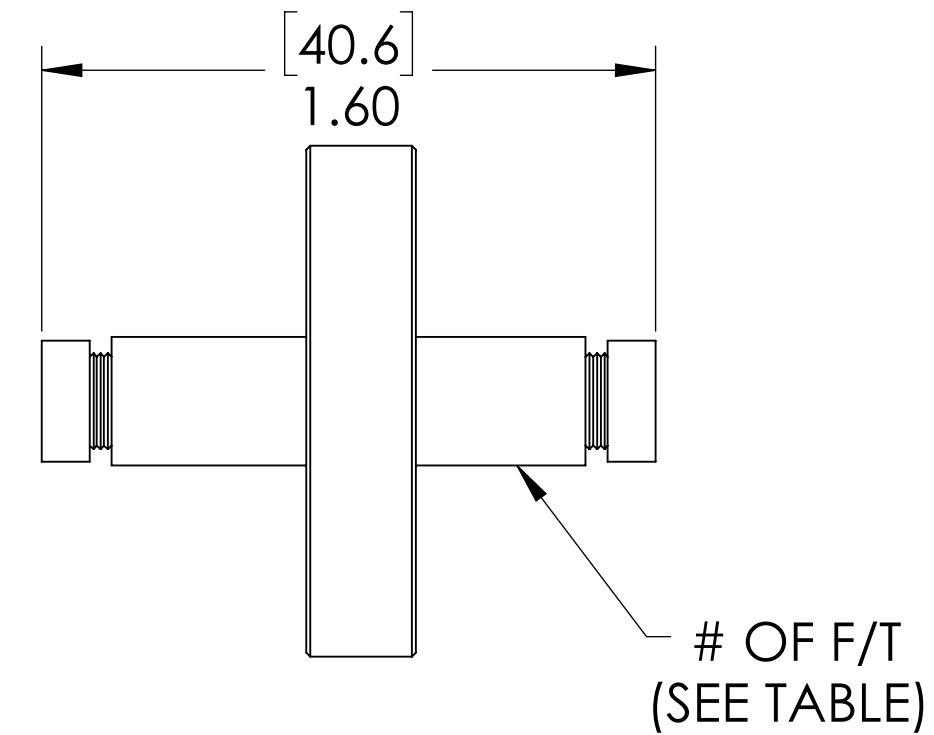
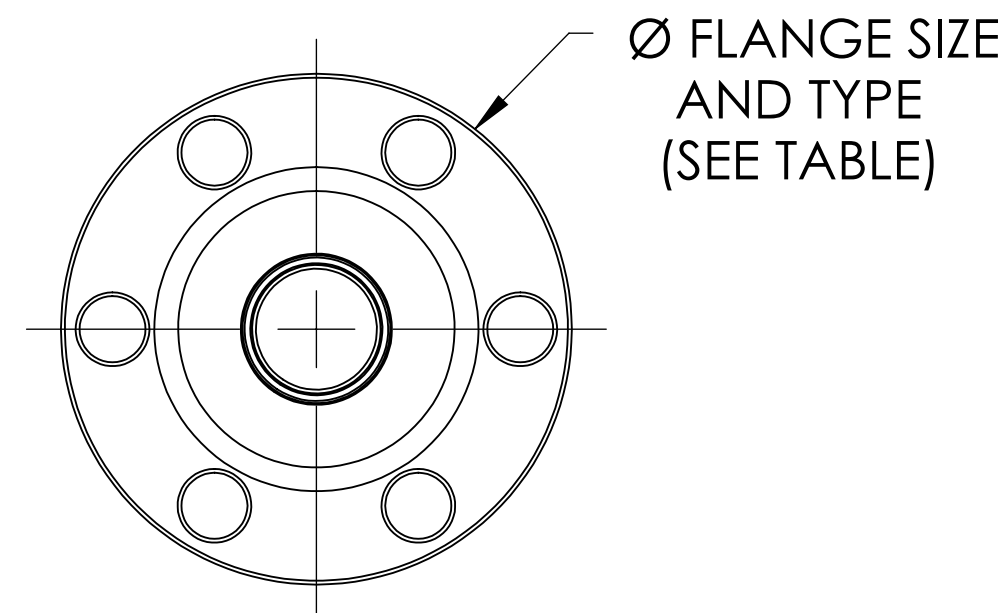
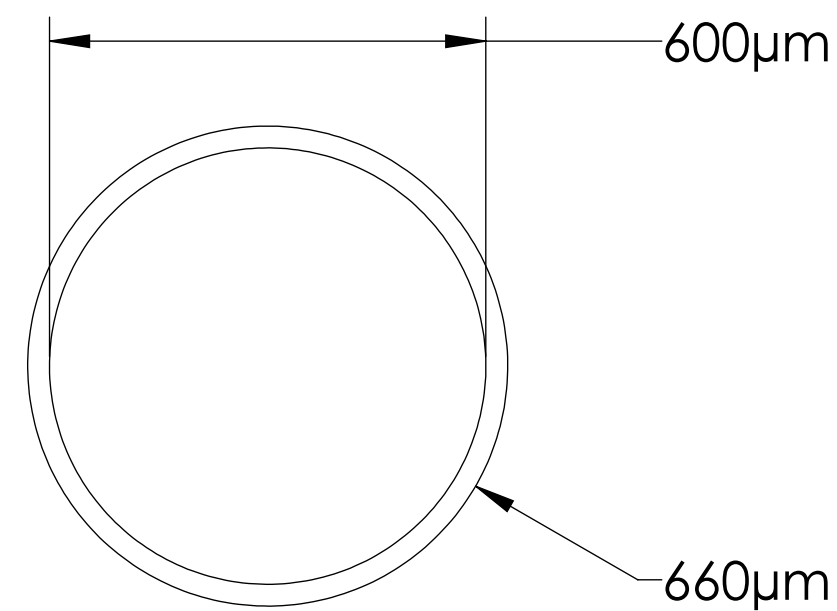

PART #	FLANGE SIZE	# OF F/T	CONNECTOR TYPE	FIBER TYPE
A14878-2	1.33" CF	1	FSMA	600µm UV
A14878-3	2.75" CF	1	FSMA	600µm UV
A14878-4	2.75" CF	2	FSMA	600µm UV
A14878-5	2.75" CF	3	FSMA	600µm UV
A14878-6	1.18" QF	1	FSMA	600µm UV
A14878-7	1.57" QF	1	FSMA	600µm UV
A14878-8	2.16" QF	1	FSMA	600µm UV
A14878-9	2.16" QF	2	FSMA	600µm UV
A14878-10	2.16" QF	3	FSMA	600µm UV
A14878-11	2.16" QF	4	FSMA	600µm UV
A14878-12	2.16" QF	5	FSMA	600µm UV
A14878-13	2.95" QF	1	FSMA	600µm UV
A14878-14	2.95" QF	2	FSMA	600µm UV
A14878-15	2.95" QF	3	FSMA	600µm UV
A14878-16	2.95" QF	4	FSMA	600µm UV
A14878-17	2.95" QF	5	FSMA	600µm UV
A14878-18	2.95" QF	6	FSMA	600µm UV

PART #	FLANGE SIZE	# OF F/T	CONNECTOR TYPE	FIBER TYPE
A14878-20	1.33" CF	1	FSMA	600µm IR
A14878-21	2.75" CF	1	FSMA	600µm IR
A14878-22	2.75" CF	2	FSMA	600µm IR
A14878-23	2.75" CF	3	FSMA	600µm IR
A14878-24	1.18" QF	1	FSMA	600µm IR
A14878-25	1.57" QF	1	FSMA	600µm IR
A14878-26	2.16" QF	1	FSMA	600µm IR
A14878-27	2.16" QF	2	FSMA	600µm IR
A14878-28	2.16" QF	3	FSMA	600µm IR
A14878-29	2.16" QF	4	FSMA	600µm IR
A14878-30	2.16" QF	5	FSMA	600µm IR
A14878-31	2.95" QF	1	FSMA	600µm IR
A14878-32	2.95" QF	2	FSMA	600µm IR
A14878-33	2.95" QF	3	FSMA	600µm IR
A14878-34	2.95" QF	4	FSMA	600µm IR
A14878-35	2.95" QF	5	FSMA	600µm IR
A14878-36	2.95" QF	6	FSMA	600µm IR

MM600 UV FSMA NOTES:

1. WAVELENGTH RANGE: 190nm TO 1100nm
2. NUMERICAL APERTURE: 0.22
3. TYPICAL INSERTION LOSS: <1.2 dB
4. FERRULE: 2.5mm CERAMICS (ZrO2)

MM600 IR FSMA NOTES:

1. WAVELENGTH RANGE: 400 TO 2400nm
2. NUMERICAL APERTURE: 0.22
3. TYPICAL INSERTION LOSS: <1.2 dB
4. FERRULE: 2.5mm CERAMICS (ZrO2)

Multimode (MM600) Fiber Optic Feedthrough, FSMA Connector

UNLESS OTHERWISE SPECIFIED:		QUOTATION #		N/A	
DIMENSIONS ARE IN INCHES TOLERANCES:		NAME	DATE	MPF PRODUCTS INC. TITLE: FSMA 905 FIBER OPTIC FEEDTHROUGH (FIBER MM600)	
ANGULAR: MACH ± 1/2°		DRAWN	9/11/2015		
TWO PLACE DECIMAL ± .030		CHECKED	9/11/2015		
THREE PLACE DECIMAL ± .015		ENG APPR.	9/11/2015		
MATERIAL		THIRD ANGLE:		DOWNLOAD FROM MPFPI.COM DWG. NO. A14878 REV	
FINISH					
PLATING		APPLICATION NEXT ASSY USED ON			
SURFACE FINISH:		63/ OR BETTER		UNLESS OTHERWISE SPECIFIED: ALL DIAMETERS CONCENTRIC WITHIN .005. REMOVE ALL BURRS AND SHARP EDGES	
TUESDAY, JULY 23, 2019 12:50:53 PM					