

MPF PRODUCTS INC.

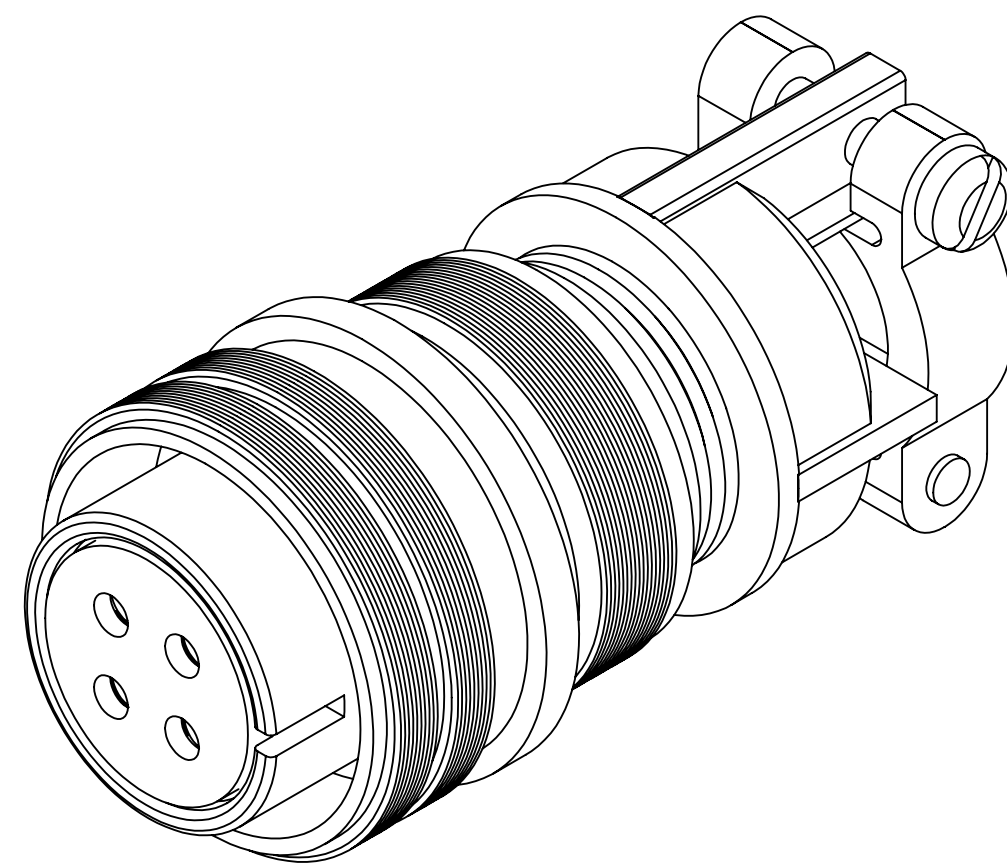

SPECIFICATIONS:
 1. TEMPERATURE RATING: UP TO 350 °C

MS Series Vacuum-side Connector, 4 Pins, 700 Volts, 28 Amps per Pin, Accepts 0.092" or 0.094" Dia Pins

UNLESS OTHERWISE SPECIFIED:		QUOTATION #		N/A	
DIMENSIONS ARE IN INCHES TOLERANCES:		NAME	DATE	MPF PRODUCTS INC. TITLE: MS CIRCULAR CONNECTOR, 700V, 28A, 4 PINS	
ANGULAR: MACH ± 1/2°		DRAWN	9/11/2015		
TWO PLACE DECIMAL ± .030		CHECKED	9/11/2015		
THREE PLACE DECIMAL ± .015		ENG APPR.	9/11/2015		
MATERIAL		THIRD ANGLE:		DOWNLOADED FROM MPFPI.COM DWG. NO. A15649-1-CN REV	
		APPLICATION			
		NEXT ASSY	USED ON		
FINISH		SURFACE FINISH: $\sqrt{32}$ OR BETTER			
PLATING		UNLESS OTHERWISE SPECIFIED:			
		ALL DIAMETERS CONCENTRIC WITHIN .005. REMOVE ALL BURRS AND SHARP EDGES		Thursday, January 14, 2021 11:54:28 AM	