

MPF PRODUCTS INC

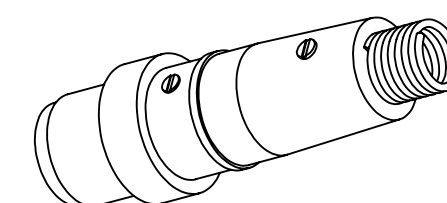
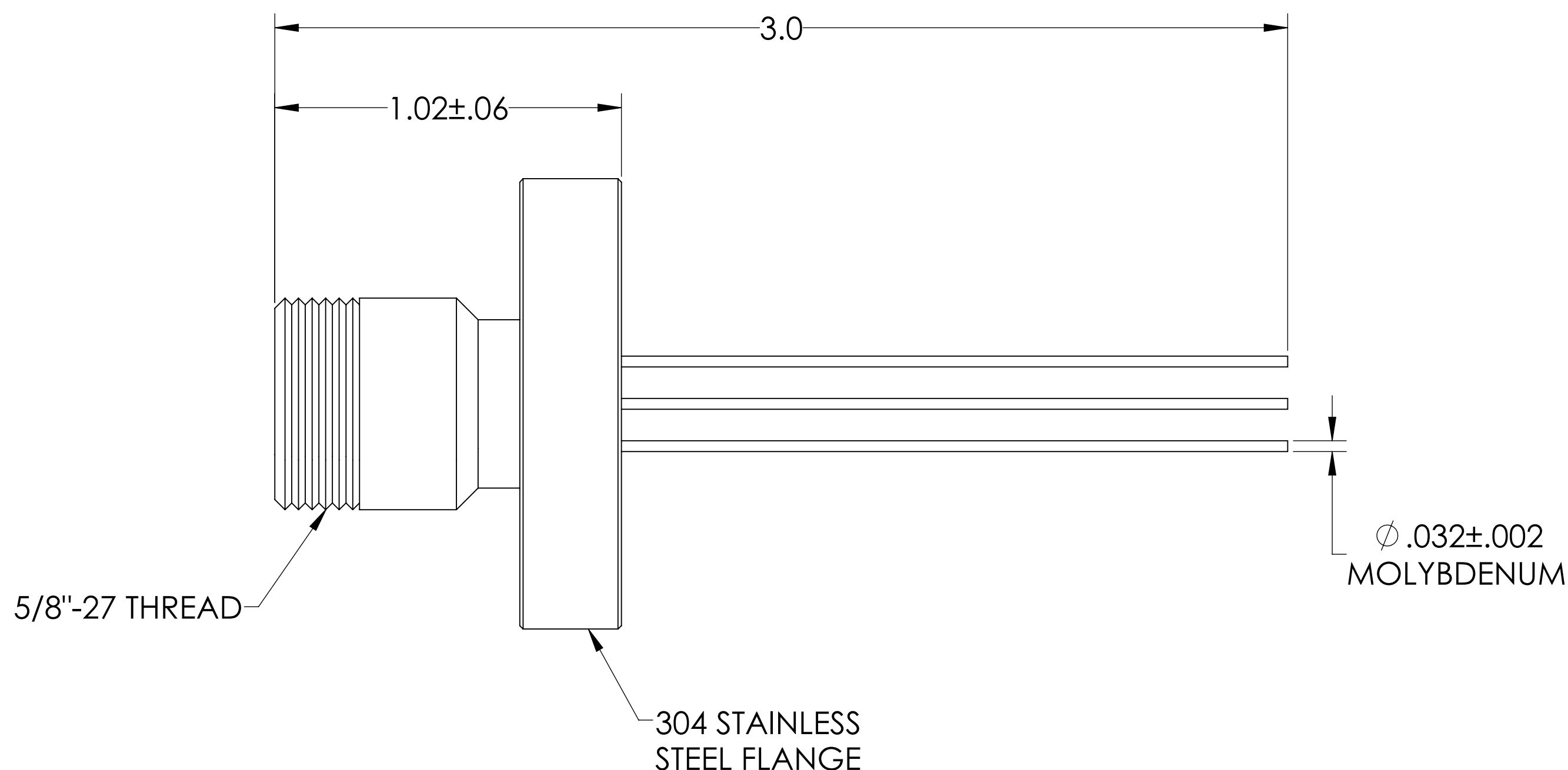
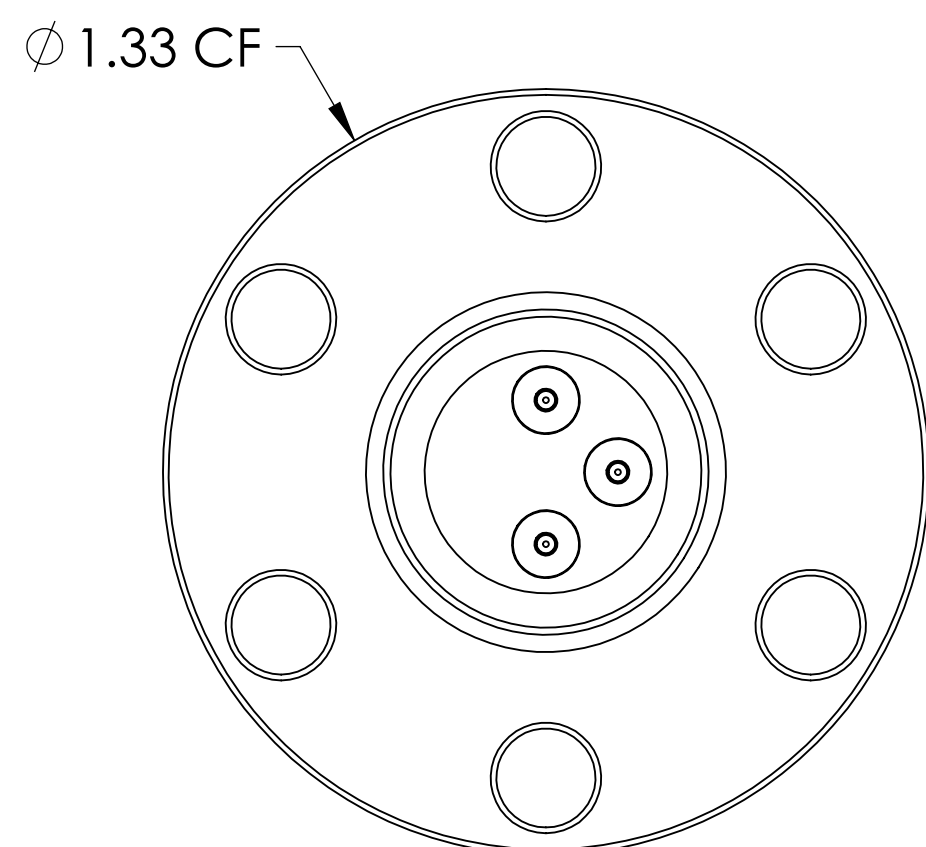
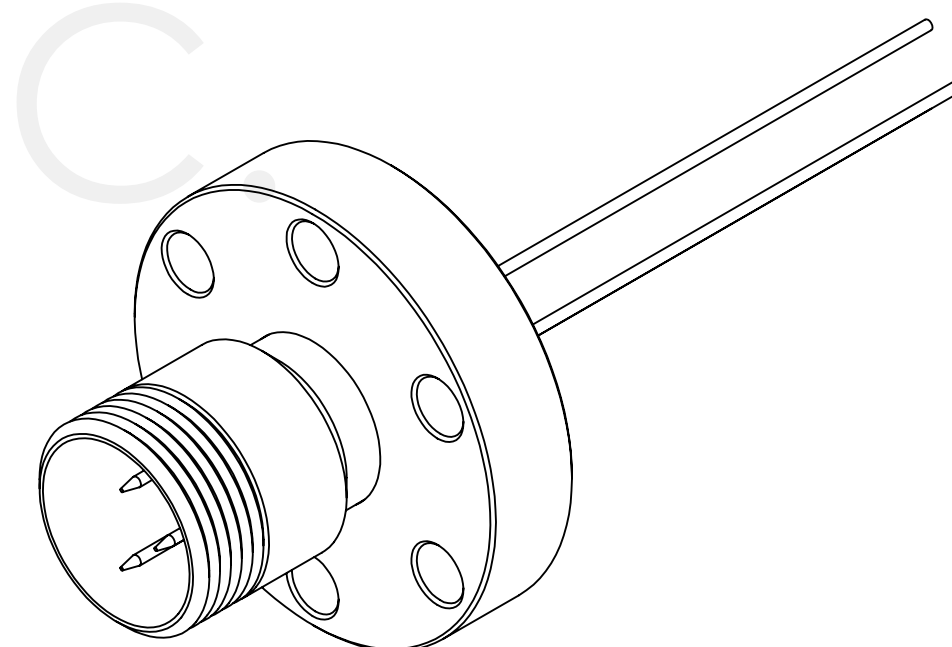

SPECIFICATIONS:

1. VOLTAGE: 500 VOLTS DC
2. CURRENT: 3.5 AMPS PER PIN
3. TEMPERATURE RATING: -100 TO 450°C WITHOUT CONNECTOR
4. LEAK RATE < 1X10-9 ATM CC/SEC HE

Multipin Feedthrough, 3 Pins, 500 Volts, 3.5 Amps per Pin, 0.032" Dia Conductors, 1.33" Conflat Flange

UNLESS OTHERWISE SPECIFIED:	QUOTATION #		N/A
DIMENSIONS ARE IN INCHES	NAME	DATE	MPF PRODUCTS INC.
TOLERANCES:	DRAWN	9/11/2015	
ANGULAR: MACH ± 1/2°	CHECKED	9/11/2015	
TWO PLACE DECIMAL ± .030	ENG APPR.	9/11/2015	
THREE PLACE DECIMAL ± .015	THIRD ANGLE:		MULTIPIN, 7 PINS, 500V, 3.5 A, 1.33" CONFLAT FLANGE
MATERIAL			
FINISH	APPLICATION		DOWNLOADED FROM MPFPI.COM
PLATING	NEXT ASSY USED ON		
	SURFACE FINISH: 63 OR BETTER		DWG. NO.
	UNLESS OTHERWISE SPECIFIED:		A1621-1-CF
	ALL DIAMETERS CONCENTRIC WITHIN .005. REMOVE ALL BURRS AND SHARP EDGES		REV
			Monday, January 28, 2019 8:50:54 AM