

MPF PRODUCTS INC.

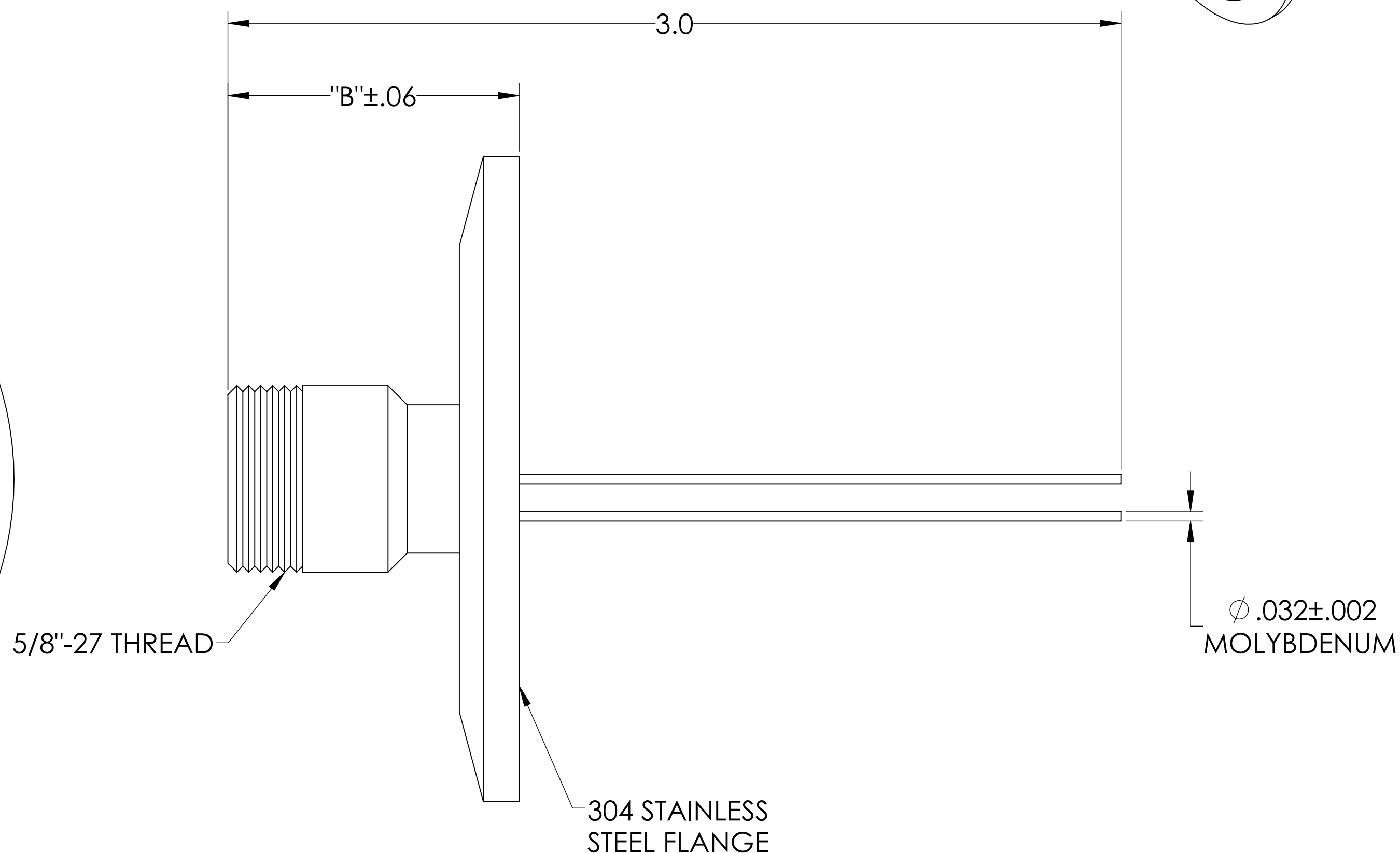

PART #	"A"	"B"
A1622-1-QF	1.18	1.08
A1622-2-QF	2.16	.98

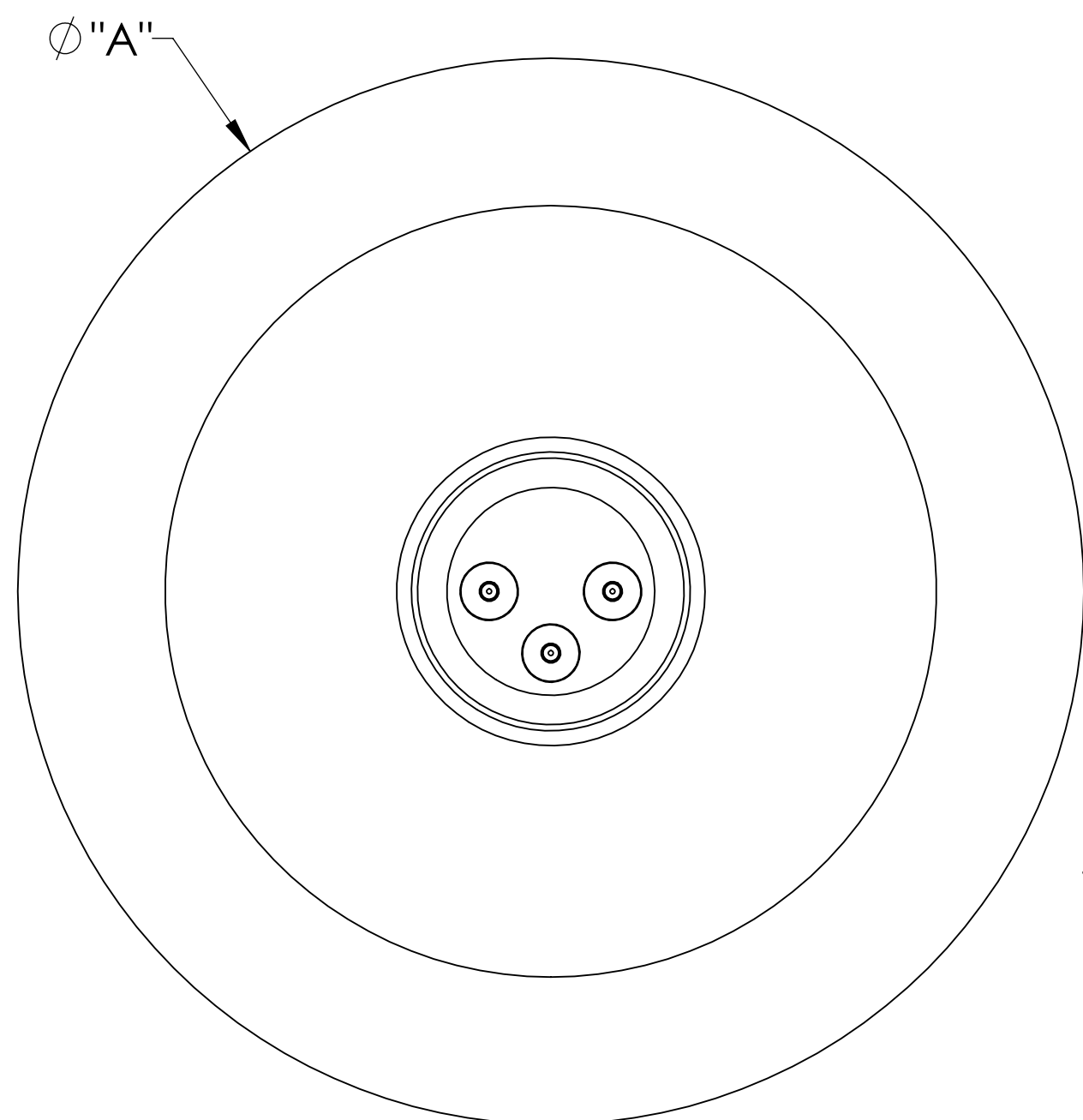
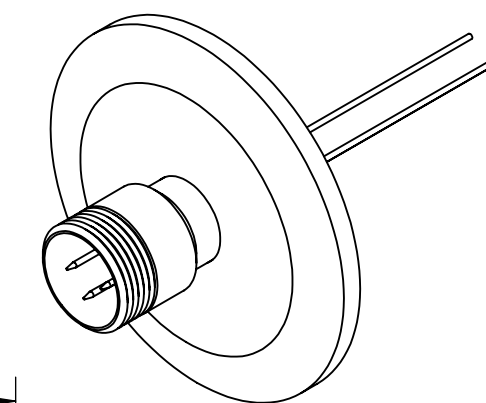
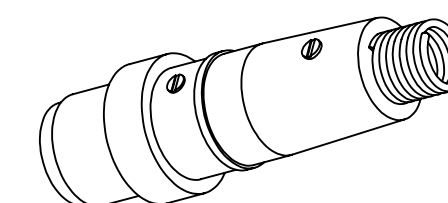

SPECIFICATIONS:

1. VOLTAGE: 500 VOLTS DC
2. CURRENT: 3.5 AMPS PER PIN
3. TEMPERATURE RATING: -100 TO 450°C WITHOUT CONNECTOR
4. LEAK RATE < 1X10-9 ATM CC/SEC HE

Multipin Feedthrough, 3 Pins, 500 Volts, 3.5 Amps per Pin, 0.032" Dia Conductors, QF/KF

UNLESS OTHERWISE SPECIFIED:		QUOTATION #		N/A	
DIMENSIONS ARE IN INCHES		NAME	DATE	MPF PRODUCTS INC.	
TOLERANCES:		DRAWN	9/11/2015		
ANGULAR: MACH ± 1/2°		CHECKED	9/11/2015		
TWO PLACE DECIMAL ± .030		ENG APPR.	9/11/2015		
THREE PLACE DECIMAL ± .015		THIRD ANGLE:		MULTIPIN, 7 PINS, 500V, 3.5 A, QF/KF	
MATERIAL					
FINISH		APPLICATION		DOWNLOADED FROM MPFPI.COM	
PLATING		SURFACE FINISH: 63 OR BETTER		DWG. NO. A1622	
		UNLESS OTHERWISE SPECIFIED:		REV	
		ALL DIAMETERS CONCENTRIC WITHIN .005. REMOVE ALL BURRS AND SHARP EDGES		Monday, January 28, 2019 8:57:29 AM	