

MPF PRODUCTS INC.

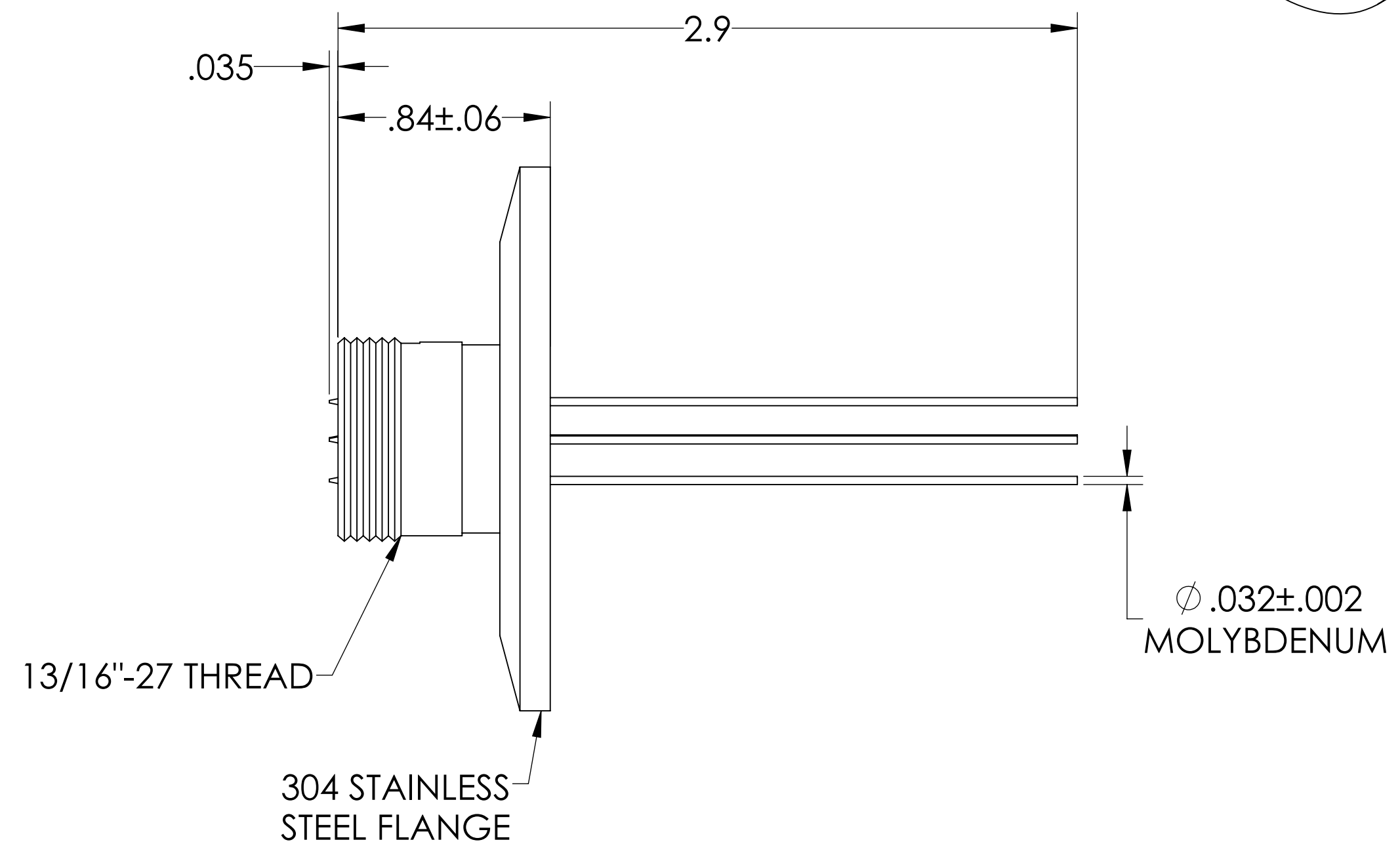
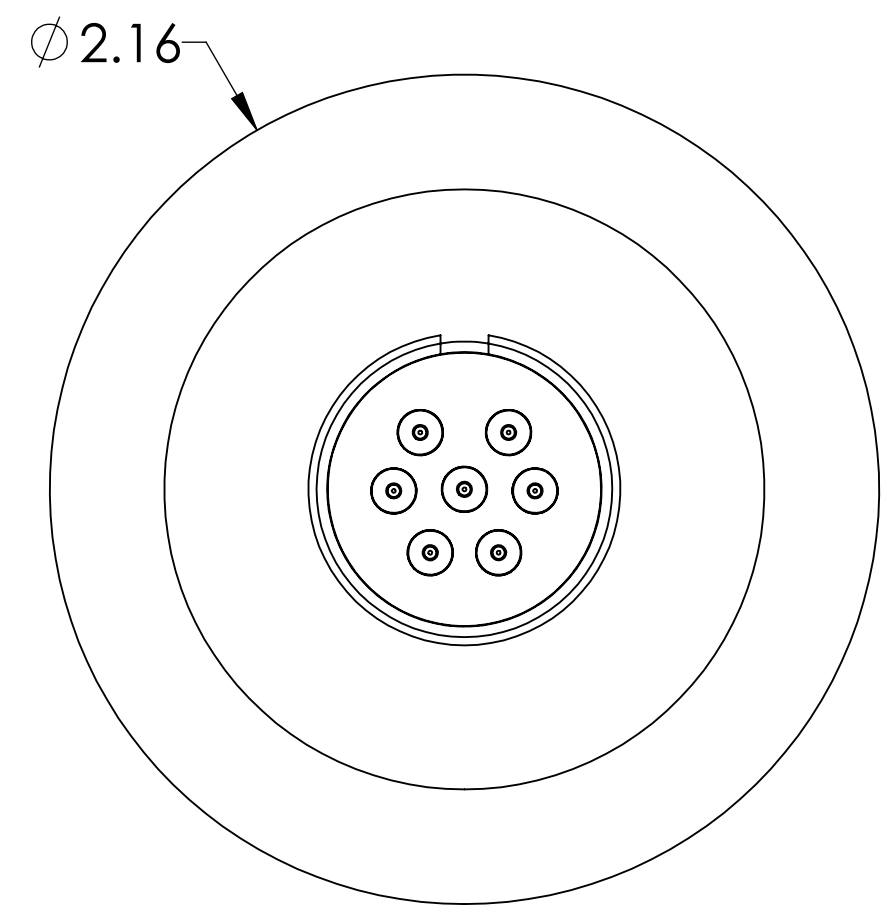
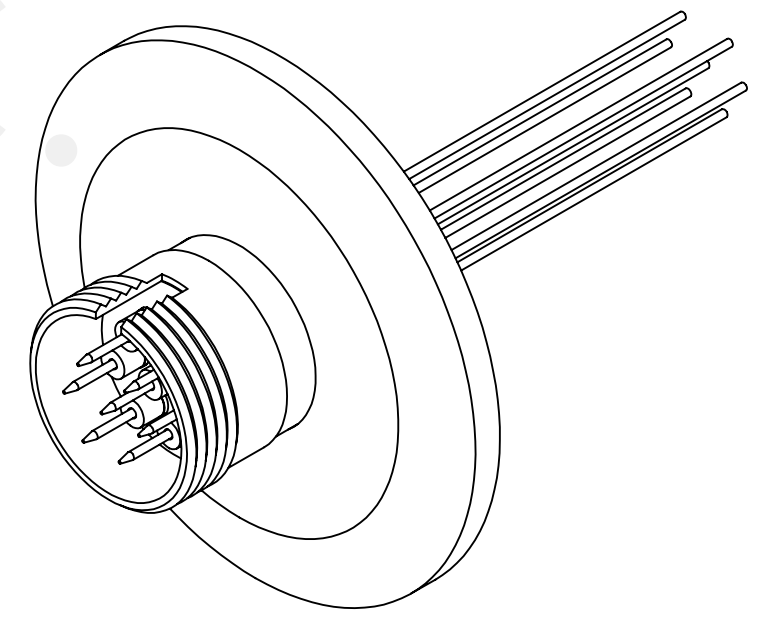

PART #	# OF PINS	"A" DIM	"B" DIM
A1623-1-QF	5	1.18	1.34
A1623-2-QF	5	2.16	.84
A1623-3-QF	5	2.95	.84
A1623-4-QF	7	1.18	1.34
A1623-5-QF	7	2.16	.84
A1623-6-QF	7	2.95	.84

SPECIFICATIONS:

1. VOLTAGE: 500 VOLTS DC
2. CURRENT: 3.5 AMPS PER PIN
3. TEMPERATURE RATING: -100 TO 450°C WITHOUT CONNECTOR
4. LEAK RATE < 1X10-9 ATM CC/SEC HE

MS Series, Multipin Feedthrough, 500 Volts, 3.5 Amps per Pin, w/ Air-side Connector, QF/KF

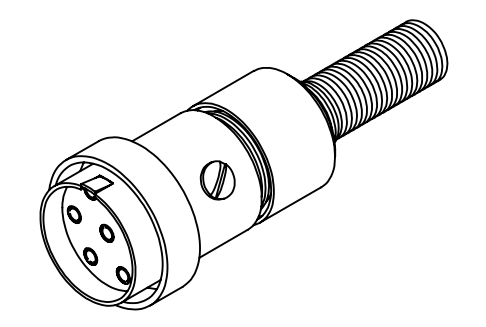

UNLESS OTHERWISE SPECIFIED:		QUOTATION #		N/A	
DIMENSIONS ARE IN INCHES TOLERANCES:		NAME	DATE	MPF PRODUCTS INC.	
ANGULAR: MACH ± 1/2°		DRAWN	9/11/2015		
TWO PLACE DECIMAL ± .030		CHECKED	9/11/2015		
THREE PLACE DECIMAL ± .015		ENG APPR.	9/11/2015		
MATERIAL		THIRD ANGLE:		MULTIPIN, 500V, 3.5 A, QF/KF	
FINISH		APPLICATION			
PLATING		NEXT ASSY USED ON			
SURFACE FINISH: 63 OR BETTER		SURFACE FINISH: 63 OR BETTER		DOWNLOADED FROM MPFPI.COM	
UNLESS OTHERWISE SPECIFIED:		UNLESS OTHERWISE SPECIFIED:		DWG. NO. A1623	
ALL DIAMETERS CONCENTRIC WITHIN .005. REMOVE ALL BURRS AND SHARP EDGES		TUESDAY, JANUARY 29, 2019 11:28:13 AM		REV	