

# MPF PRODUCTS INC.

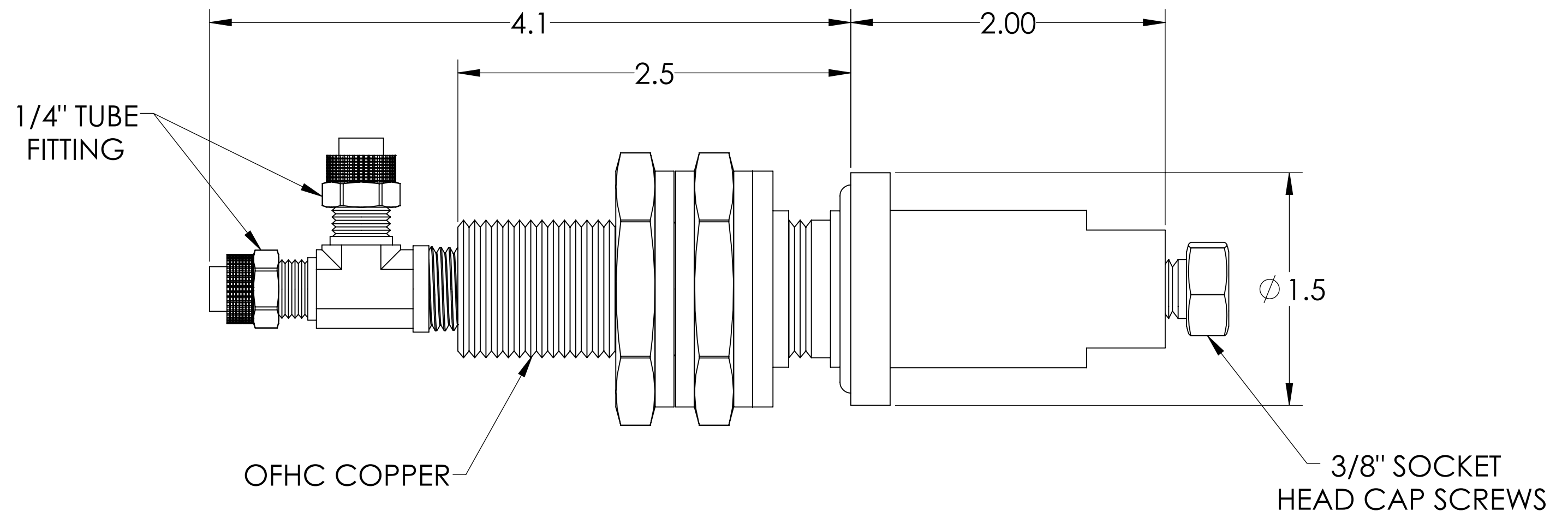
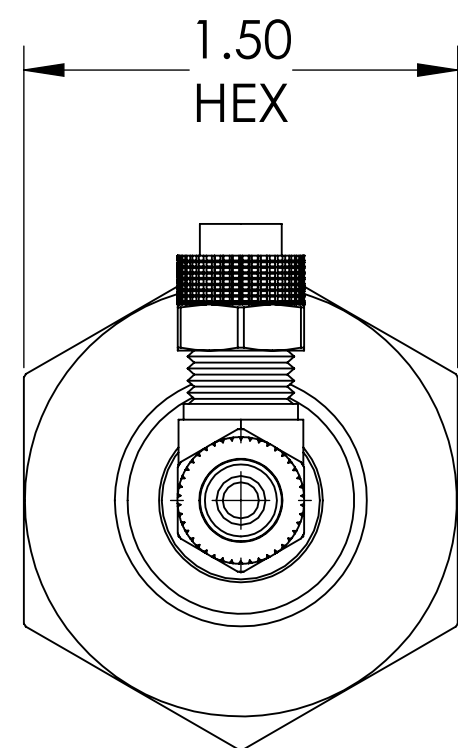
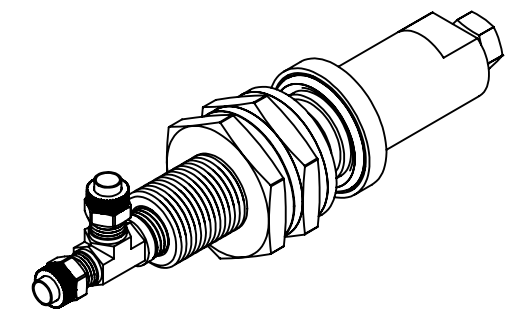

**NOTE:**

1. VOLTAGE: 50 VOLTS DC
2. CURRENT: 1000 AMPS
3. TEMPERATURE RATING: -100 TO 450°C

Power Feedthrough, 50 Volts, 1000 Amps, 1 Pin, Copper Conductor, Water Cooled W/ T-Fitting, 7/8" Baseplate Bolt, UHV Rated, Bakeable to 450°C

UNLESS OTHERWISE SPECIFIED:		QUOTATION #		N/A	
DIMENSIONS ARE IN INCHES TOLERANCES:		NAME	DATE	MPF PRODUCTS INC.	
ANGULAR: MACH ± 1/2°		DRAWN	9/11/2015		
TWO PLACE DECIMAL ± .030		CHECKED	9/11/2015		
THREE PLACE DECIMAL ± .015		ENG APPR.	9/11/2015		
MATERIAL		THIRD ANGLE:		TITLE: POWER FEEDTHROUGH, 50 VOLTS, 1000 AMPS, 1 PIN, WATER COOLED, 7/8" BASEPLATE  DOWNLOAD FROM MPFPI.COM DWG. NO. A1658-1-BP	
FINISH					
PLATING		APPLICATION NEXT ASSY USED ON			
		SURFACE FINISH: 63 OR BETTER UNLESS OTHERWISE SPECIFIED: ALL DIAMETERS CONCENTRIC WITHIN .005. REMOVE ALL BURRS AND SHARP EDGES			
		Tuesday, January 22, 2019 11:11:10 AM		REV	