

## MPF PRODUCTS INC.

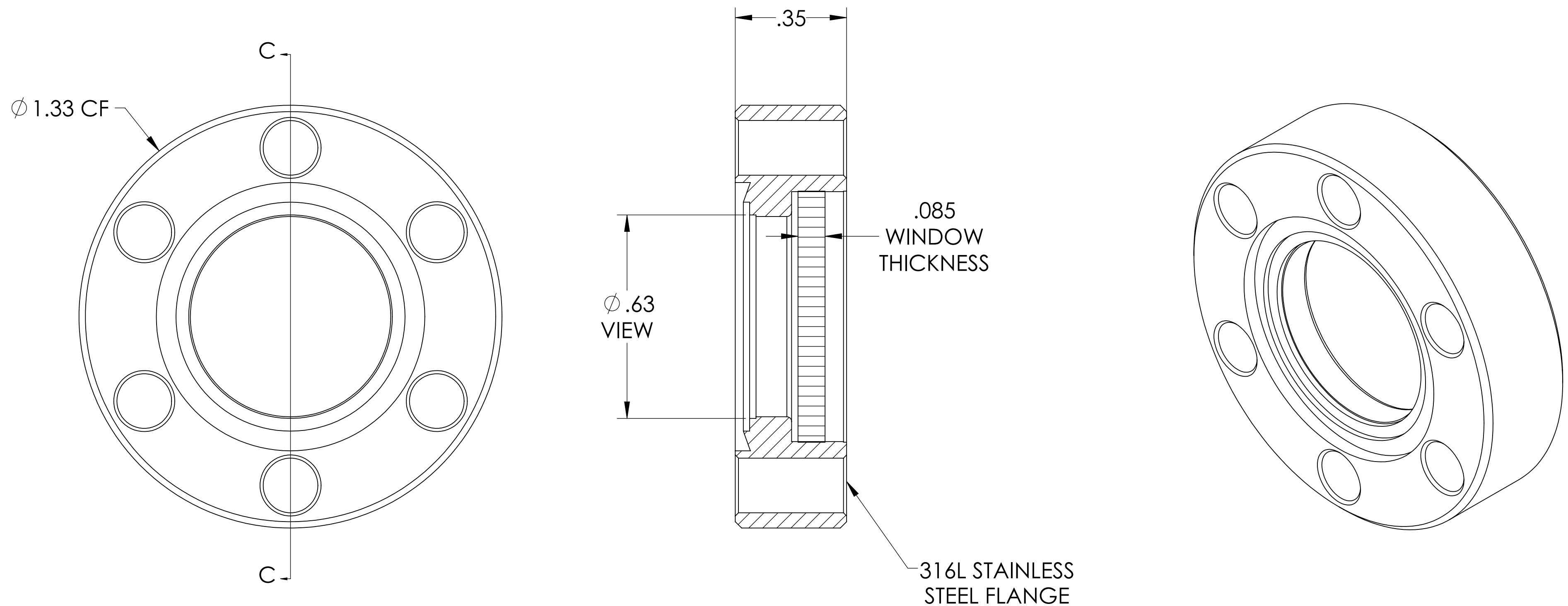

## SPECIFICATIONS:

1. MATERIAL: CORNING HPFS 7980 FUSED SILICA OR EQUIVALENT
2. TWD <math>< \lambda/4 @ 632\text{nm}</math> (PEAK TO VALLEY)
3. PARALLELISM <math>< 10</math> ARC SECONDS
4. SURFACE FINISH: 20/10 SCRATCH-DIG
5. THERMAL RANGE: -100 °C TO 200 °C
6. HOMOGENEITY GRADE: A
7. INCLUSION CLASS: 0
8. LEAK RATE <math>< 1 \times 10^{-9}</math> ATM-CC/SEC HE

Laser Grade Fused Silica Viewport, Zero Length Profile, 0.63" View Dia, 1.33" Conflat Flange

UNLESS OTHERWISE SPECIFIED:	QUOTATION #	N/A	
DIMENSIONS ARE IN INCHES TOLERANCES:	DRAWN	NAME	DATE
ANGULAR: MACH $\pm 1/2^\circ$	WJ	WJ	9/11/2015
TWO PLACE DECIMAL $\pm .030$	CHECKED		9/11/2015
THREE PLACE DECIMAL $\pm .015$	ENG APPR.	WJ	9/11/2015
MATERIAL	THIRD ANGLE:		
FINISH	APPLICATION		
PLATING	NEXT ASSY	USED ON	
	SURFACE FINISH:	63/ OR BETTER	
	UNLESS OTHERWISE SPECIFIED:	ALL DIAMETERS CONCENTRIC WITHIN .005. REMOVE ALL BURRS AND SHARP EDGES	
	TITLE:	VIEWPORT, FUSED SILICA, LASER GRADE, 0.63" VIEW, 133CF	
	DOWNLOADED FROM MPFPI.COM		
	DWG. NO.	A1671-2-CF	REV
	Tuesday, April 19, 2022 8:56:14 AM		