

MPF PRODUCTS INC.

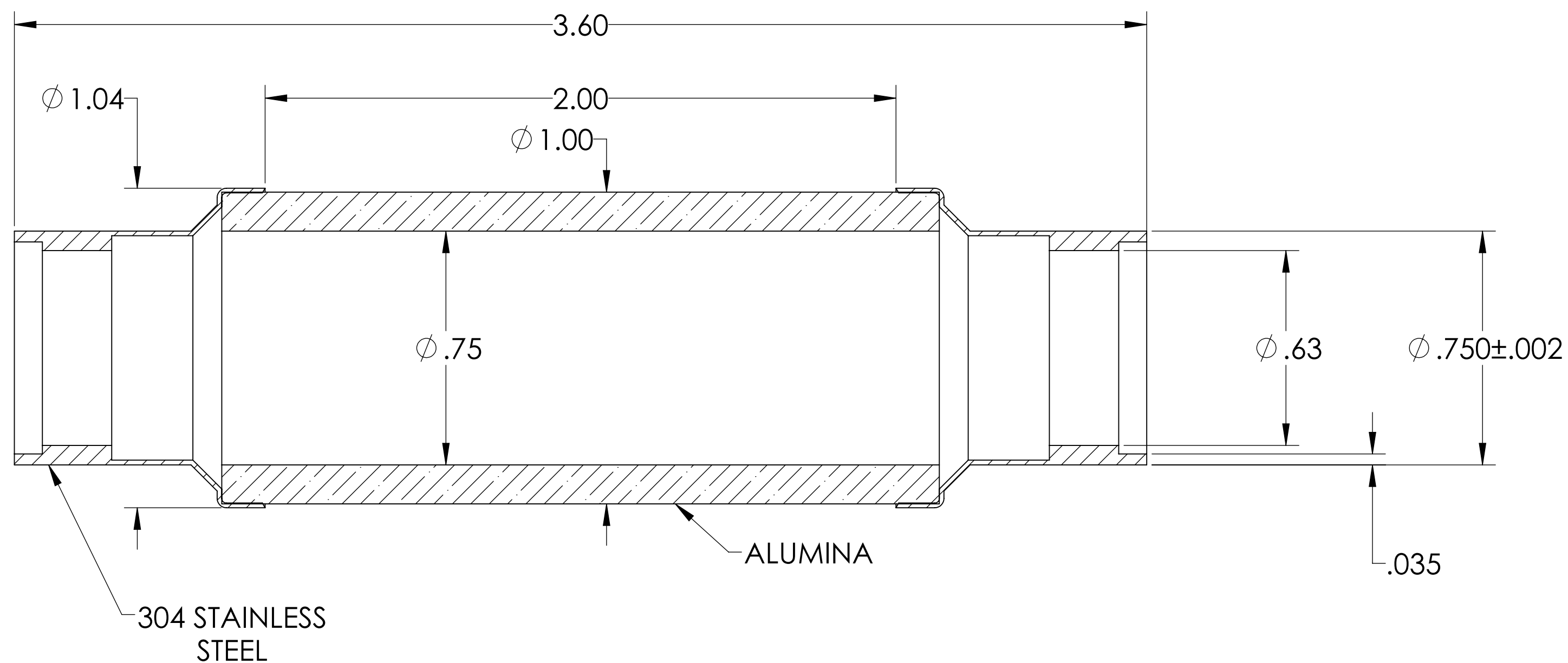
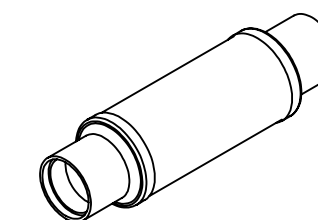

SPECIFICATIONS:

1. VOLTAGE: 30KV
2. TEMPERATURE: -200°C TO 450°C
3. LEAK RATE < 1X10-9 ATM CC/SEC HE

Break, 30KV Isolation, 0.75" Dia Stainless Steel Tube Adapters, High Voltage Isolation, Thermal Isolation, Weldable Tube Ends, UHV Compatible

UNLESS OTHERWISE SPECIFIED:		QUOTATION #		N/A	
DIMENSIONS ARE IN INCHES		NAME	DATE	MPF PRODUCTS INC.	
TOLERANCES:		DRAWN	9/11/2015		
ANGULAR: MACH $\pm 1/2^\circ$		CHECKED	9/11/2015		
TWO PLACE DECIMAL $\pm .030$		ENG APPR.	9/11/2015		
THREE PLACE DECIMAL $\pm .015$		THIRD ANGLE:		TITLE: BREAK, 30KV ISOLATION, 0.75" DIA STAINLESS STEEL TUBE ADAPTERS DOWNLOAD FROM MPFPI.COM	
MATERIAL					
FINISH		APPLICATION NEXT ASSY USED ON			
PLATING		SURFACE FINISH: $\sqrt{63}$ OR BETTER		DWG. NO. REV	
		UNLESS OTHERWISE SPECIFIED:		A1743-1-W	
		ALL DIAMETERS CONCENTRIC WITHIN .005. REMOVE ALL BURRS AND SHARP EDGES		Thursday, January 24, 2019 9:21:08 AM	