

MPF PRODUCTS INC.

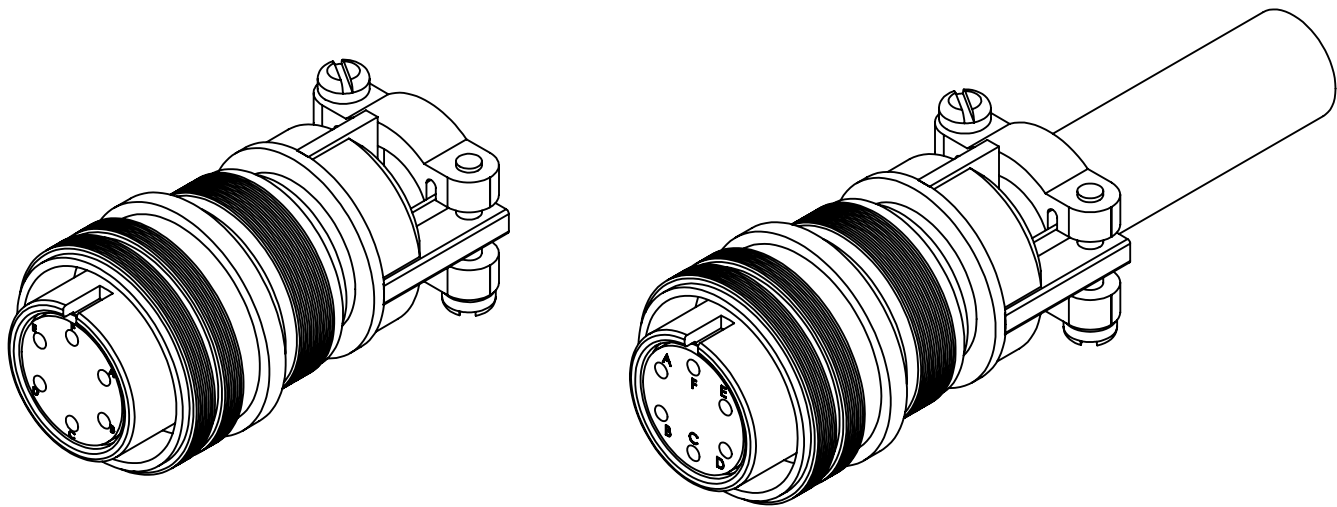
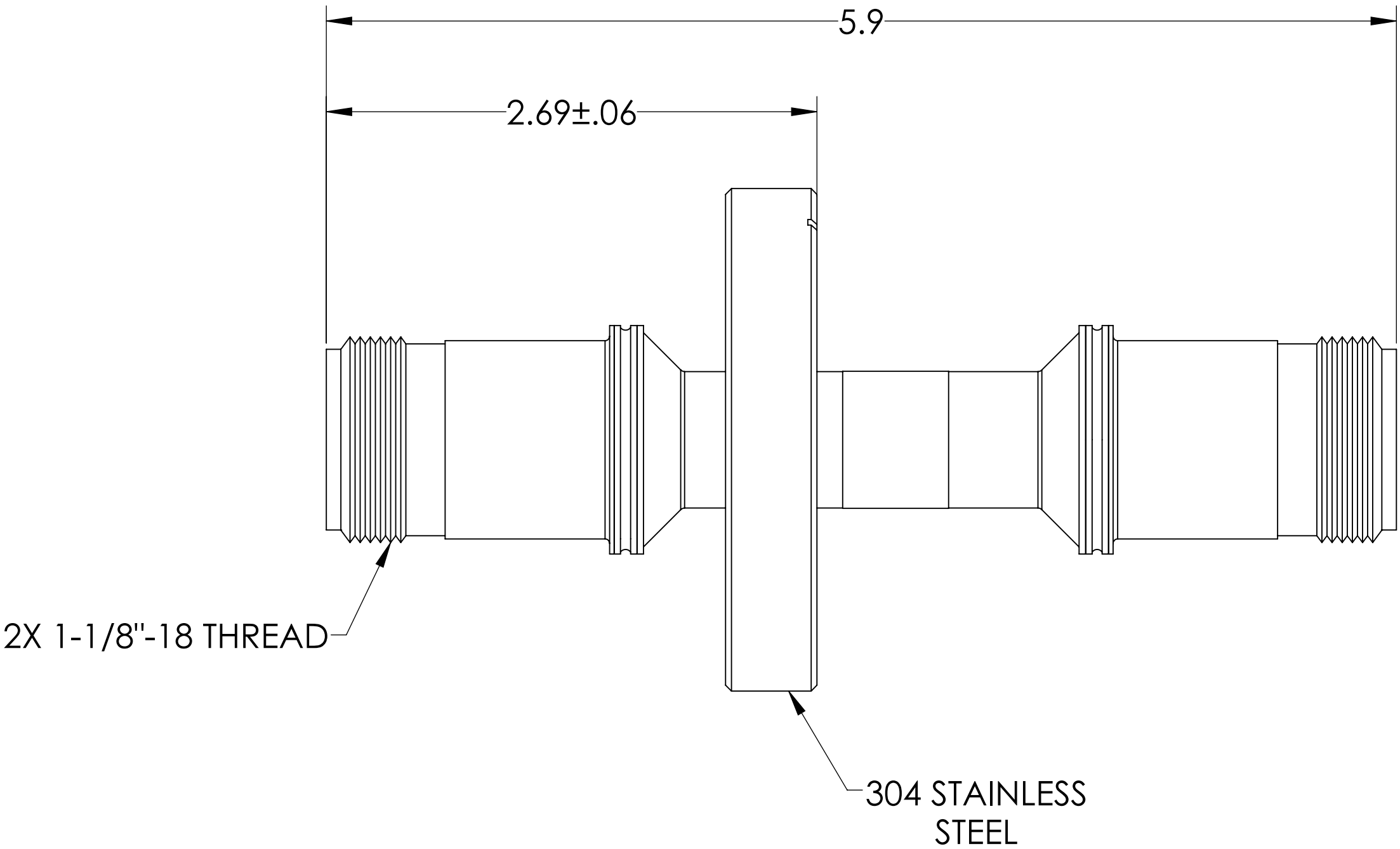
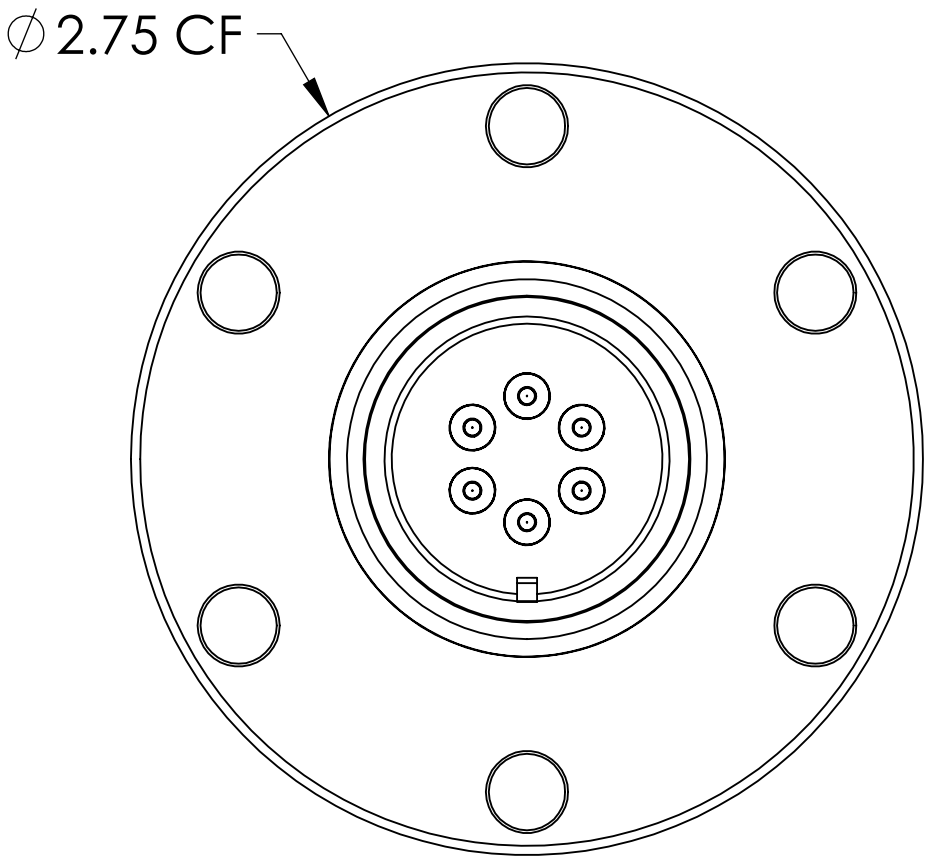
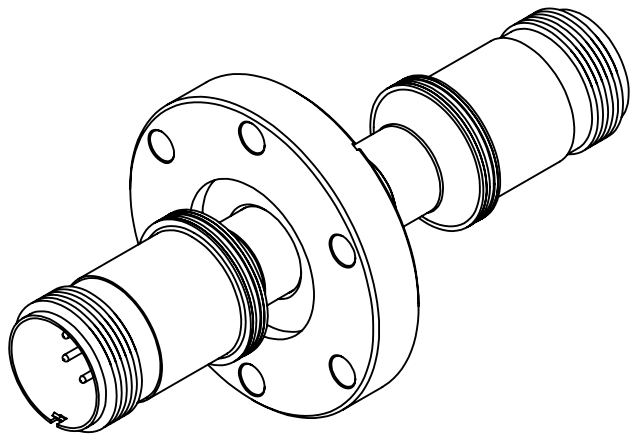

SPECIFICATIONS:

- 1. VOLTAGE: 700 VOLTS DC
- 2. CURRENT: 10 AMPS PER PIN, 36 AMPS FULL LOAD
- 3. TEMPERATURE RATING: -100 TO 450°C WITHOUT CONNECTOR
- 4. LEAK RATE < 1X10-9 ATM CC/SEC HE

MS Series, Multipin Feedthrough, 6 Pins, 700 Volts, 10 Amps per Pin, Double-Ended w/ Air & Vacuum-side Connectors, 2.75" Conflat Flange

|                                       |                               |   |           |
|---------------------------------------|-------------------------------|---|-----------|
| UNLESS OTHERWISE SPECIFIED:           |                               | QUOTATION #                                       |           |
| DIMENSIONS ARE IN INCHES              |                               | N/A   |           |
| TOLERANCES:                           |                               | NAME  | DATE      |
| ANGULAR: MACH ± 1/2°                  |                               | DRAWN WJ  | 9/11/2015 |
| TWO PLACE DECIMAL ± .030              |                               | CHECKED   | 9/11/2015 |
| THREE PLACE DECIMAL ± .015            |                               | ENG APPR. WJ                                      | 9/11/2015 |
| MATERIAL                              | THIRD ANGLE:                  |   |           |
|                                       |                               |   |           |
|                                       | APPLICATION                   |   |           |
| FINISH                                | NEXT ASSY                     |   |           |
|                                       | USED ON                       |   |           |
| PLATING                               | SURFACE FINISH: 63/ OR BETTER |   |           |
|                                       | UNLESS OTHERWISE SPECIFIED:   |   |           |
| ALL DIAMETERS CONCENTRIC WITHIN .005. |                               | REMOVE ALL BURRS AND SHARP EDGES                  |           |
| TITLE:                                |                               | MULTIPIN, 6 PINS, 700V, 10 A, DOUBLE ENDED, 275CF |           |
| DWG. NO.                              |                               | A1834-1-CF  |           |
| REV                                   |                               | Monday, January 28, 2019 9:21:49 AM               |           |